



Unofficial

T201506101

Location #1 Ridge Road  
Striping and Signing Plans

Website  
Copy

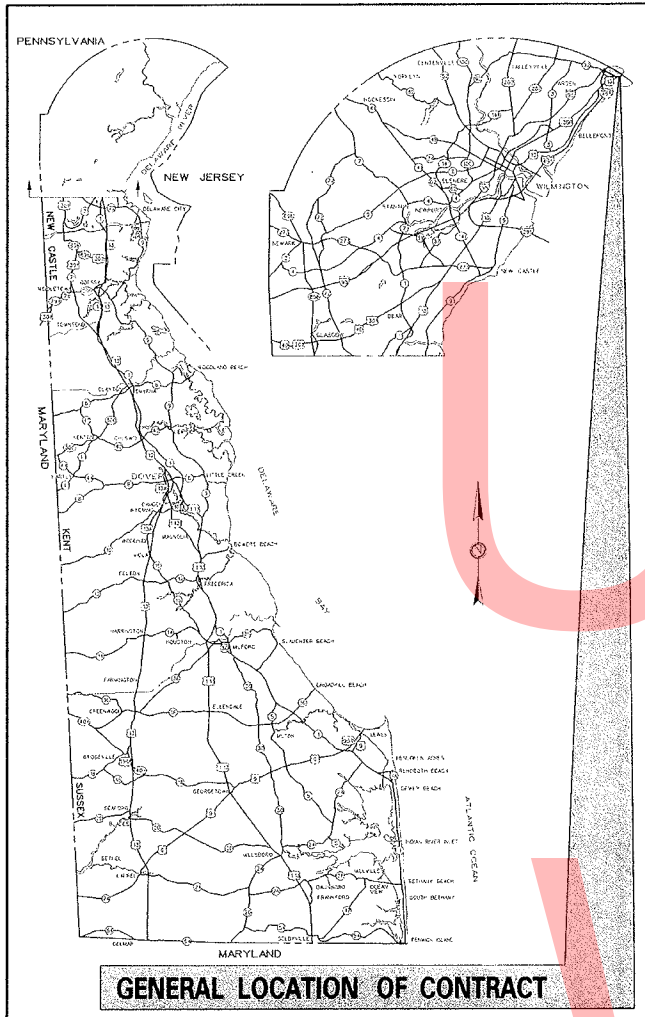

**THE STATE OF DELAWARE  
DEPARTMENT OF TRANSPORTATION**



**PROPOSED SIGNING AND STRIPING PLANS FOR:  
PAVEMENT AND REHABILITATION  
NORTH-1, 2015  
LOCATION 1, RIDGE ROAD**

**CONTRACT NUMBER: T201506101  
FEDERAL AID PROJECT NUMBER: ESTP-2015(15)**

**COUNTY: NEW CASTLE M.R. #: N17A**

**U.S. CUSTOMARY  
UNITS**

**FINAL PLANS**

**LIMIT OF CONSTRUCTION  
CONTRACT T201506101  
ROAD 17  
(SR 92, NAAMANS ROAD)**

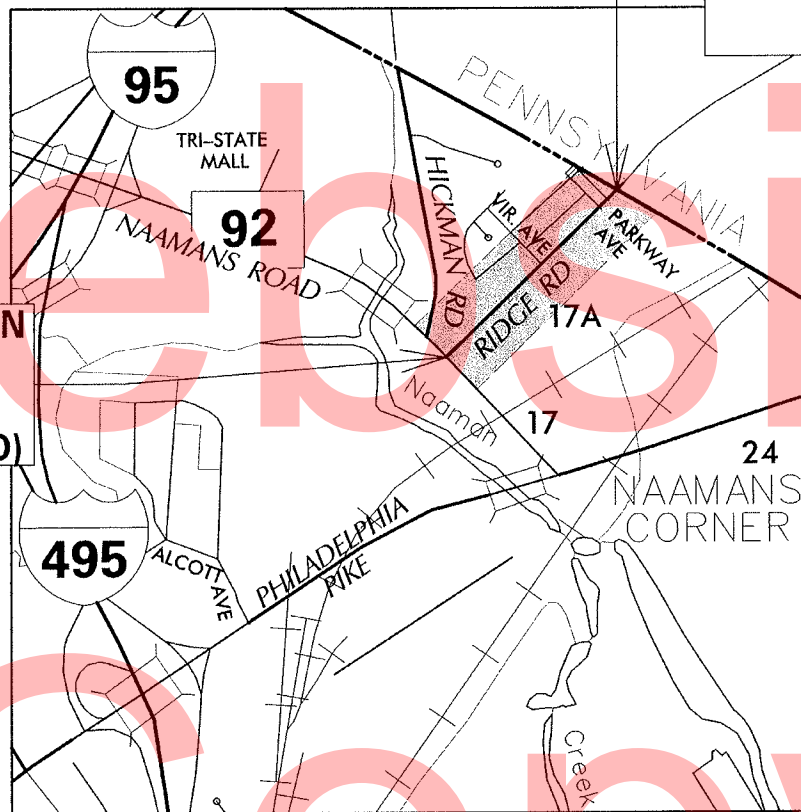

**LIMIT OF CONSTRUCTION  
CONTRACT T201506101  
PENNSYLVANIA  
STATE LINE**

**PROJECT LOCATION 1  
NOT TO SCALE**

**INDEX OF SHEETS**

SHEET NO	TABLE OF CONTENTS
1	TITLE SHEET
2	PLAN SHEET INDEX
3	NOTES AND DETAILS
4	PROPOSED SIGNING AND STRIPING PLAN
5	SIGN SCHEDULE

TOTAL SHEETS: 5

**APPROVED DESIGN EXCEPTIONS**

DESIGN PARAMETER	REQUIRED	PROVIDED	DATE

**ADDENDA & REVISIONS**

DESCRIPTION	NAME & DATE

PREPARED BY  
THE CONSULTING FIRM OF



1352 MARROWS ROAD  
SUITE 100  
NEWARK, DE 19711  
TELEPHONE: (302) 731-9176  
FAX: (302) 731-7807

*Jeffrey F. Lawrence* 04/13/2015  
RECOMMENDED DATE

RECOMMENDED

*[Signature]*  
DATE 4/14/2015

RECOMMENDED

DATE \_\_\_\_\_

RECOMMENDED

DATE \_\_\_\_\_

RECOMMENDED

DATE \_\_\_\_\_

RECOMMENDED

DATE \_\_\_\_\_

APPROVED

*[Signature]*  
DATE 4/14/15

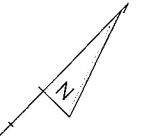

4

**LIMIT OF CONSTRUCTION  
CONTRACT T201506101  
ROAD 17  
(SR 92, NAAMANS ROAD)**

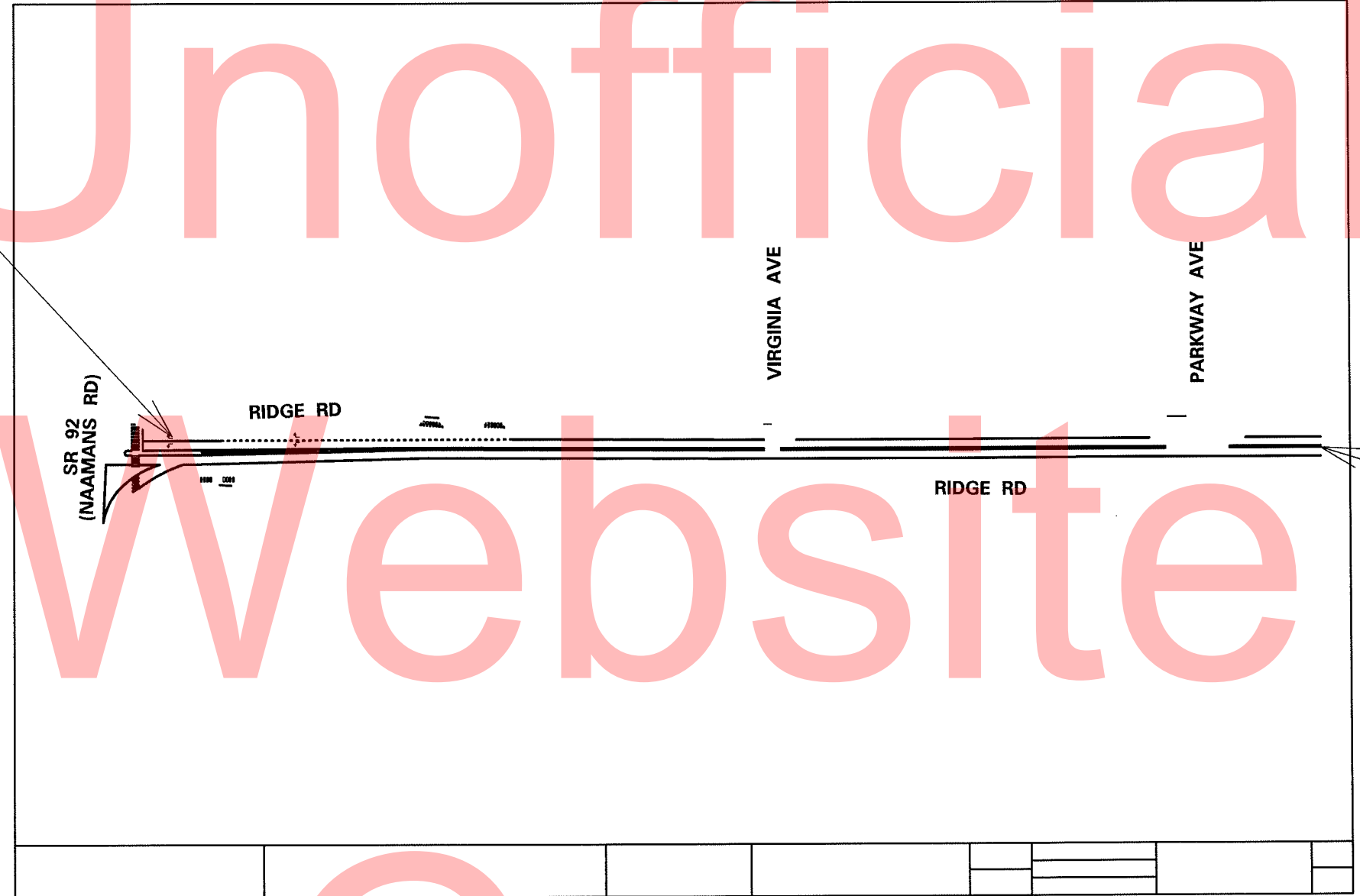

**LIMIT OF CONSTRUCTION  
CONTRACT T201506101  
PENNSYLVANIA  
STATE LINE**

Unofficial  
Website  
Copy

ADDENDUMS / REVISIONS	

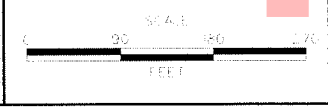

CONTRACT T201506101	SHEET NO. 
COUNTY NEW CASTLE	DESIGNED BY 
	DRAWN BY 

SHEET NO. 2
TOTAL SHEETS 5

GENERAL NOTES FOR SIGNING AND PAVEMENT MARKINGS

1. ROADWAY GEOMETRY IS BASED ON AERIAL PHOTOGRAPHY AND FIELD VERIFICATION.
2. ALL PAVEMENT MARKINGS SHOWN ARE PROPOSED. CONTRACTOR TO FOLLOW PROPOSED SIGNING AND PAVEMENT MARKINGS LEGEND. EXISTING PAVEMENT MARKINGS SHOWN ON AERIAL ARE NOT TO BE REPRODUCED UNLESS CALLED OUT AS SUCH, PER THIS PLAN.
3. REFERENCE CENTER LINE OR MEDIAN EDGE LINE FOR PAVEMENT MARKINGS LAYOUT.
4. THE CONTRACTOR SHALL BE GOVERNED BY THE STANDARDS AND REQUIREMENTS OF THE FOLLOWING PUBLICATIONS, EXCEPT WHEN MODIFIED BY SPECIAL PROVISIONS OF THIS CONTRACT OR THROUGH WRITTEN APPROVAL BY THE ENGINEER.

DELDOT - "MANUAL ON UNIFORM TRAFFIC CONTROL DEVICES",  
2011 EDITION AND SUBSEQUENT REVISIONS (M.U.T.C.D.).

A.A.S.H.T.O. - "STANDARD SPECIFICATIONS FOR STRUCTURAL SUPPORTS FOR HIGHWAY SIGNS, LUMINAIRES, AND TRAFFIC SIGNALS",  
5TH EDITION WITH 2010 AND 2011 INTERIM REVISIONS.

F.H.W.A. - "STANDARD HIGHWAY SIGNS",  
2004 EDITION, SUBSEQUENT REVISIONS AND SUPPLEMENTS.

PAVEMENT MARKING DETAILS

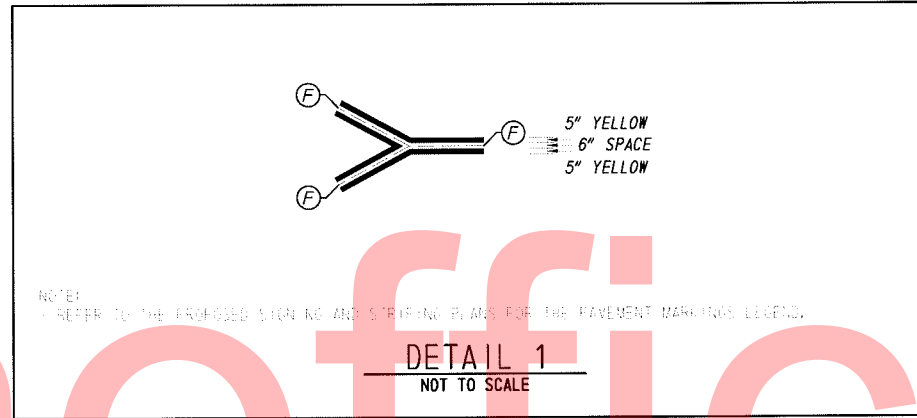

Unofficial  
Website  
Copy

BY: MICHIGAN CONSULTING ENGINEERS

<p><b>DELAWARE</b> DEPARTMENT OF TRANSPORTATION</p>	ADDENDUMS / REVISIONS		NOT TO SCALE	<b>PAVEMENT &amp; REHABILITATION</b> NORTH-1, 2015 LOCATION 1, RIDGE ROAD	CONTRACT	PROJECT NO.	<b>NOTES AND DETAILS</b>	SHEET NO.
					T201506101	DESIGNED BY: AF		3
					COUNTY	CHECKED BY: JF/LLAB		TOTAL SHEETS
		NEW CASTLE			5			



**LIMIT OF CONSTRUCTION  
CONTRACT T201506101  
ROAD 17  
(SR 92, NAAMANS RD)**

**MATCH LINE - THIS SHEET**

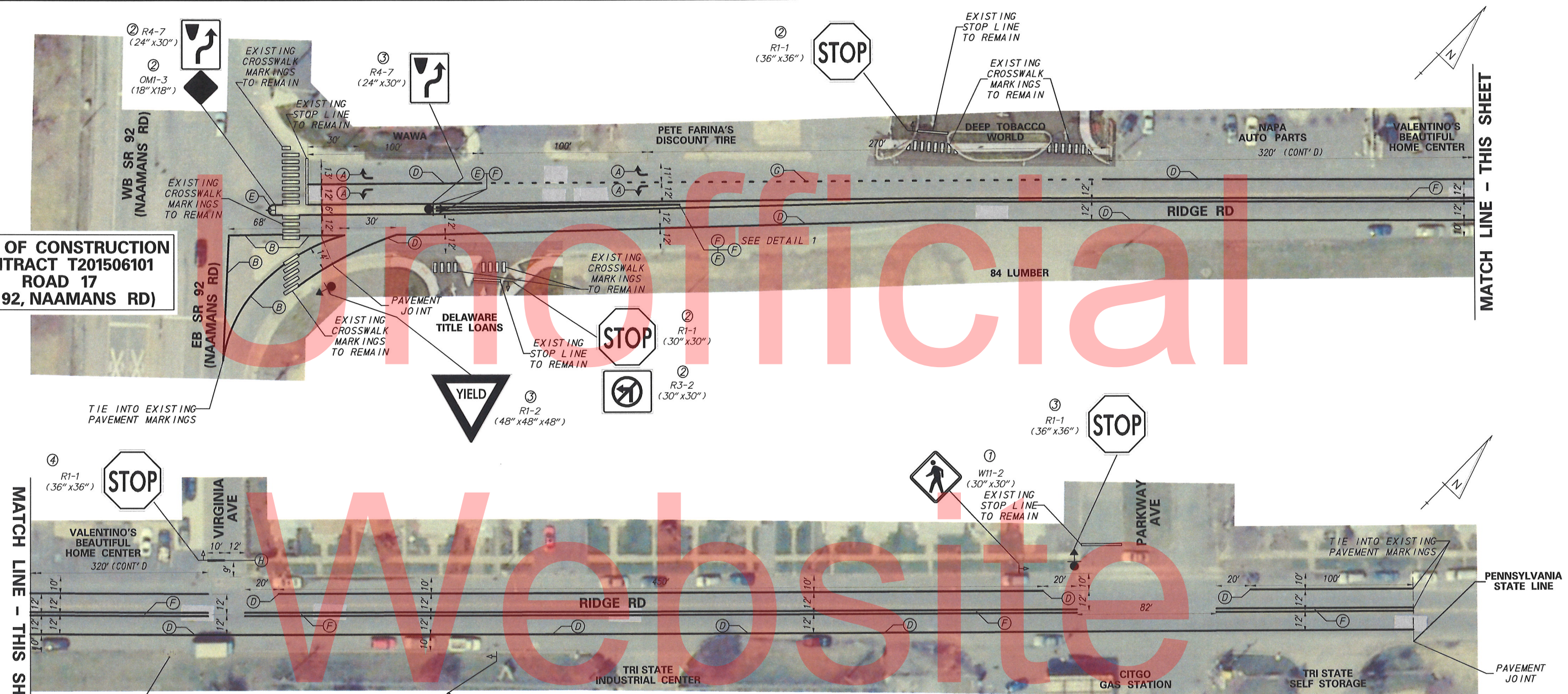

**MATCH LINE - THIS SHEET**

**LIMIT OF CONSTRUCTION  
CONTRACT T201506101  
PENNSYLVANIA  
STATE LINE**

**NOTE**  
REFER TO SHEET 3 FOR THE GENERAL NOTES FOR SIGNING AND PAVEMENT MARKINGS AND PAVEMENT MARKING DETAILS.

- ⑤ W2-2 (30" x 30")
- ① W11-2 (30" x 30")
- ⑤ R3-9cp (12" x 8")
- ⑤ R7-4-DE (12" x 18")

PAVEMENT MARKINGS LEGEND	
SYMBOL	ITEM
(A)	WHITE ALKYD-THERMOPLASTIC PAVEMENT STRIPING SYMBOL (ITEM 748015)
(B)	10" SOLID WHITE EPOXY RESIN PAVEMENT STRIPING (ITEM 748549)
(C)	12" SOLID WHITE ALKYD-THERMOPLASTIC PAVEMENT STRIPING, (ITEM 748027)
(D)	5" SOLID WHITE EPOXY RESIN PAINT PAVEMENT STRIPING, (ITEM 748548)
(E)	5" SOLID YELLOW EPOXY RESIN PAINT PAVEMENT STRIPING, (ITEM 748548)
(F)	5" SOLID YELLOW DOUBLE LINE EPOXY RESIN PAINT PAVEMENT STRIPING, (ITEM 748548)
(G)	5" DOTTED WHITE - 2' LINE & 6' GAP EPOXY RESIN PAINT PAVEMENT STRIPING, (ITEM 748548)
(H)	16" SOLID WHITE ALKYD-THERMOPLASTIC PAVEMENT STRIPING (ITEM 748015)
(J)	24" SOLID WHITE ALKYD-THERMOPLASTIC PAVEMENT STRIPING (ITEM 748015)

SIGNING LEGEND	
①	REMOVE EXISTING SIGN
②	EXISTING SIGN TO REMAIN
③	PLACE NEW SIGN
④	RENEW EXISTING SIGN
⑤	REPOSITION EXISTING SIGN

SIGN LOCATION SYMBOL	
←	EXISTING SIGN LOCATION
→	NEW SIGN LOCATION



