

**THE STATE OF DELAWARE**  
**DEPARTMENT OF TRANSPORTATION**  
Plans and Specifications for Bridge Deck Sealing

Contract No.: T201707702

F.A.P. No. ESTP-2017(22)  
Primavera No. 16-19853

Title: Bridge Deck Sealing, FY18  
Location: Bridges: 1 -130, 1 -147, 1 -157E, 1 -157W, 1 -236, 1 -256, 1 -345, 1 -505, 1 -509, 1 -531, 1 -606, 1 -645, 1 -655,  
1 -696, 1 -760, 1 -809, 3-001, 3-002, 3-242, 3-256  
County: New Castle, Sussex

INDEX OF SHEETS	
Sheet Number	Sheet Name
1	Title Sheet
2	Contract Description
2-3	General Notes
3-8	Project Notes
9-12	Structure Specific Notes
13	Quantity Sheet
14-17	Location Maps
18-22	Detour Plans

**RECOMMENDED:**

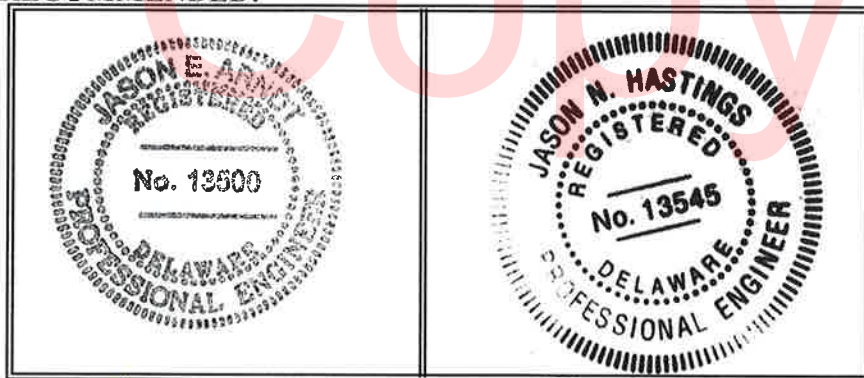

  
\_\_\_\_\_  
Bridge Management Engineer  
Date: 10/24/17

  
\_\_\_\_\_  
Assistant Director, Bridge  
Date: 10/24/17

**CONTRACT DESCRIPTION**

1. The purpose of this contract is to apply a deep penetrating clear water repellent sealant to the concrete bridge deck, approach slabs, approach slab headers, tops of abutment backwalls, sidewalks, curbs, medians and inside vertical surface and top surface of the parapets of Bridges 1 -130, 1 -147, 1 -157E, 1 -157W, 1 -236, 1 -256, 1 -345, 1 -505, 1 -509, 1 -531, 1 -606, 1 -645, 1 -655, 1 -696, 1 -760, 1 -809, 3-001, 3-002, 3-242, 3-256. Work shall include crack sealing decks, joint seal repair, concrete repairs, and pavement striping

**GENERAL NOTES**

1. This project is to be constructed in accordance with Delaware Department of Transportation “Standard Specifications for Road and Bridge Construction”, dated August 2016 and the Delaware Department of Transportation “Standard Construction Details”, dated 2014, including all revisions up to the date of advertisement.
2. Whenever the word “Contractor” is used in this contract, it shall refer to the person or persons, company or corporation furnishing the services required.
3. Whenever the word "Department" or "Engineer" is used, it shall refer to the person or persons, representing the Delaware Department of Transportation (DelDOT).
4. The contractor shall give two (2) weeks notice to the property owner when any fixture, shrub, or other object must be removed from the right of way or easement area. If the owner has not attempted to salvage this property, the contractor shall remove it without obligation. Compensation shall be incidental to the contract.
5. It is anticipated that all work will occur within DelDOT’s existing right of way or easement areas. Should the need occur to trespass onto private property; it will be the responsibility of the DelDOT Project Manager to secure such trespass needs.
6. Site reviewer. An erosion control site reviewer shall be a person from the contractor’s staff assigned to Erosion and Sediment Control Implementation and Maintenance and shall be required on specific projects. The name and DNREC certification number of each site reviewer so required shall be submitted to the Department prior to the execution of the contract. The name of the Delaware registered professional engineer providing direction and supervision of the site reviewer, as required in Section 12.3 of the Delaware Sediment and Stormwater Regulations, shall also be submitted to the Department prior to execution of the contract. The site reviewer requirements in effect on this project shall be as marked with an (x) below:

Erosion potential for this project	Site reviewer requirement
( X ) Insignificant	None
( ) Minor	Contractor certification course training only. See 1 below.
( ) Medium	Superintendent or a separate individual from the contractor’s staff shall be a certified construction reviewer (CCR). See 2 below.
( ) Major	Superintendent and an individual from the contractor’s staff shall be CCR. See 3 below.

1. As defined in section 13 of the Delaware Sediment and Stormwater Regulations.
2. As defined in section 12 of the Delaware Sediment and Stormwater Regulations.
3. One individual from the contractor’s staff must be a CCR prior to the execution of the contract. The superintendent must become a CCR within one year after the award of contract.

7. The disturbed area for the project is 0.00 Acres.

8. The additional impervious area for this project is 0.00 Sq. Ft.
9. The contractor shall be responsible for adhering to the construction site pollution prevention Specifications as detailed in Section 3.6 of the "Delaware Erosion and Sediment Control Handbook". All costs associated with adhering to the standards shall be incidental to the overall contract.
10. Electronic project files that will be made available to the contractor include: None.

### PROJECT NOTES

1. The sealant used for the deck, approach slabs, top of abutment backwall, sidewalks, curbs, medians and parapets shall be applied at a rate recommended by the Manufacturer. It will be applied uniformly and completely cover the surfaces as specified in item 613002 – Silane-Based Concrete Deck Sealer. **Remove all excess sealant not needed for redistribution. All grooves or indentations need to also have excess sealant removed.** See Structure Specific Notes for limits of sealing.
2. Trash, rubbish, debris, vegetation, or brush, which hampers contract operations (determined by the Engineer), shall be removed within the project limits and shall be incidental to Item no. 613002 – Silane-Based Concrete Deck Sealer.
3. During the cleaning operation, the Contractor shall report to the Engineer any defects in the deck. These defects include, but are not limited to, loss of section, cracking, spalling, potholes, and bridge joint defects.
4. During the cleaning operation, the Contractor shall protect/shield all striping and pavement markings, which will remain in place. Contractor shall apply Sealant directly on existing striping and pavement markings. This does not include bridges 1-696 and 1-760; see Structure Specific Notes.
5. During cleaning operation and sealing application, the Contractor shall protect all drainage inlets to prevent material from entering and passing through, specifically drains that discharge into waterways. Contractor shall also cover any bridge mounted signs or plaques during sealing application.
6. Prior to sealant application, the Contractor shall repair cracks in bridge decks, approach slabs, approach slab headers, top of abutment back walls, sidewalks, curb faces and medians. Engineer must approve of the selected cracks prior to beginning sealing activity. Payment for sealing cracks will be under Item No. 628011 – Crack Sealing Bridge Decks, Approach Slabs, Sidewalks, Etc.
7. Prior to sealant application, the Contractor shall seal the perimeter cracks /cold joints of new and old patch repairs in bridge decks, approach slabs, approach slab headers, top of abutment back walls, sidewalks, curb faces and medians. Engineer must approve of the selected cracks prior to beginning sealing activity. Payment for sealing cracks will be under Item No. 628011 – Crack Sealing Bridge Decks, Approach Slabs, Sidewalks, Etc.
8. Prior to sealant application, the Contractor shall repair all spalls in the deck riding surface and approach slabs where the depth measures 1 inch to 3 inches. Engineer must approve of the selected spalls prior to beginning repair activity. Payment for spall repairs where the depth measures 1 inch to 3 inches will be under Item No. 628051 – Deck Repair, 1" to 3" Depth.
9. Prior to sealant application, the Contractor shall repair all spalls in the deck riding surface and approach slabs where the depth measures 3 inches to less than full depth. Engineer must approve of the selected spalls prior to beginning repair activity. Payment for spall repairs where the depth measures 3 inches to less than full depth will be under Item No. 628052 – Deck Repair, 3" to < Full Depth.
10. Prior to sealant application, the Contractor shall repair all spalls in the concrete parapets, sidewalks, curbs, medians, and abutment backwalls. Engineer must approve of the selected spalls prior to beginning repair activity. Payment for spall repairs in the concrete parapet, sidewalks, curbs, medians, and abutment backwalls will be under Items No. 610008 – Portland Cement Concrete Masonry, Parapet, Class A and 610505 – Partial Removal of P.C.C. Masonry.
11. Prior to sealant application, the Contractor shall replace the Silicone Joint Seal above both abutments and along approach parapets, if present. Engineer must approve of the selected joints prior to beginning repair activity. Payment for replacing the silicone joint seal will be under Item No. 624010 – Silicone Joint Seal, 1", Item No. 624011 – Silicone Joint Seal, 2" or Item No. 624012 – Silicone Joint Seal, 3".

12. Prior to sealant application, the Contractor shall install a Silicone Coated Foam Joint Seal at bridge expansion joints. Engineer must approve of the selected joints prior to beginning repair activity. Payment for installing the close cell joint seal will be under Item No. 624502– Silicone Coated Foam Joint Seal. See Structure Specific Notes for installation locations.
13. All work shall be performed in a manner that will reasonably provide the least practicable obstruction to all road users, including vehicular, pedestrian, and bicycle traffic, and shall conform to the requirements of the most recent, at time of bid including all revisions, Delaware Manual on Uniform Traffic Control Devices, Part 6, herein referred to as the Traffic Control Manual.
14. Only lane and/or shoulder closures at each bridge location shall be permitted as outlined in table below using Typical Applications of the DE-MUTCD or as directed by the Engineer.
15. Full road closures are permitted for bridges 1-130, 3-001, and 3-256 using approved Detour Plans. The Contractor shall strictly adhere to these Detour Plans provided by DelDOT’s Traffic Safety Section; see Detour Plans below.

Bridge #	Facility Carried	Feature Intersected	Typical Application / Detour Plan
1-130	Mt CUBA RD	RED CLAY CREEK	DETOUR PLAN
1-147	FAULKLAND RD / SR 34	RED CLAY CREEK	TA-10
1-157E	MITCH RD / SR 4	RED CLAY CREEK	TA-33
1-157W	WEST NEWPORT PIKE / SR 4	RED CLAY CREEK	TA-33
1-236	RED MILL RD	WHITE CLAY CREEK	DETOUR PLAN
1-256	CHURCHMANS RD	CHRISTINA CREEK	TA-10
1-345	WELSH TRACT RD	CHRISTINA CREEK	TA-10
1-505	HIGHLAND AVE	SR 141	TA-27
1-509	BURNSIDE BLVD	SR 141, BASIN RD	TA-27
1-531	SR 141	CSX RAILROAD	TA-33 / TA-44
1-606	BASIN RD / SR 141	RD 333, CENTERVILLE RD	TA-33 / TA-44
1-645	MARROWS RD	AMTRAK	TA-10
1-655	LIMESTONE RD / SR 7	CSX RAILROAD	TA-33
1-696	APPLE RD	CSX RAILROAD	TA-10
1-760	EIGHTEENTH STREET	I-95	TA-10
1-809	ROGERS RD	I-495	TA-33
3-001	REHOBOTH BLVD	SR 1, MILFORD BYPASS	DETOUR PLAN
3-002	CEDAR BEACH RD	SR1, MILFORD BYPASS	DETOUR PLAN
3-242	MIDDLEFORD RD	TRIB. OF NANTICOKE RIVER	TA-10
3-256	POPLAR ST / RD 535B	WILLIAMS POND	DETOUR PLAN



**ALLOWABLE LANE CLOSURES TIMES - BR 1-256, 1-505, 1-509**

	12:00 AM	1:00 AM	2:00 AM	3:00 AM	4:00 AM	5:00 AM	6:00 AM	7:00 AM	8:00 AM	9:00 AM	10:00 AM	11:00 AM	12:00 PM	1:00 PM	2:00 PM	3:00 PM	4:00 PM	5:00 PM	6:00 PM	7:00 PM	8:00 PM	9:00 PM	10:00 PM	11:00 PM
SUNDAY																								
MONDAY																								
TUESDAY																								
WEDNESDAY																								
THURSDAY																								
FRIDAY																								
SATURDAY																								

ONE THROUGH LANE AND/OR TURN LANE PERMITTED TO BE CLOSED  
 NO TRAVEL OR TURN LANE CLOSURES PERMITTED

**ALLOWABLE LANE CLOSURES TIMES - BR 1-645**

	12:00 AM	1:00 AM	2:00 AM	3:00 AM	4:00 AM	5:00 AM	6:00 AM	7:00 AM	8:00 AM	9:00 AM	10:00 AM	11:00 AM	12:00 PM	1:00 PM	2:00 PM	3:00 PM	4:00 PM	5:00 PM	6:00 PM	7:00 PM	8:00 PM	9:00 PM	10:00 PM	11:00 PM
SUNDAY																								
MONDAY																								
TUESDAY																								
WEDNESDAY																								
THURSDAY																								
FRIDAY																								
SATURDAY																								

ONE THROUGH LANE AND/OR TURN LANE PERMITTED TO BE CLOSED  
 NO TRAVEL OR TURN LANE CLOSURES PERMITTED

**ALLOWABLE LANE CLOSURES TIMES - BR 3-242**

	12:00 AM	1:00 AM	2:00 AM	3:00 AM	4:00 AM	5:00 AM	6:00 AM	7:00 AM	8:00 AM	9:00 AM	10:00 AM	11:00 AM	12:00 PM	1:00 PM	2:00 PM	3:00 PM	4:00 PM	5:00 PM	6:00 PM	7:00 PM	8:00 PM	9:00 PM	10:00 PM	11:00 PM
SUNDAY																								
MONDAY																								
TUESDAY																								
WEDNESDAY																								
THURSDAY																								
FRIDAY																								
SATURDAY																								

ONE THROUGH LANE AND/OR TURN LANE PERMITTED TO BE CLOSED  
 NO TRAVEL OR TURN LANE CLOSURES PERMITTED

- 17. No lane closures will be permitted on holidays, holiday weekends or during special events as outlined in Section 108 of the Standard Specifications for Road and Bridge Construction and/or the Transportation Management Plan, unless approved by the Engineer with consultation with the Safety Section.
- 18. The Department reserves the right to stop the Contractor's operations, if in the opinion of the Engineer the Contractor's operations are not in compliance with the Delaware MUTCD, the specifications, or the Contract Documents. The Department also reserves the right to stop the Contractor's operations if the Engineer deems the operation unsafe.
- 19. American Traffic Safety Association (ATSSA) Certified Traffic Control Supervisor Requirement for the project:

( )	THE CONTRACTOR SHALL NOT BE REQUIRED TO HAVE AN ATSSA SUPERVISOR ASSIGNED TO THIS PROJECT.
( X )	THE CONTRACTOR SHALL HAVE AN ATSSA SUPERVISOR ASSIGNED TO THIS PROJECT. THE CONTRACTOR'S GENERAL SUPERINTENDENT FOR THIS PROJECT OR ANOTHER ATSSA CERTIFIED MEMBER OF THE CONTRACTOR'S PROJECT STAFF MAY BE THE ATSSA SUPERVISOR. PAYMENT FOR ATSSA SUPERVISOR IS INCIDENTAL TO ITEM 801000 MAINTENANCE OF TRAFFIC.
( )	THE CONTRACTOR SHALL HAVE AN ATSSA SUPERVISOR ASSIGNED TO THIS PROJECT. THE ATSSA SUPERVISOR'S SOLE JOB SHALL BE SUPERVISION OF THE INSTALLATION, OPERATION AND MAINTENANCE OF TRAFFIC CONTROL DEVICES FOR THIS PROJECT. THE CONTRACTOR'S GENERAL SUPERINTENDENT FOR THIS PROJECT SHALL NOT BE THE ATSSA SUPERVISOR.

- 20. All traffic control devices shall be in new or refurbished condition, shall be in compliance with the Traffic Control Manual and with the NCHRP Report 350 and/or MASH as defined in Section 'A' of the Traffic Control Manual, and shall be approved by the Engineer before installation. Traffic control devices shall be maintained in good condition for duration of use.
- 21. All equipment shall be removed from the job sites on a daily basis, except when allowed by the Engineer.
- 22. All work shall be performed within the existing right-of-way unless otherwise noted. Right-of-way information and existing plans shall be available upon request at the DelDOT Administration Office.
- 23. No equipment is allowed in any waterway or wetland.
- 24. There are no environmental permits (including but not limited to COE, DNREC Subaqueous Lands and Wetlands, Coast Guard, New Castle, Kent, and Sussex County Floodplain), or environmental construction restrictions. As such, no Environmental Compliance sheet was prepared.
- 25. The Contractor may store the equipment needed for this project at a pre-approved area or in the nearest State of Delaware maintenance yard. The Contractor must remove equipment from the jobsite if and when the district deems it necessary. The contractor is to stay within the confines of the state right-of-way. Right-of-way information and existing plans shall be available upon request at the DelDOT Administration Office. Areas within the state right-of-way limits in which the soil and vegetation have been damaged from equipment during this contract, shall be repaired with topsoil, seed and mulch in accordance with the standard specifications at the Contractor's own expense.
- 26. Two Portable Changeable Message Signs shall be placed at each bridge location, for each roadway affected, five days prior to the start of construction until two days after the start of construction to notify drivers of the lane/shoulder closure and impending construction activity. The message shall include the dates and times of the lane closures and how long the closures will be necessary, message shall be approved by the Safety Officer. For locations that have parallel structures, a total of two variable message boards shall be used for both bridges. Payment under Item No. 803001- Furnish and Maintain Portable Changeable Message Sign.
- 27. Unless otherwise noted on the plans, the Contractor shall, as part of his Project Schedule, submit to the Engineer an estimate of the monthly payments expected to be received on the contract. This will be referenced as the "Monthly Payment Chart".

A chart in Microsoft Excel, Microsoft Word, or hand written format will be acceptable for this purpose. The chart should include, as a minimum, columns for the month, year, and estimated monthly payments. The total of all estimated monthly payments should equal the awarded contract total bid price.

The Engineer may request an updated "Monthly Payment Chart" at his discretion, depending on the accuracy of the initial estimates and according to the overall needs of the Department.

The “Monthly Payment Chart” will not be considered a binding document by either the Contractor or the Department and is considered solely informational.

On projects requiring CPM Schedules, the Contractor may, but is not required to, “Cost Load” the CPM Schedule in order to generate the monthly payment estimates.

Costs to prepare and/or update the “Monthly Payment Chart” are addressed as follows:

- a. On Contracts requiring CPM Schedules and Updates, preparation of the initial chart shall be incidental to Item 763508. Updates shall be incidental to Item 763509.
- b. On contracts not requiring CPM Schedules, the cost to prepare and update the “Monthly Payment Chart” shall be included in Item 763000– Initial Expense/De-Mobilization.

Unofficial  
Website  
Copy



**STRUCTURE SPECIFIC NOTES****1-130**

1. Bridge 1-130 carries Mt Cuba Rd over Red Clay Creek.
2. Bridge deck, top of abutment back walls, sidewalks, and curb faces shall be prepared and sealed with Item 613002 – Silane-Based Concrete Deck Sealer.

**1-147**

1. Bridge 1-147 carries Faulkland Rd / SR 34 over Red Clay Creek.
2. Bridge deck, top of abutment back walls, sidewalks, and curb faces shall be prepared and sealed with Item 613002 – Silane-Based Concrete Deck Sealer.

**1-157E**

1. Bridge 1-157E carries Mitch Rd / SR4 over Red Clay Creek.
2. Bridge deck, approach slabs, sidewalks, curb faces and inside and top faces of parapets shall be prepared and sealed with Item 613002 – Silane-Based Concrete Deck Sealer.

**1-157W**

1. Bridge 1-157W carries West Newport Pike / SR4 over Red Clay Creek.
2. Bridge deck, approach slabs, sidewalks, curb faces and inside and top faces of parapets shall be prepared and sealed with Item 613002 – Silane-Based Concrete Deck Sealer.

**1-236**

1. Bridge 1-236 carries Red Mill Rd over White Clay Creek.
2. Bridge deck, approach slab, top of abutment backwalls, and sidewalk shall be prepared and sealed with Item 613002 – Silane-Based Concrete Deck Sealer.

**1-256**

1. Bridge 1-256 carries Churchmans Rd over Christina Creek.
2. Bridge deck, approach slabs, and top of abutment backwalls shall be prepared and sealed with Item 613002 – Silane-Based Concrete Deck Sealer.

**1-345**

1. Bridge 1-345 carries Welsh Tract Rd over Christina Creek.
2. Bridge deck shall be prepared and sealed with Item 613002 – Silane-Based Concrete Deck Sealer.

**1-505**

1. Bridge 1-505 carries Highland Ave over SR 141.
2. Bridge deck, approach slabs, top of abutment back walls, inside face of parapets, sidewalks, curb faces and median shall be prepared and sealed with Item 613002 – Silane-Based Concrete Deck Sealer.
3. Voids around metal fence posts in top of parapets shall be filled with Silicone Joint sealer with Item No. 624012 – Silicone Joint Seal, 3”.
4. Transverse joints in sidewalks and curbs shall be filled with Silicone Joint Sealer with Item 624010– Silicone Joint Seal, 1”.
5. Repair spalls on median with Items No. 610008 – Portland Cement Concrete Masonry, Parapet, Class A and 610505 – Partial Removal of P.C.C. Masonry (See attached Special Provision).

**1-509**

1. Bridge 1-509 carries Burnside Blvd over SR 141 / Basin Rd.
2. Bridge deck, approach slabs, top of abutment back walls, sidewalks and curb faces shall be prepared and sealed with Item 613002 – Silane-Based Concrete Deck Sealer.
3. Voids around metal fence posts in top of parapets shall be filled with Silicone Joint sealer with Item No. 624012 – Silicone Joint Seal, 3”.
4. Transverse joints in sidewalks and curbs shall be filled with Silicone Joint Sealer with Item 624010– Silicone Joint Seal, 1”.
5. Repair spalls on inside face of painted parapets with Items No. 610008 – Portland Cement Concrete Masonry, Parapet, Class A and 610505 – Partial Removal of P.C.C. Masonry (See attached Special Provision).

**1-531**

1. Bridge 1-531 carries SR 141 over CSX Railroad.
2. Bridge deck, approach slabs, top of abutment back walls, and inside and top faces of parapets (where exposed) shall be prepared and sealed with Item 613002 – Silane-Based Concrete Deck Sealer.

**1-606**

1. Bridge 1-606 carries Basin Rd / SR 141 over Rd 333, Centerville Rd.
2. Bridge deck, approach slabs, top of abutment back walls, and inside and top faces of parapets shall be prepared and sealed with Item 613002 – Silane-Based Concrete Deck Sealer.

**1-645**

1. Bridge 1-645 carries Marrows Rd over Amtrak.
2. Bridge deck, approach slabs, top of abutment backwalls, and sidewalk shall be prepared and sealed with Item 613002 – Silane-Based Concrete Deck Sealer.

**1-655**

1. Bridge 1-655 carries Limestone Rd / SR 7 over CSX Railroad.
2. Bridge deck, top of abutment backwalls, sidewalks, curb faces and median shall be prepared and sealed with Item 613002 – Silane-Based Concrete Deck Sealer.
3. Install new Silicone Coated Foam Joint Seal, between expansion joint armoring above both abutments with Item 624502– Silicone Coated Foam Joint Seal.

**1-696**

1. Bridge 1-696 carries Apple Rd over CSX Railroad.
2. Bridge deck, approach slab header, top of abutment backwalls, sidewalks and curb faces shall be prepared and sealed with Item 613002 – Silane-Based Concrete Deck Sealer.
3. Following all spall repairs, crack sealing, and deck sealing applications, contractor shall replace double yellow centerline and both white edge lines pavement markings at existing location. Payment for pavement markings will be under Item No. 817013 – Permanent Pavement Striping, Epoxy Resin Paint, White/Yellow, 5”.

**1-760**

1. Bridge 1-760 carries Eighteenth St. over I-95.
2. Bridge deck, approach slab headers, sidewalks, and curb faces shall be prepared and sealed with Item 613002 – Silane-Based Concrete Deck Sealer.
3. Following all spall repairs, crack sealing, and deck sealing applications, contractor shall replace double yellow centerline pavement markings at existing location. Payment for pavement markings will be under Item No. 817013 – Permanent Pavement Striping, Epoxy Resin Paint, White/Yellow, 5”.

**1-809**

1. Bridge 1-809 carries Rogers Rd over I-495.
2. Bridge deck, approach slab header, top of abutment back walls, sidewalks, curb faces and median shall be prepared and sealed with Item 613002 – Silane-Based Concrete Deck Sealer.

**3-001**

1. Bridge 3-001 carries Rehoboth Blvd over SR1, Milford Bypass.
2. Bridge deck, approach slab header, and top of abutment back walls shall be prepared and sealed with Item 613002 – Silane-Based Concrete Deck Sealer.
3. Repair spalls on inside face of painted parapets with Items No. 610008 – Portland Cement Concrete Masonry, Parapet, Class A and 610505 – Partial Removal of P.C.C. Masonry (See attached Special Provision).
4. Install new Silicone Coated Foam Joint Seal, between expansion joint armoring above both abutments with Item 624502– Silicone Coated Foam Joint Seal.

**3-002**

1. Bridge 3-002 carries Cedar Beach Rd over SR1, Milford Bypass.
2. Bridge deck, approach slab header, and top of abutment back walls shall be prepared and sealed with Item 613002 – Silane-Based Concrete Deck Sealer.
3. Repair spalls on inside face of painted parapets with Items No. 610008 – Portland Cement Concrete Masonry, Parapet, Class A and 610505 – Partial Removal of P.C.C. Masonry (See attached Special Provision).
4. Install new Silicone Coated Foam Joint Seal, between expansion joint armoring above both abutments with Item 624502– Silicone Coated Foam Joint Seal.

**3-242**

1. Bridge 3-242 carries Middleford Rd over Trib. to Nanticoke River.
2. Bridge deck, approach slab header, top of abutment back walls, sidewalks, and curb faces shall be prepared and sealed with Item 613002 – Silane-Based Concrete Deck Sealer.

**3-256**

1. Bridge 3-256 carries Poplar St / RD 535B over Williams Pond.
2. Bridge deck, and curb faces shall be prepared and sealed with Item 613002 – Silane-Based Concrete Deck Sealer.

**QUANTITY SHEET**

<b>Item No.</b>	<b>DESCRIPTION</b>	<b>UNIT</b>	<b>TOTAL</b>
610008	PORTLAND CEMENT CONCRETE MASONRY, PARAPET, CLASS A	C.Y.	15
610505	PARTIAL REMOVAL OF P.C.C. MASONRY	C.Y.	15
613002	SILANE-BASED CONCRETE DECK SEALER	S.F.	320000
624502	SILICONE COATED FOAM JOINT SEAL	L.F.	600
624010	SILICONE JOINT SEAL, 1"	L.F.	600
624011	SILICONE JOINT SEAL, 2"	L.F.	3000
624012	SILICONE JOINT SEAL, 3"	L.F.	300
628011	CRACK SEALING BRIDGE DECKS, APPROACH SLABS, SIDEWALKS, ETC	L.F.	25000
628051	DECK REPAIR, 1" TO 3" DEPTH	S.F.	600
628052	DECK REPAIR, 3" TO < FULL DEPTH	S.F.	1600
763000	INITIAL EXPENSE/DE-MOBILIZATION	LS	1
801000	MAINTENANCE OF TRAFFIC	L.S.	1
802003	ARROW PANELS, TYPE C	EA-DY	180
803001	FURNISH AND MAINTAIN PORTABLE CHANGEABLE MESSAGE SIGN	EA-DY	350
804001	FURNISH AND MAINTAIN PORTABLE LIGHT ASSEMBLY (FLOOD LIGHTS)	EA-DY	200
805001	PLASTIC DRUMS	EA-DY	7000
806001	TRAFFIC OFFICERS	HOUR	200
808002	FURNISH AND MAINTAIN TRUCK MOUNTED ATTENUATOR, TYPE II	EA-DY	200
810001	TEMPORARY WARNING SIGNS AND PLAQUES	EA-DY	1200
811001	FLAGGER, NEW CASTLE COUNTY STATE	HOUR	1300
811003	FLAGGER, SUSSEX COUNTY STATE	HOUR	400
811013	FLAGGER, NEW CASTLE COUNTY, STATE, OVERTIME	HOUR	350
811015	FLAGGER, SUSSEX COUNTY, STATE, OVERTIME	HOUR	100
813001	TEMPORARY BARRICADES, TYPE III	LF/DY	500
817013	PERMANENT PAVEMENT STRIPING, EPOXY RESIN PAINT, WHITE/YELLOW, 5"	LF	1200

### Location Maps

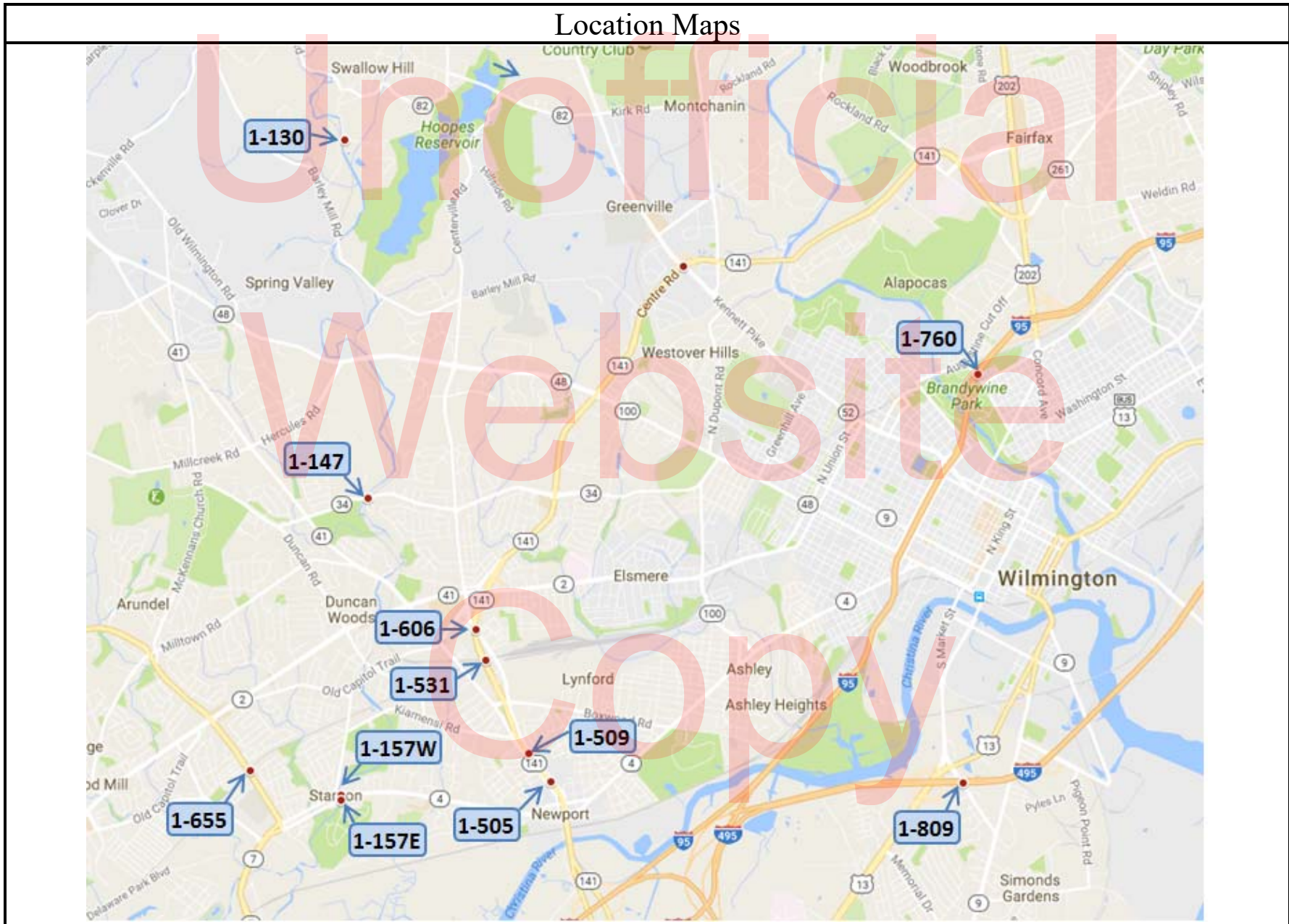

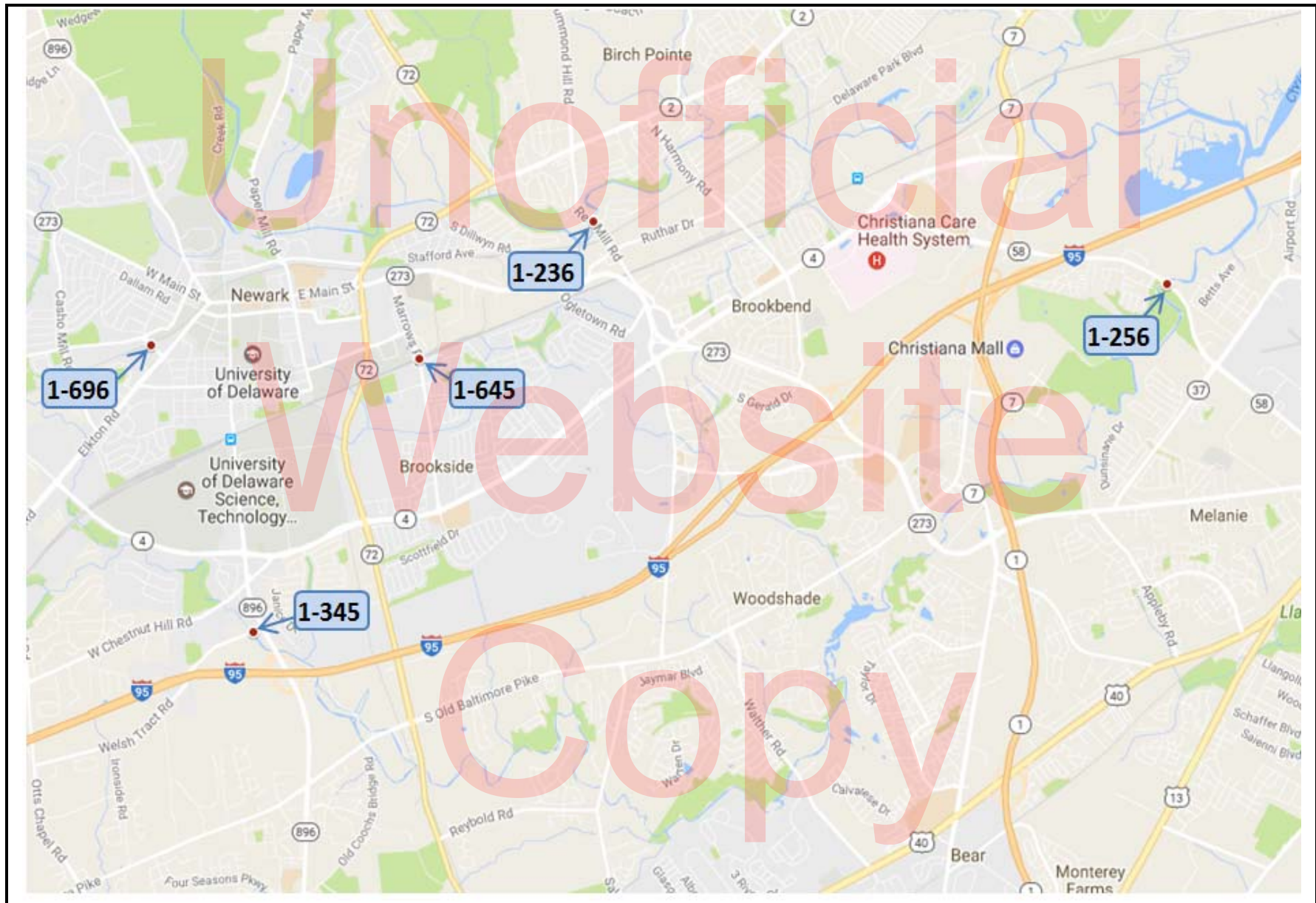

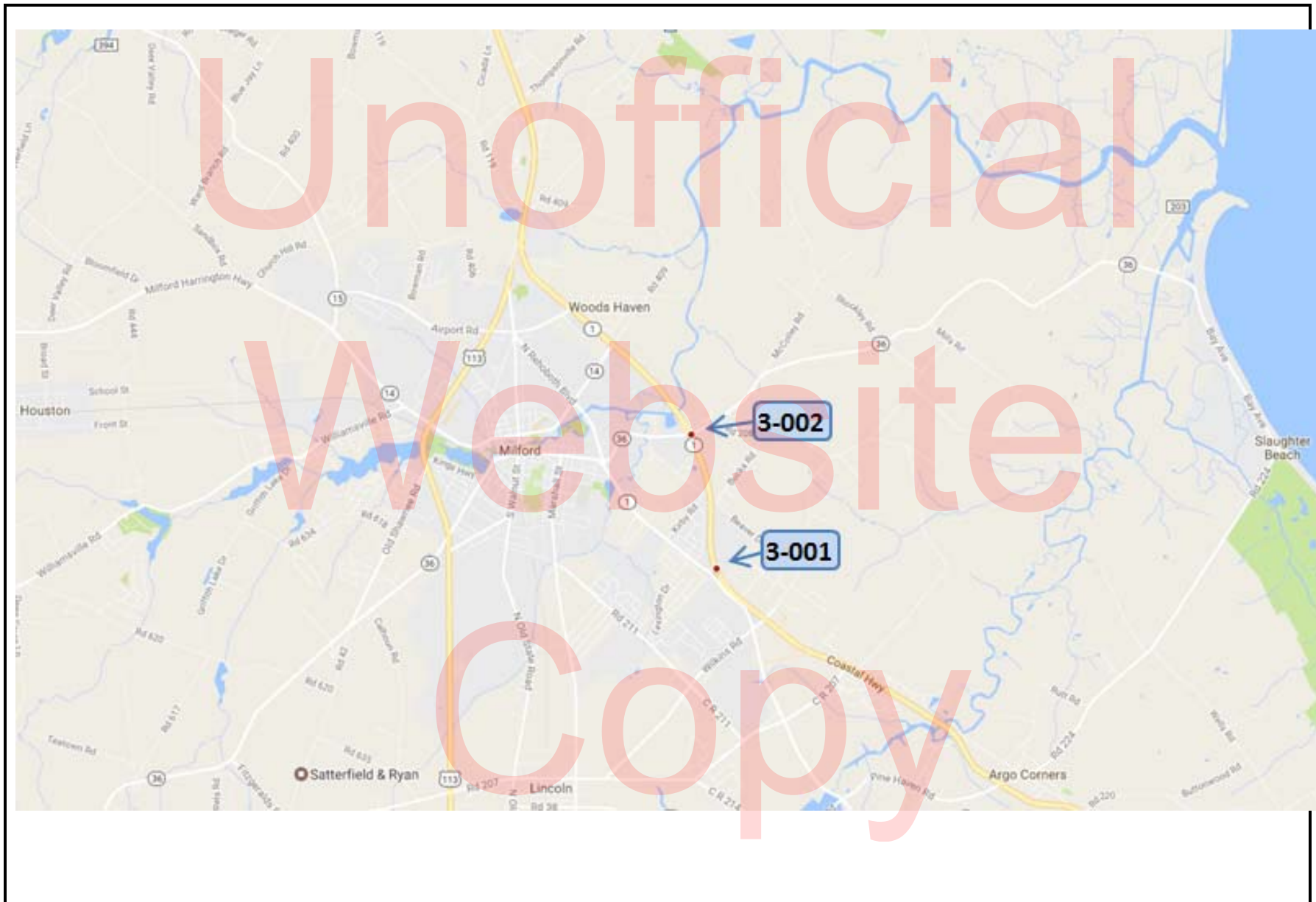



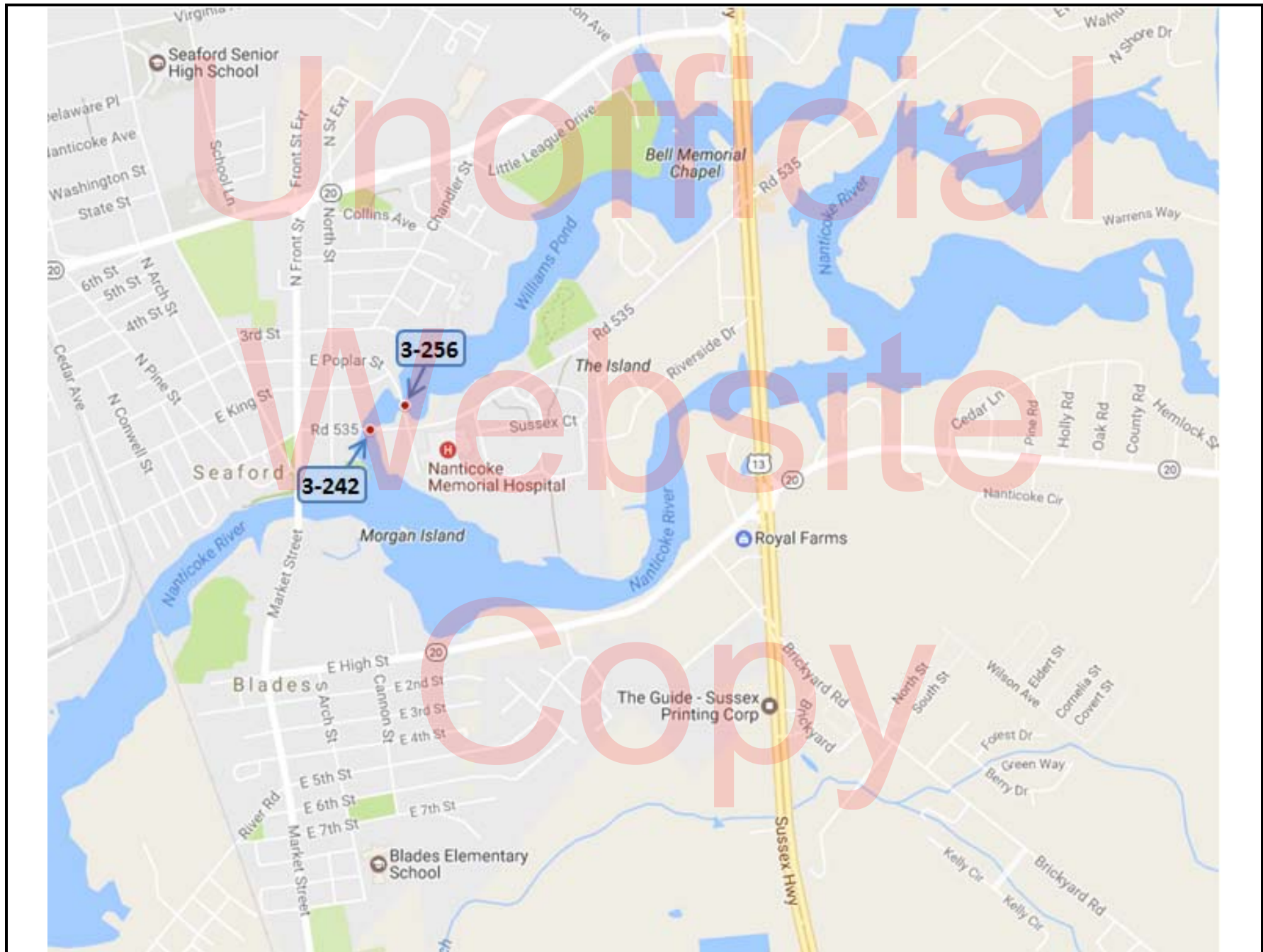

PORTABLE CHANGEABLE MESSAGE SIGNS

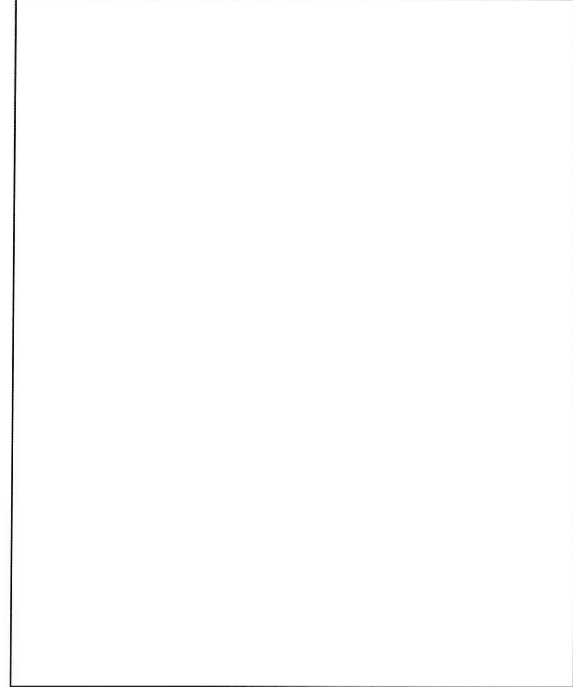

SPECIAL SIGNS

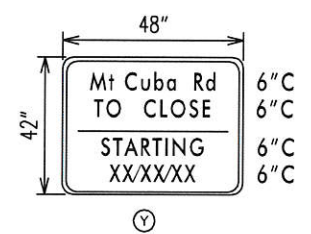

DISPLAY (Y) 10 DAYS PRIOR TO CONSTRUCTION  
REMOVE WHEN ROAD IS CLOSED  
D.G. RETROREFLECTIVE ORANGE BACKGROUND- BLACK LEGEND

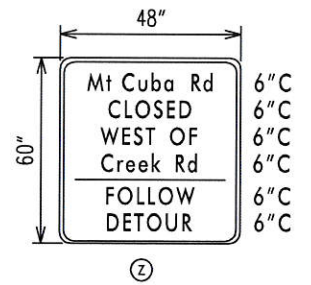

D.G. RETROREFLECTIVE ORANGE BACKGROUND- BLACK LEGEND

LEGEND

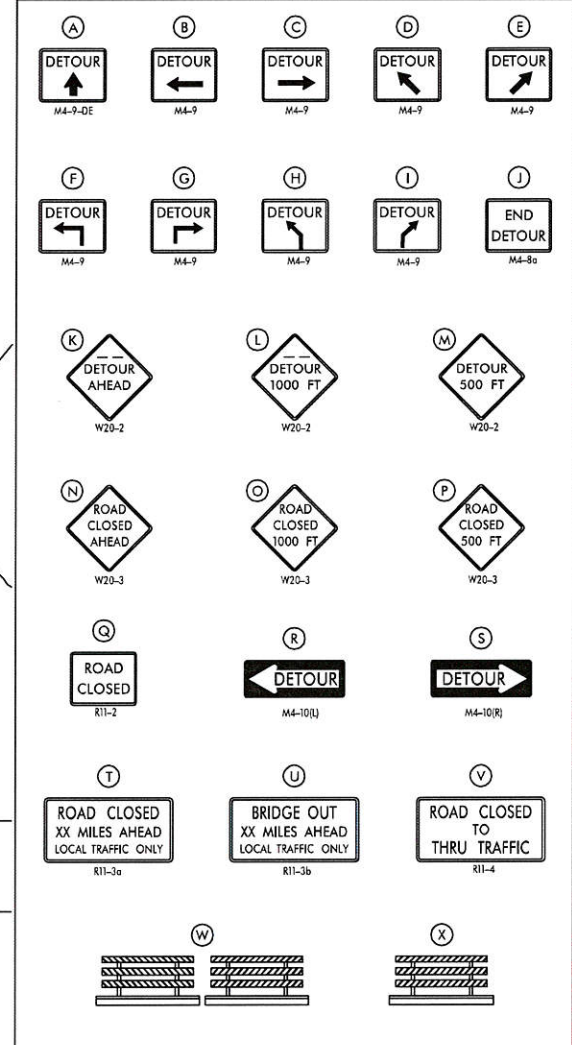

GENERAL NOTES

1. ALL DETOUR SIGNING, INCLUDING TRAILBLAZERS, ARE TO BE SUPPLIED AND MAINTAINED BY THE GENERAL CONTRACTOR IN COMPLIANCE WITH "THE DELAWARE MANUAL OF UNIFORM TRAFFIC CONTROL DEVICES" (DE MUTCD.)
2. THE CONTRACTOR SHALL COMPLY WITH GUIDELINES IN "THE DELAWARE MANUAL ON UNIFORM TRAFFIC CONTROL DEVICES" (DE MUTCD PART 6) FOR BARRICADES AND SIGNS (AS PER LATEST REVISION.)
3. DESIGN OF ALL SIGNS SHALL BE IN ACCORDANCE WITH THE FHWA STANDARD HIGHWAY SIGNS BOOK.
4. SIZES OF ALL SIGNS SHALL BE IN ACCORDANCE WITH "THE DELAWARE MANUAL OF UNIFORM TRAFFIC CONTROL DEVICES" (DE MUTCD.) SIZE OF SIGN SHALL BE BASED ON TYPE OF ROADWAY ON WHICH THE SIGN IS INSTALLED.
5. SIGNS NO LONGER IN USE SHALL BE COMPLETELY COVERED WITH NO RETROREFLECTIVE MATERIAL SHOWING, OR SHALL BE REMOVED, AS DIRECTED BY THE ENGINEER.
6. FIELD CONDITIONS MAY DICTATE CHANGES AT SOME TIME DURING THE LIFE OF THE CONTRACT. IN THE EVENT OF OMISSIONS OR CORRECTIONS, THE SIGNING PROVISIONS OF "THE DELAWARE MANUAL ON UNIFORM TRAFFIC CONTROL DEVICES" (DE MUTCD) WILL PREVAIL.
7. SIGNS "N" THROUGH "Q" AND "T" AND "V", THE WORD "ROAD" SHOULD BE CHANGED TO "RAMP", "RR XING", OR "BRIDGE" WHERE APPLICABLE.
8. WARNING SIGNS AND DETOUR TRAILBLAZERS SHALL BE MOUNTED ON BREAKAWAY POSTS AND HAVE RETROREFLECTIVE FLUORESCENT ORANGE SHEETING.
9. "W" BARRICADES SHALL COMPLETELY RUN THE FULL WIDTH OF THE ROADWAY.
10. BARRICADES SHALL BE A MINIMUM OF 6 FEET WIDE UNLESS DIRECTED BY THE ENGINEER.

RECOMMENDED _____ DATE: _____	RECOMMENDED _____ DATE: _____	RECOMMENDED _____ DATE: _____	APPROVED CHIEF SAFETY OFFICER <i>[Signature]</i> DATE: 10-16-17	APPROVED TRAFFIC ENGINEER <i>[Signature]</i> DATE: 10/16/17
DELAWARE DEPARTMENT OF TRANSPORTATION ADDENDUM / REVISIONS NOT TO SCALE			BRIDGE DECK SEALING, FY18 BR 1-130	CONTRACT T201707702 COUNTY NC PERMIT NO. X DESIGNED BY: ESM CHECKED BY: ASW
VEHICULAR DETOUR PLAN				SHEET NO. x
MT CUBA RD				TOTAL SHTS. x

PORTABLE CHANGEABLE MESSAGE SIGNS

**PRIOR TO DETOUR**  
(10 DAYS PRIOR TO BEGINNING OF DETOUR)

PCMS-1  
 RED MILL ROAD TO CLOSE  
 XXXX/XX FOLLOW DETOUR

**DURING DETOUR**  
(DISPLAY FOR DURATION OF DETOUR)

PCMS-1  
 RED MILL ROAD CLOSED  
 FOLLOW DETOUR

**DURING DETOUR**  
(DISPLAY FOR DURATION OF DETOUR)

PCMS-2  
 RED MILL ROAD CLOSED  
 FOLLOW DETOUR

SPECIAL SIGNS

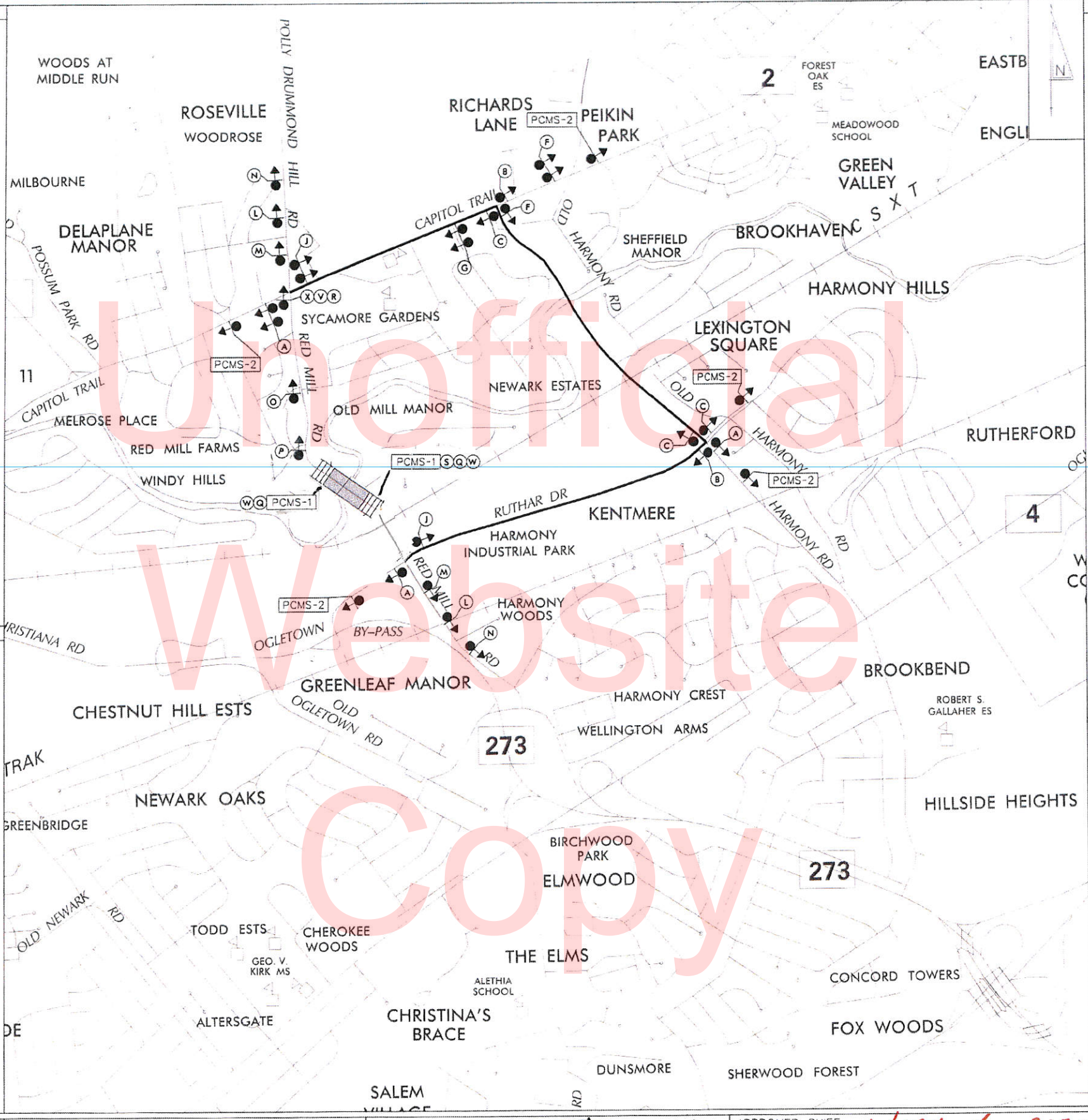

**LEGEND**

A	B	C	D	E
DETOUR (M4-9-DE)	DETOUR (M4-9)	DETOUR (M4-9)	DETOUR (M4-9)	DETOUR (M4-9)
F	G	H	I	J
DETOUR (M4-9)	DETOUR (M4-9)	DETOUR (M4-9)	DETOUR (M4-9)	END DETOUR (M4-8)
K	L	M		
DETOUR AHEAD (W20-2)	DETOUR 1000 FT (W20-2)	DETOUR 500 FT (W20-2)		
N	O	P		
ROAD CLOSED AHEAD (W20-3)	ROAD CLOSED 1000 FT (W20-3)	ROAD CLOSED 500 FT (W20-3)		
Q	R	S		
ROAD CLOSED (R11-2)	DETOUR (M4-10J)	DETOUR (M4-10K)		
T	U	V		
ROAD CLOSED XX MILES AHEAD LOCAL TRAFFIC ONLY (R11-3a)	BRIDGE OUT XX MILES AHEAD LOCAL TRAFFIC ONLY (R11-3b)	ROAD CLOSED THRU TRAFFIC (R11-4)		
W	X			
ROAD CLOSED (W20-1)	ROAD CLOSED (W20-1)	ROAD CLOSED (W20-1)		

GENERAL NOTES

- ALL DETOUR SIGNING, INCLUDING TRAILBLAZERS, ARE TO BE SUPPLIED AND MAINTAINED BY THE GENERAL CONTRACTOR IN COMPLIANCE WITH THE DELAWARE MANUAL ON UNIFORM TRAFFIC CONTROL DEVICES (THE MUTCD).
- THE CONTRACTOR SHALL COMPLY WITH GUIDELINES IN THE DELAWARE MANUAL ON UNIFORM TRAFFIC CONTROL DEVICES, DE MCDL 2015, FOR BARRICADES AND SIGNS AND PER LATEST REVISION.
- DESIGN OF ALL SIGNS SHALL BE IN ACCORDANCE WITH THE FHWA STANDARD HIGHWAY SIGN BOOK.
- SIZES OF ALL SIGNS SHALL BE IN ACCORDANCE WITH THE DELAWARE MANUAL ON UNIFORM TRAFFIC CONTROL DEVICES. DE MCDL 2015. SIZE OF SIGN SHALL BE BASED ON TYPE OF ROADWAY ON WHICH THE SIGN IS INSTALLED.
- SIGNS NO LONGER IN USE SHALL BE COMPLETELY COVERED WITH NO RETROREFLECTIVE MATERIAL SHOWING, OR SHALL BE REMOVED, AS DIRECTED BY THE ENGINEER.
- FIELD CONDITIONS MAY DICTATE CHANGES AT SOME TIME DURING THE LIFE OF THE CONTRACT. IN THE EVENT OF OMISSIONS OR CORRECTIONS, THE SIGNING PROVISIONS OF THE DELAWARE MANUAL ON UNIFORM TRAFFIC CONTROL DEVICES DE MCDL 2015 WILL PREVAIL.
- SIGNS IN THROUGH LANE AND AT THE WIDE ROAD SHOULD BE CHANGED TO RAMP OR YIELD OR BRIDGE, WHERE APPLICABLE.
- WARNING SIGNS AND DETOUR TRAILBLAZERS SHALL BE MOUNTED ON BREAKAWAY POSTS AND HAVE RETROREFLECTIVE FULL-BRIGHT ORANGE SHEETING.
- W/ BARRICADES SHALL COMPLETELY CLOSE THE FULL WIDTH OF THE ROADWAY.
- BARRICADES SHALL BE A MINIMUM OF 10 FEET WIDE UNLESS DIRECTED BY THE ENGINEER.

RECOMMENDED \_\_\_\_\_ DATE: \_\_\_\_\_  
 RECOMMENDED \_\_\_\_\_ DATE: \_\_\_\_\_  
 RECOMMENDED BSD DATE: 5/16/17  
 APPROVED CHIEF SAFETY OFFICER [Signature] DATE: 5-20-17  
 APPROVED TRAFFIC ENGINEER [Signature] DATE: 5/26/17

<p>DELAWARE DEPARTMENT OF TRANSPORTATION</p>	ADDENDUM / REVISIONS	NOT TO SCALE	<p>PROJECT: N352</p> <p>DESIGNED BY: [Blank]</p> <p>CHECKED BY: [Blank]</p> <p>DRAWN BY: [Blank]</p>	<p>VEHICULAR DETOUR PLAN</p> <p>RED MILL ROAD NORTH OF RUTHAR DRIVE</p>	<p>SHEET NO. _____</p> <p>TOTAL SHEETS _____</p>

5/26/2017 1:50:05 PM Power Delivery Stations\175005.DWG 1:28:21 PM 48D-FLEX\Sweet\SDP\_FDS-Red Mill Road.dwg  
 20170526 14:50:05

**PORTABLE CHANGEABLE MESSAGE SIGNS**

**PRIOR TO DETOUR**  
(10 DAYS PRIOR TO BEGINNING OF DETOUR)

PCMS-1

**BUSINESS 1 TO CLOSE**

**STARTING**  
XXXXXX

**DURING DETOUR**  
(DISPLAY FOR THE DURATION OF DETOUR)

PCMS-2

**BUSINESS 1 CLOSED**

**FOLLOW**  
DETOUR

**SPECIAL SIGNS**

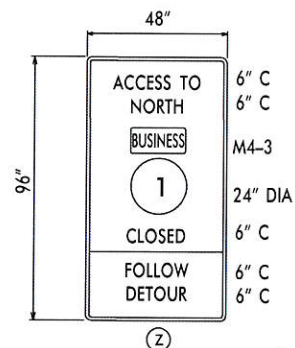

\* DG RETROREFLECTIVE BACKGROUND; BLACK LEGEND

BUSINESS

**1** ROUTE SHIELD & M4-3  
WHITE BACKGROUND; BLACK LEGEND

**LEGEND**

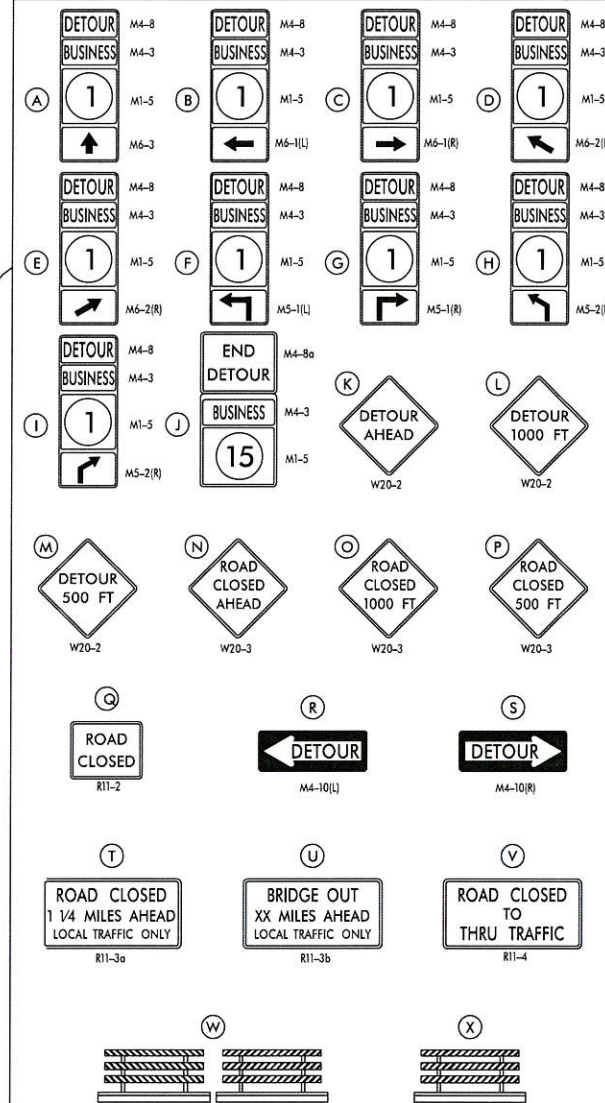

**GENERAL NOTES**

- ALL DETOUR SIGNING, INCLUDING TRAILBLAZERS, ARE TO BE SUPPLIED AND MAINTAINED BY THE GENERAL CONTRACTOR IN COMPLIANCE WITH "THE DELAWARE MANUAL ON UNIFORM TRAFFIC CONTROL DEVICES" (DE MUTCD.)
- THE CONTRACTOR SHALL COMPLY WITH GUIDELINES IN "THE DELAWARE MANUAL ON UNIFORM TRAFFIC CONTROL DEVICES" (DE MUTCD PART 6) FOR BARRICADES AND SIGNS (AS PER LATEST REVISION.)
- DESIGN OF ALL SIGNS SHALL BE IN ACCORDANCE WITH THE FHWA STANDARD HIGHWAY SIGNS BOOK.
- SIZES OF ALL SIGNS SHALL BE IN ACCORDANCE WITH THE DELAWARE MANUAL ON UNIFORM TRAFFIC CONTROL DEVICES" (DE MUTCD.) SIZE OF SIGN SHALL BE BASED ON TYPE OF ROADWAY ON WHICH THE SIGN IS INSTALLED.
- THE COLORS, DIMENSIONS, AND CHARACTERISTICS OF ALL INTERSTATE, U.S. ROUTE, AND STATE ROUTE SHIELD SIGNS SHALL BE IN ACCORDANCE WITH SECTION 2D.11 OF "THE DELAWARE MANUAL ON UNIFORM TRAFFIC CONTROL DEVICES" (DE MUTCD.)
- SIGNS NO LONGER IN USE SHALL BE COMPLETELY COVERED WITH NO RETROREFLECTIVE MATERIAL SHOWING, OR SHALL BE REMOVED, AS DIRECTED BY THE ENGINEER.
- FIELD CONDITIONS MAY DICTATE CHANGES AT SOME TIME DURING THE LIFE OF THE CONTRACT. IN THE EVENT OF OMISSIONS OR CORRECTIONS, THE SIGNING PROVISIONS OF "THE DELAWARE MANUAL ON UNIFORM TRAFFIC CONTROL DEVICES" (DE MUTCD) WILL PREVAIL.
- SIGNS "N" THROUGH "Q" AND "T" AND "V". THE WORD "ROAD" SHOULD BE CHANGED TO "RAMP", "RR XING", OR "BRIDGE" WHERE APPLICABLE.
- WARNING SIGNS AND DETOUR TRAILBLAZERS SHALL BE MOUNTED ON BREAKAWAY POSTS AND HAVE RETROREFLECTIVE FLUORESCENT ORANGE SHEETING.
- "W" BARRICADES SHALL COMPLETELY RUN THE FULL WIDTH OF THE ROADWAY.
- BARRICADES SHALL BE A MINIMUM OF 6 FEET WIDE UNLESS DIRECTED BY THE ENGINEER.



RECOMMENDED \_\_\_\_\_ DATE: \_\_\_\_\_

RECOMMENDED \_\_\_\_\_ DATE: \_\_\_\_\_

RECOMMENDED **Dan Thompson** DATE: **9/28/17**

APPROVED CHIEF SAFETY OFFICER *[Signature]* DATE: **10-16-17**

APPROVED TRAFFIC ENGINEER *[Signature]* DATE: **10/16/17**

**DELAWARE DEPARTMENT OF TRANSPORTATION**

ADDENDUM / REVISIONS

**NOT TO SCALE**

**BRIDGE DECK SEALING**

CONTRACT T201707702	ROAD NO. <b>BR 3-001</b>
COUNTY SUSSEX	DESIGNED BY: DT
	CHECKED BY: GAN

VEHICULAR DETOUR PLAN	SHEET NO. x
BUSINESS 1	TOTAL SHTS. x

W:\MSV\CELLS\PROJ\DEV\SB\CEL

PRIOR TO DETOUR <small>90 Days prior to beginning of detour</small>		DURING DETOUR <small>90 Days prior to beginning of detour</small>	
CMS-1 EB RT36 NB RT1 CLOSED	STARTING XX/XX/XX	CMS-1 EB RT36 NB RT1 CLOSED	FOLLOW DETOUR
CMS-2 WB RT36 SB RT1 CLOSED	STARTING XX/XX/XX	CMS-2 WB RT36 SB RT1 CLOSED	FOLLOW DETOUR
CMS-3 NB RT1 EB RT36 CLOSED	STARTING XX/XX/XX	CMS-3 NB RT1 EB RT36 CLOSED	FOLLOW DETOUR
CMS-4 SB RT1 WB RT36 CLOSED	STARTING XX/XX/XX	CMS-4 SB RT1 WB RT36 CLOSED	FOLLOW DETOUR

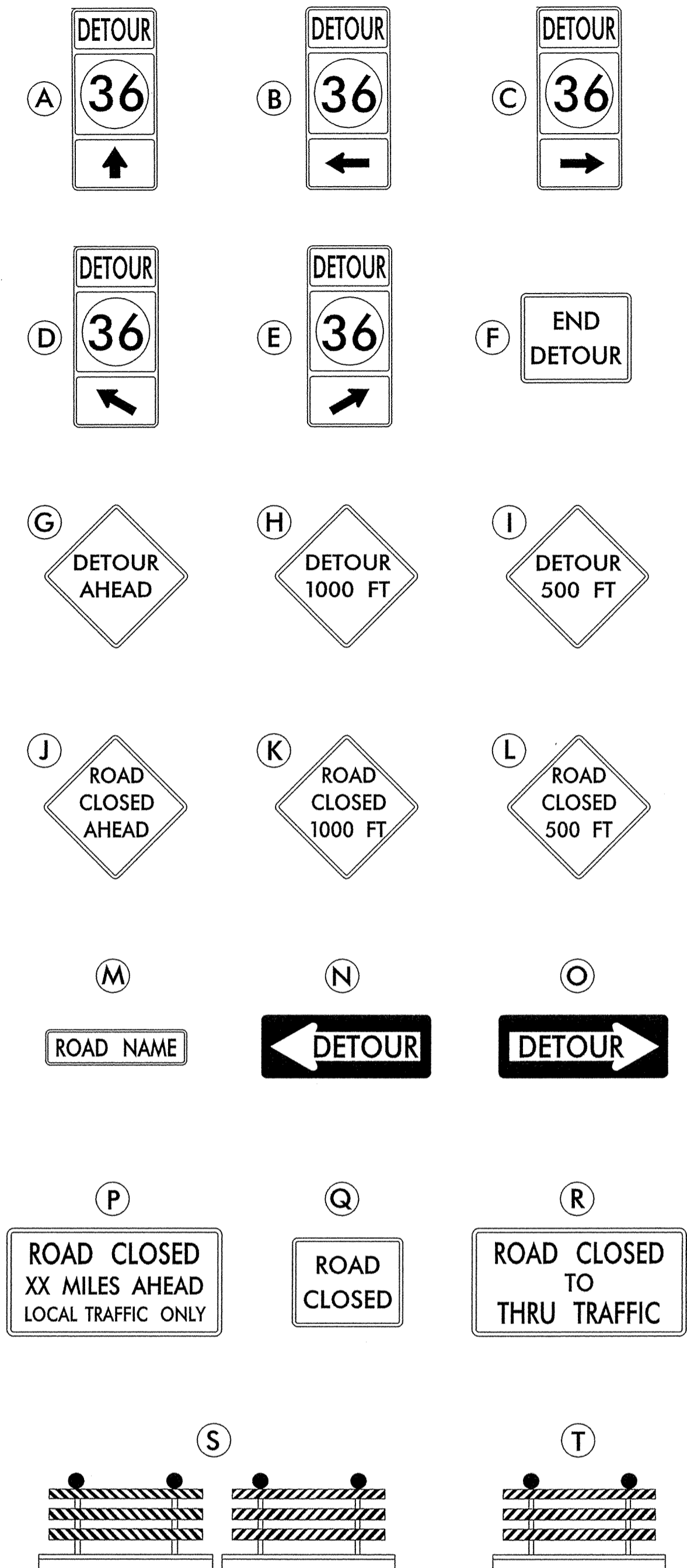
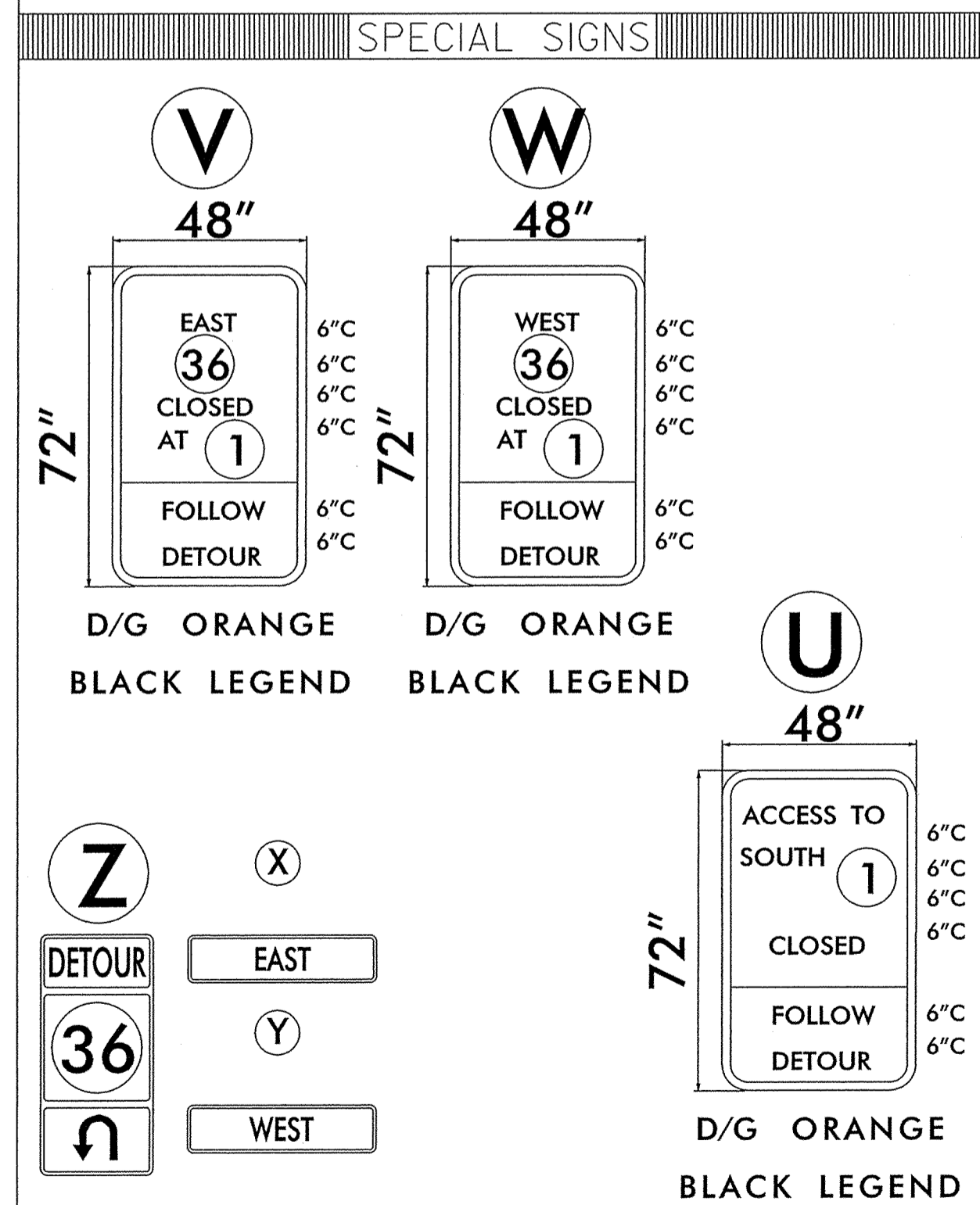
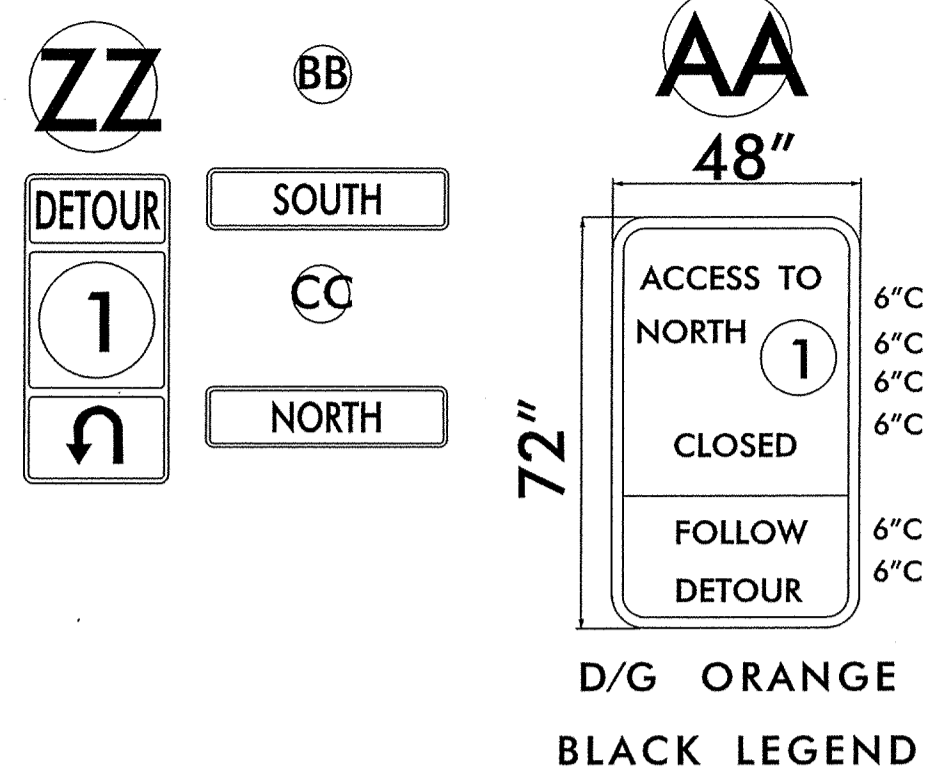

GENERAL NOTES

- ALL DETOUR SIGNING INCLUDING TRAILBLAZERS, ARE TO BE SUPPLIED AND MAINTAINED BY THE GENERAL CONTRACTOR IN COMPLIANCE TO THE DE MANUAL ON UNIFORM TRAFFIC CONTROL DEVICES.
- THE CONTRACTOR SHALL COMPLY WITH GUIDELINES IN THE DELAWARE MANUAL ON UNIFORM TRAFFIC CONTROL DEVICES (DE- MUTCD PART 6) FOR LIGHTS, BARRICADES AND SIGNS, AS PER LATEST REVISION.
- FIELD CONDITIONS MAY DICTATE CHANGES AT SOME TIME DURING THE LIFE OF THE CONTRACT. IN THE EVENT OF OMISSIONS OR CORRECTIONS, THE SIGNING PROVISIONS OF THE DELAWARE MANUAL ON UNIFORM TRAFFIC CONTROL DEVICES WILL PREVAIL.
- SIGNS J THROUGH L AND P THROUGH R, THE WORD (ROAD) SHOULD BE CHANGED TO RAMP, R/R OR BRIDGE WHERE APPLICABLE.
- WARNING SIGNS SHOULD BE MOUNTED ON BREAKAWAY POSTS AND HAVE RETROREFLECTIVE FLUORESCENT SHEETING.
- \*S\* BARRICADES SHALL COMPLETELY RUN THE FULL WIDTH OF ROADWAY.
- BARRICADES SHALL BE A MINIMUM OF 6 FEET WIDE UNLESS DIRECTED BY THE ENGINEER.

RECOMMENDED \_\_\_\_\_ DATE: 10-6-10 APPROVED CHIEF SAFETY OFFICER \_\_\_\_\_ DATE: 10-6-10

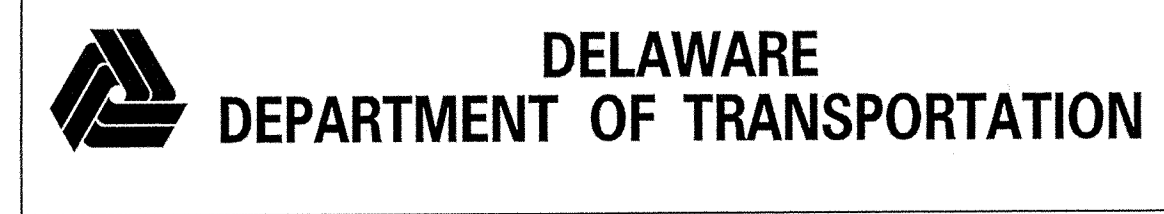

ADDENDUM / REVISIONS

NOT TO SCALE

RT 36 OVERPASS DETOUR

CONTRACT	ROAD NO.
COUNTY	DESIGNED BY: MF
KENT/SUSSEX	CHECKED BY: ASW

DETOUR PLAN	SHEET NO.
	TOTAL SHTS.

**PORTABLE CHANGEABLE MESSAGE SIGNS**

**PRIOR TO DETOUR**  
(10 DAYS PRIOR TO BEGINNING OF DETOUR)

PCMS-1

POPLAR ST TO CLOSE

STARTING  
XXXXXX

**DURING DETOUR**  
(DISPLAY FOR THE DURATION OF DETOUR)

PCMS-2

POPLAR STREET CLOSED

FOLLOW  
DETOUR

**SPECIAL SIGNS**

72"	48"	Poplar Street	6" C
		CLOSED	6" C
		NORTH OF Middleford Bridge Road	6" C
		FOLLOW DETOUR	6" C
		FOLLOW DETOUR	6" C
		FOLLOW DETOUR	6" C

(Y)

72"	48"	Poplar Street	6" C
		CLOSED	6" C
		SOUTH OF King Street	6" C
		FOLLOW DETOUR	6" C
		FOLLOW DETOUR	6" C
		FOLLOW DETOUR	6" C

(Z)

\* D/G RETROREFLECTIVE BACKGROUND; BLACK LEGEND

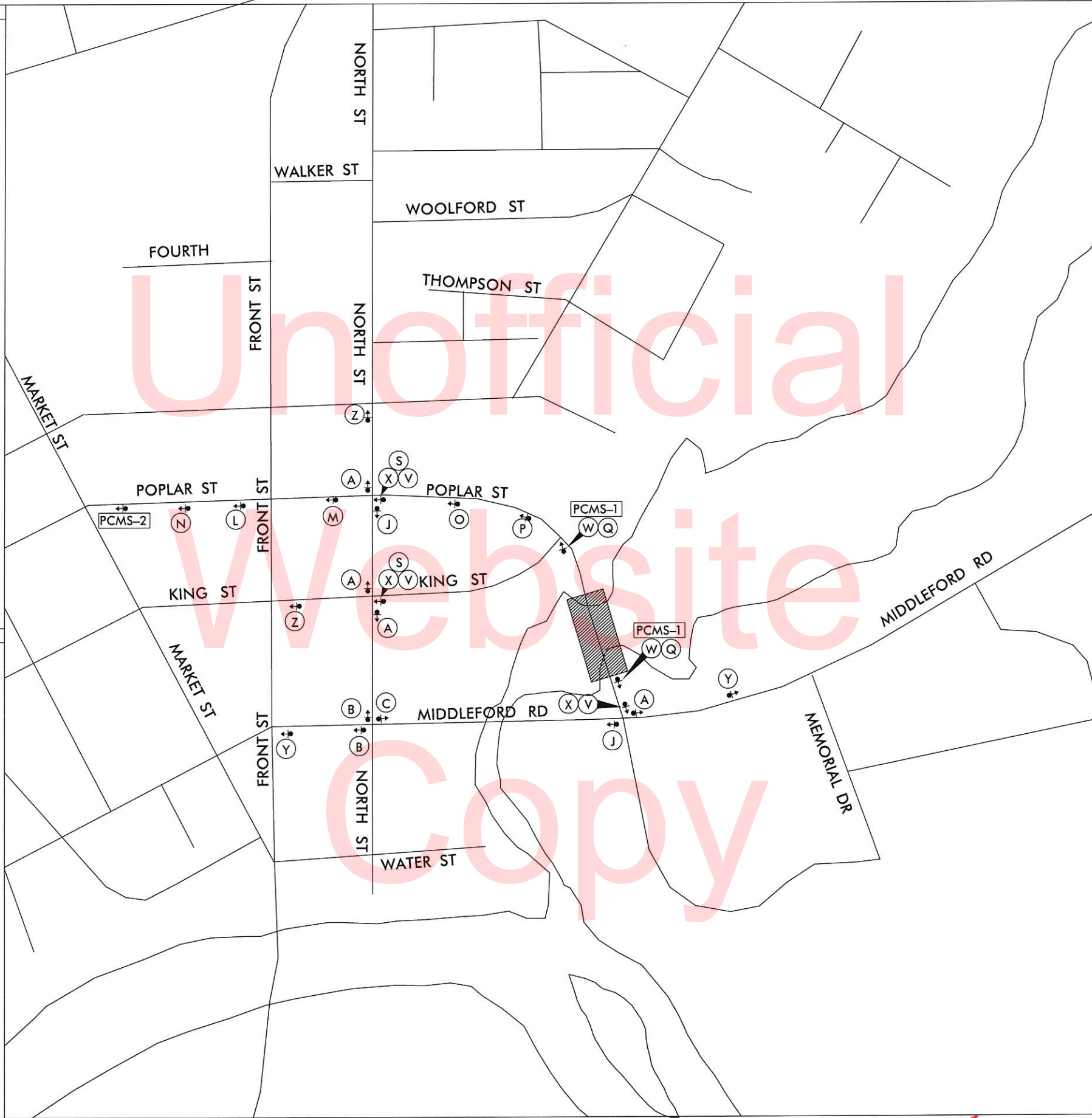

**LEGEND**

(A) DETOUR M4-9-DE	(B) DETOUR M4-9	(C) DETOUR M4-9	(D) DETOUR M4-9	(E) DETOUR M4-9
(F) DETOUR M4-9	(G) DETOUR M4-9	(H) DETOUR M4-9	(I) DETOUR M4-9	(J) END DETOUR M4-8a
(K) DETOUR AHEAD W20-2	(L) DETOUR 1000 FT W20-2	(M) DETOUR 500 FT W20-2		
(N) ROAD CLOSED AHEAD W20-3	(O) ROAD CLOSED 1000 FT W20-3	(P) ROAD CLOSED 500 FT W20-3		
(Q) ROAD CLOSED R11-2	(R) DETOUR M4-10(L)	(S) DETOUR M4-10(R)		
(T) ROAD CLOSED 1 1/4 MILES AHEAD LOCAL TRAFFIC ONLY R11-3a	(U) BRIDGE OUT XX MILES AHEAD LOCAL TRAFFIC ONLY R11-3b	(V) ROAD CLOSED TO THRU TRAFFIC R11-4		
(W) BARRICADE		(X) BARRICADE		

- GENERAL NOTES**
- ALL DETOUR SIGNING, INCLUDING TRAILBLAZERS, ARE TO BE SUPPLIED AND MAINTAINED BY THE GENERAL CONTRACTOR IN COMPLIANCE WITH "THE DELAWARE MANUAL OF UNIFORM TRAFFIC CONTROL DEVICES" (DE MUTCD.)
  - THE CONTRACTOR SHALL COMPLY WITH GUIDELINES IN "THE DELAWARE MANUAL ON UNIFORM TRAFFIC CONTROL DEVICES" (DE MUTCD PART 6) FOR BARRICADES AND SIGNS (AS PER LATEST REVISION.)
  - DESIGN OF ALL SIGNS SHALL BE IN ACCORDANCE WITH THE FHWA STANDARD HIGHWAY SIGNS BOOK.
  - SIZES OF ALL SIGNS SHALL BE IN ACCORDANCE WITH "THE DELAWARE MANUAL OF UNIFORM TRAFFIC CONTROL DEVICES" (DE MUTCD.) SIZE OF SIGN SHALL BE BASED ON TYPE OF ROADWAY ON WHICH THE SIGN IS INSTALLED.
  - SIGNS NO LONGER IN USE SHALL BE COMPLETELY COVERED WITH NO RETROREFLECTIVE MATERIAL SHOWING, OR SHALL BE REMOVED, AS DIRECTED BY THE ENGINEER.
  - FIELD CONDITIONS MAY DICTATE CHANGES AT SOME TIME DURING THE LIFE OF THE CONTRACT. IN THE EVENT OF OMISSIONS OR CORRECTIONS, THE SIGNING PROVISIONS OF "THE DELAWARE MANUAL ON UNIFORM TRAFFIC CONTROL DEVICES" (DE MUTCD) WILL PREVAIL.
  - SIGNS "N" THROUGH "Q" AND "T" AND "V", THE WORD "ROAD" SHOULD BE CHANGED TO "RAMP", "RR XING", OR "BRIDGE" WHERE APPLICABLE.
  - WARNING SIGNS AND DETOUR TRAILBLAZERS SHALL BE MOUNTED ON BREAKAWAY POSTS AND HAVE RETROREFLECTIVE FLUORESCENT ORANGE SHEETING.
  - "W" BARRICADES SHALL COMPLETELY RUN THE FULL WIDTH OF THE ROADWAY.
  - BARRICADES SHALL BE A MINIMUM OF 6 FEET WIDE UNLESS DIRECTED BY THE ENGINEER.

RECOMMENDED \_\_\_\_\_ DATE: \_\_\_\_\_

RECOMMENDED \_\_\_\_\_ DATE: \_\_\_\_\_

RECOMMENDED Dan Thompson DATE: 9/28/17 APPROVED CHIEF SAFETY OFFICER [Signature] DATE: 10-16-17 APPROVED TRAFFIC ENGINEER [Signature] DATE: 10/16/17

<p><b>DELAWARE DEPARTMENT OF TRANSPORTATION</b></p>	ADDENDUM / REVISIONS	<p>NOT TO SCALE</p> <p>BRIDGE DECK SEALING</p>	CONTRACT T201707702	ROAD NO. BR 3-256	<p>VEHICULAR DETOUR PLAN</p> <p>POPLAR ST</p>	SHEET NO. x	
				COUNTY SUSSEX		DESIGNED BY: DT	TOTAL SHTS. x
						CHECKED BY: GAN	

W:\MSV\CELLS\PROJ\DEV\SB.GEL