

THE STATE OF DELAWARE



DEPARTMENT OF TRANSPORTATION
MAINTENANCE AND OPERATIONS
CONSTRUCTION PLANS AND SPECIFICATIONS FOR
SUBDIVISION PAVING, NORTH I, 2024

CONTRACT NUMBER - T202404901

UNIFIER PROJECT ID – 2024-00061

FEDERAL AID NUMBER - NONE

COUNTY: NEW CASTLE

PLANS PREPARED BY: 
DESIGNER

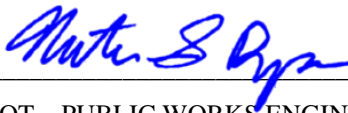

11/13/23

DELDOT – PUBLIC WORKS ENGINEER/PM II
MAINTENANCE AND OPERATIONS - (CAD)

DATE

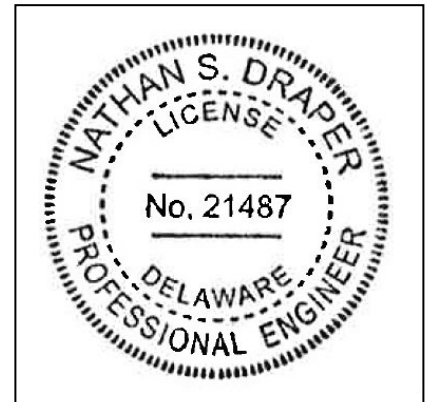

THIS SEAL APPLIES TO ALL SHEETS
BEARING THE "CAD" SECTION
DESIGNATION

APPROVED FOR ADVERTISEMENT

Anne Brown

11/14/2023

DIRECTOR OF MAINTENANCE AND OPERATIONS

DATE

DEPARTMENT OF TRANSPORTATION

CONTRACT NUMBER- T202404901

(CAD) PAGE 2 OF 47

Contract is for various locations throughout New Castle County.

LOCATION MAP



DEPARTMENT OF TRANSPORTATION

CONTRACT NUMBER- T202404901

(CAD) PAGE 3 OF 47

Contract is for various locations throughout New Castle County.

LOCATION MAP

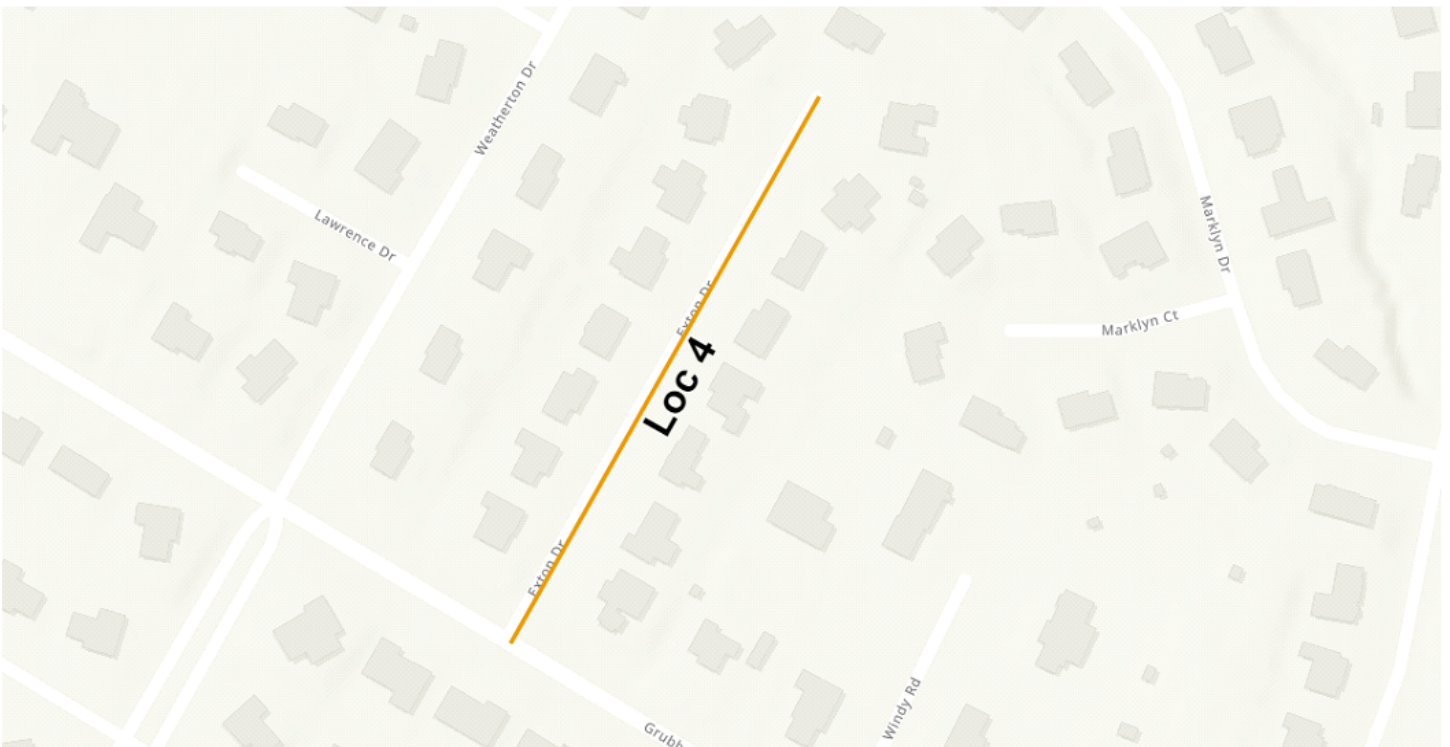

DEPARTMENT OF TRANSPORTATION

CONTRACT NUMBER- T202404901

(CAD) PAGE 4 OF 47

Contract is for various locations throughout New Castle County.

LOCATION MAP

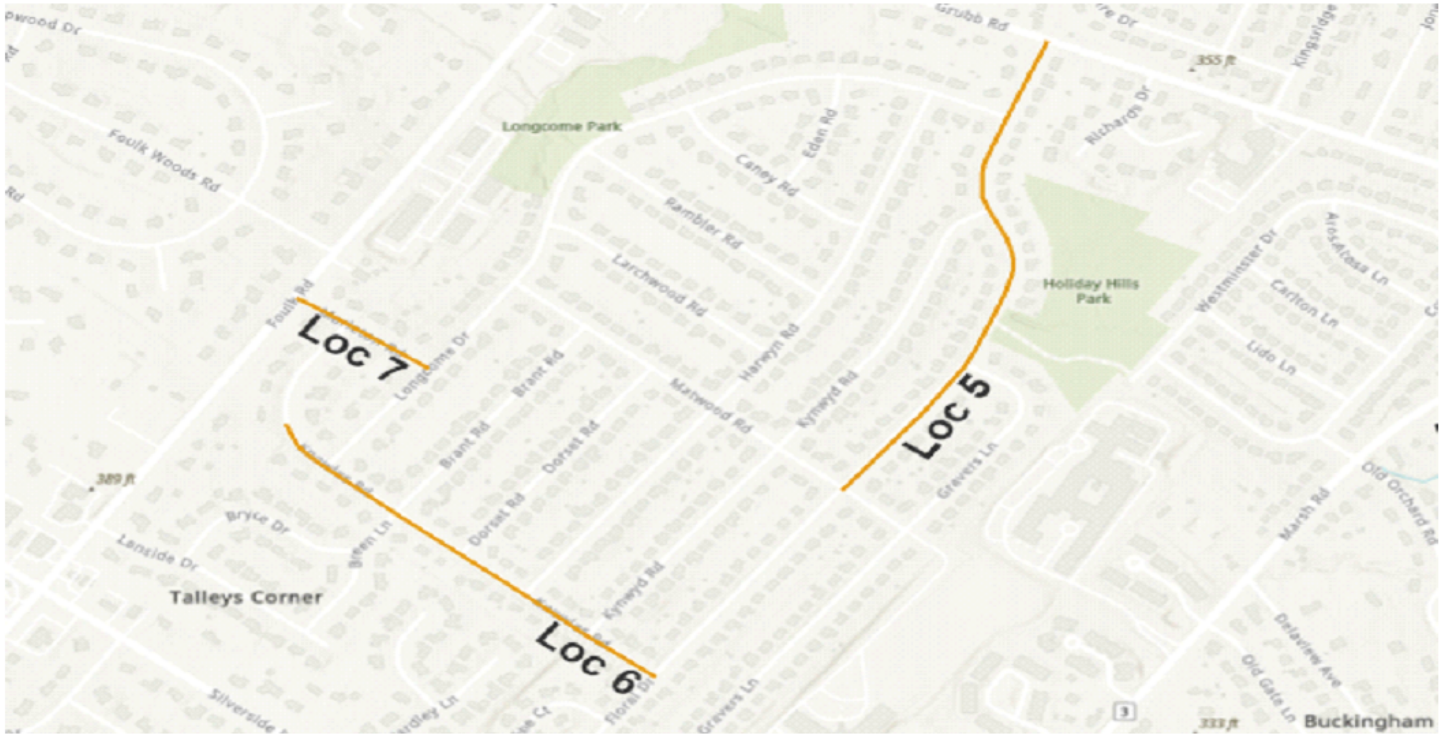

DEPARTMENT OF TRANSPORTATION

CONTRACT NUMBER- T202404901

(CAD) PAGE 5 OF 47

Contract is for various locations throughout New Castle County.

LOCATION MAP

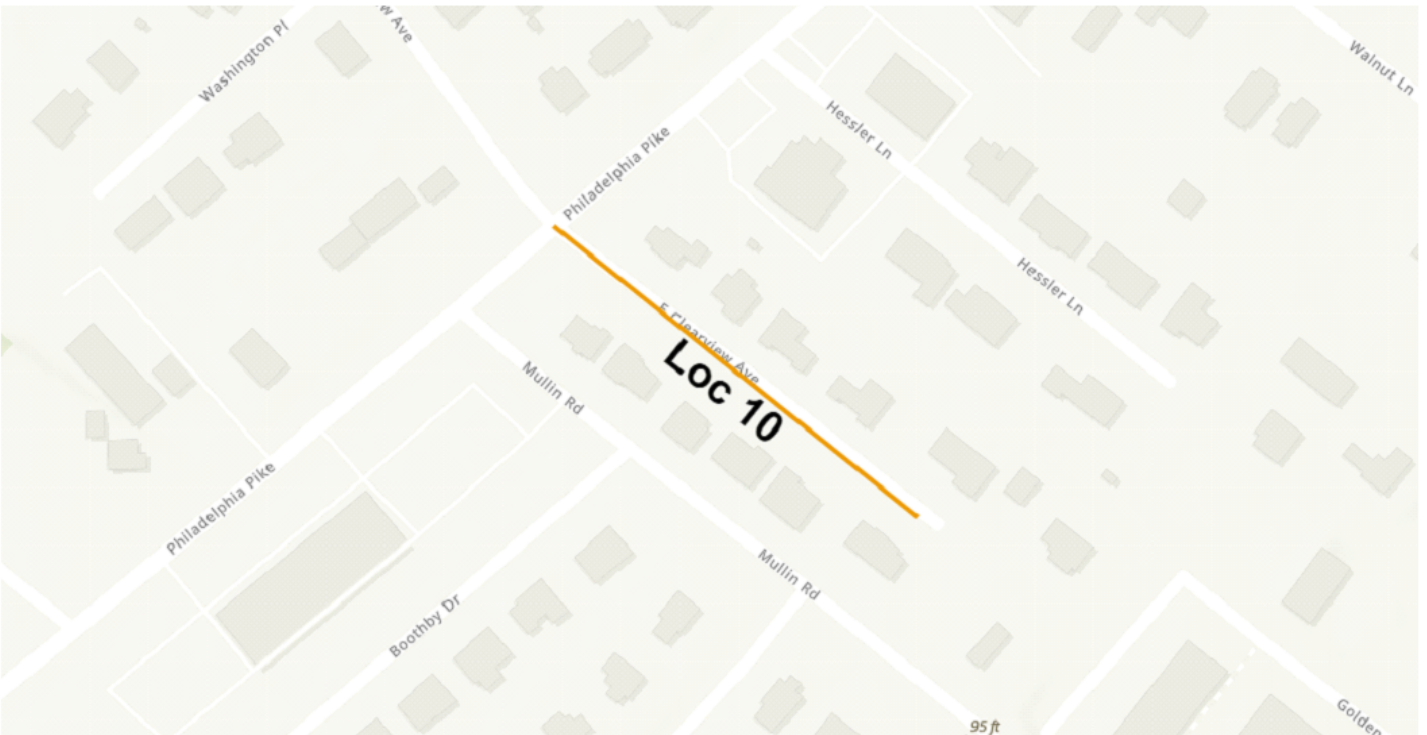

DEPARTMENT OF TRANSPORTATION

CONTRACT NUMBER- T202404901

(CAD) PAGE 6 OF 47

Contract is for various locations throughout New Castle County.

LOCATION MAP

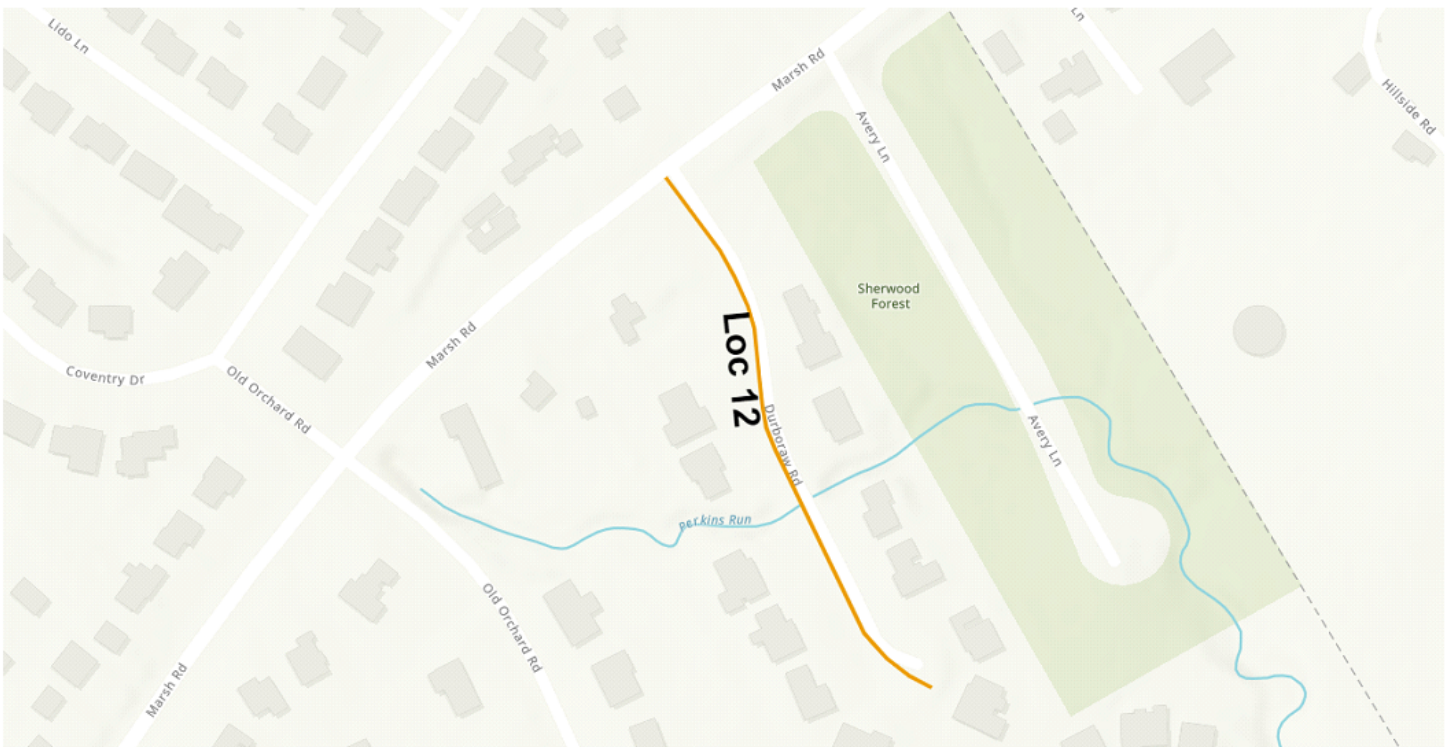

DEPARTMENT OF TRANSPORTATION

CONTRACT NUMBER- T202404901

(CAD) PAGE 7 OF 47

Contract is for various locations throughout New Castle County.

LOCATION MAP

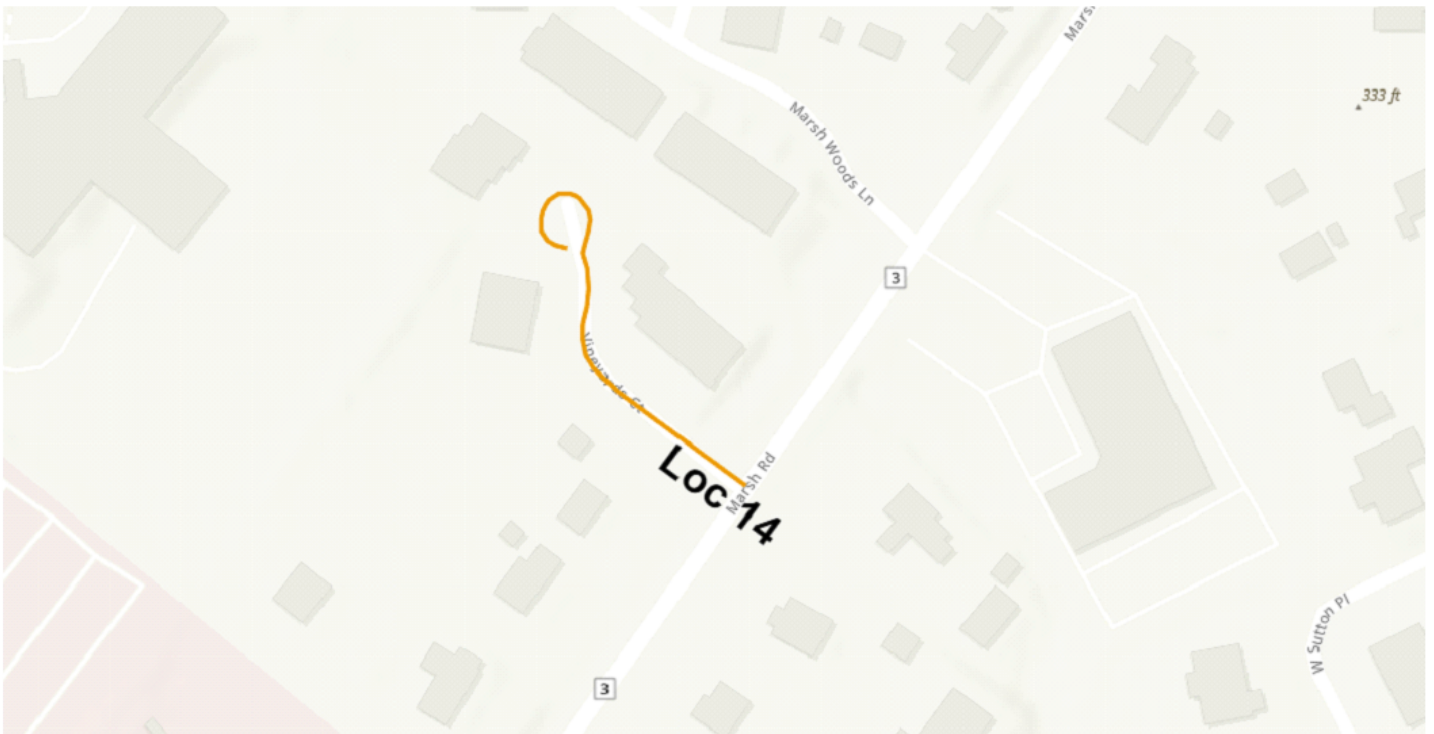
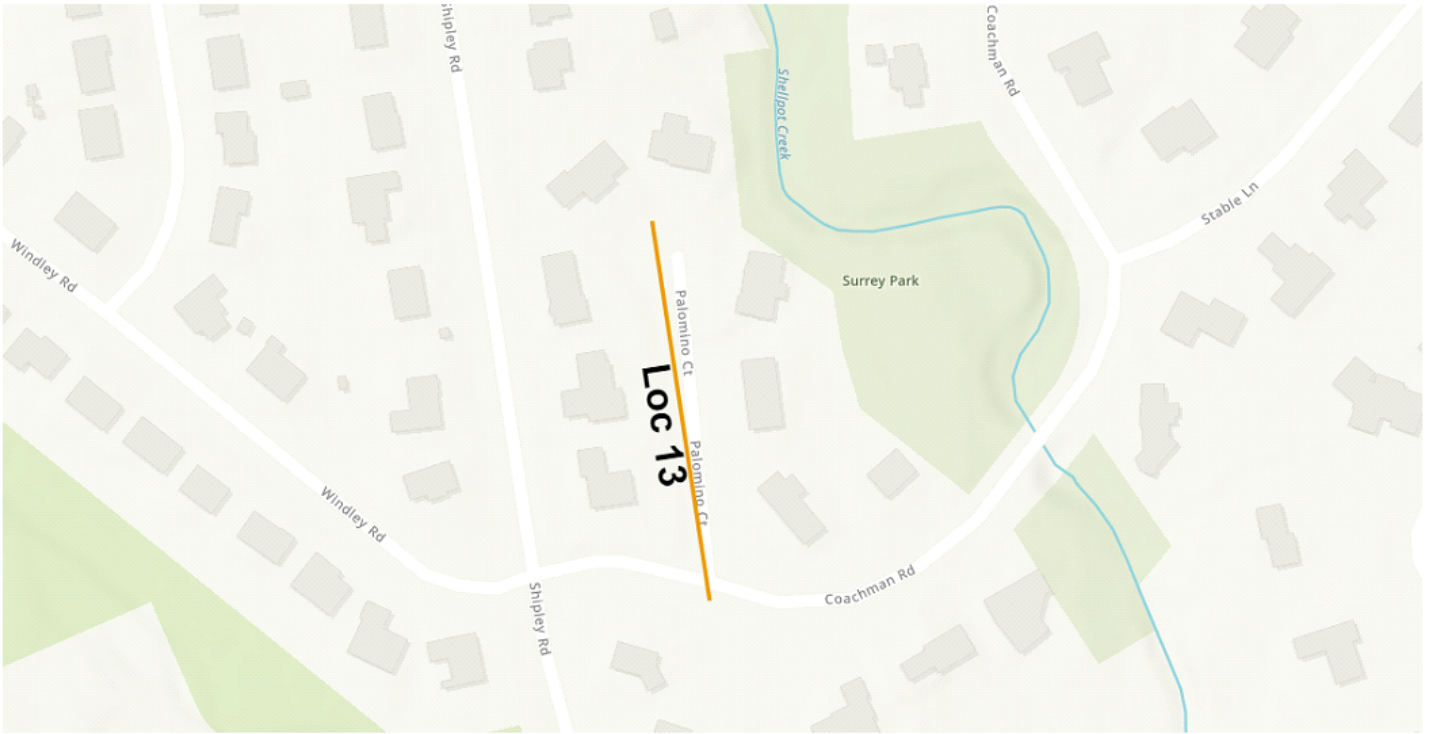

DEPARTMENT OF TRANSPORTATION

CONTRACT NUMBER- T202404901

(CAD) PAGE 8 OF 47

Contract is for various locations throughout New Castle County.

LOCATION MAP

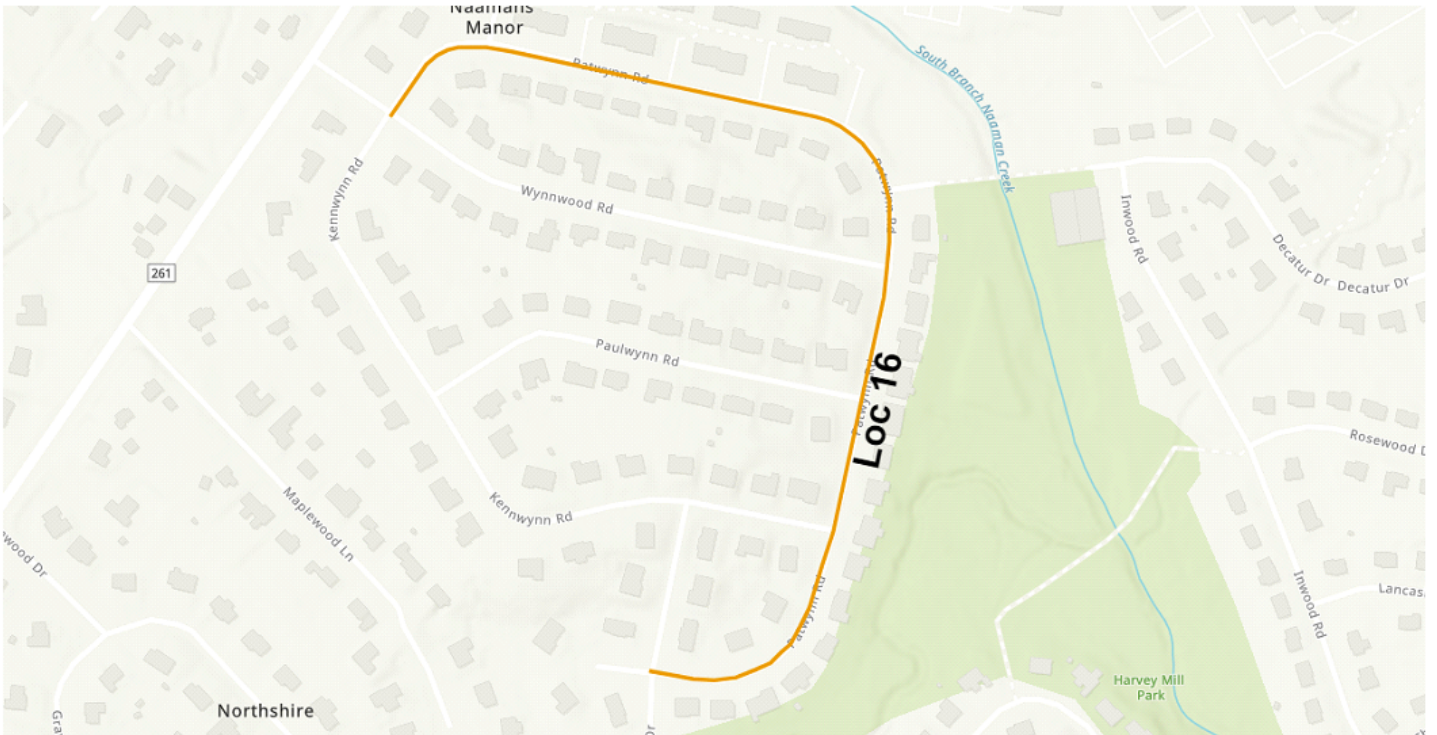

GENERAL CONTRACT PLAN NOTES

SECTION 100

1. THIS PROJECT IS TO BE CONSTRUCTED IN ACCORDANCE WITH THE DELAWARE DEPARTMENT OF TRANSPORTATION STANDARD SPECIFICATIONS FOR ROAD AND BRIDGE CONSTRUCTION DATED JUNE 2022 AND THE DELAWARE DEPARTMENT OF TRANSPORTATION STANDARD CONSTRUCTION DETAILS DATED 2022, INCLUDING ALL REVISIONS UP TO THE DATE OF ADVERTISEMENT.

2. THE PURPOSE OF THIS CONTRACT IS TO MAKE GENERAL IMPROVEMENTS TO ROADS AND/OR STREETS WITHIN THE DISTRICT HEREIN SPECIFIED. DEPENDING ON FUND AVAILABILITY, THE DEPARTMENT RESERVES THE RIGHT TO ADD OR DELETE LOCATIONS AND/OR QUANTITIES FOR THIS CONTRACT. SUCH ADDITIONS OR DELETIONS SHALL NOT BE CAUSE FOR AN INCREASE OR DECREASE IN ANY CONTRACT UNIT BID PRICES. NO ITEM PRICES ARE TO BE RENEGOTIATED DUE TO EITHER AN INCREASE OR DECREASE IN QUANTITY USAGE RESULTING FROM SAID ADDITIONS OR DELETIONS.

3. THE CONTRACTOR SHALL PROVIDE WRITTEN NOTICE TO RESIDENTS AT LEAST 48 HOURS, BUT NO MORE THAN 96 HOURS, PRIOR TO ALL PHASES OF CONTRACT WORK INCLUDING BUT NOT LIMITED TO: SAWCUTTING FOR P.C.C. OPERATIONS, P.C.C. REMOVAL AND REPLACEMENT, PAVEMENT MILLING, AND PAVING. THIS NOTICE SHALL BE GIVEN TO ALL RESIDENTS WHOSE PROPERTY IS ADJACENT TO THE STREET ON WHICH WORK IS TO BE PERFORMED. FAILURE TO GIVE PROPER NOTICE WILL RESULT IN A SUSPENSION OF WORK REQUIRING NOTICE, UNTIL PROPER NOTICE IS PROVIDED. UPON COMPLETION OF DISTRIBUTING WRITTEN NOTICES, THE CONTRACTOR SHALL IMMEDIATELY NOTIFY THE ENGINEER.

4. LOCATION LISTINGS INDICATE GENERAL LIMITS OF CONSTRUCTION, MAJOR TYPES OF IMPROVEMENTS, AND ESTIMATED QUANTITIES. DURING THE BIDDING PERIOD, ANY QUESTIONS PERTAINING TO LOCATIONS SHALL BE DIRECTED TO THE CONTRACT ADMINISTRATOR. AFTER THE AWARD, SUCH QUESTIONS SHALL BE REFERRED TO THE APPROPRIATE DISTRICT ENGINEER OR HIS REPRESENTATIVE.

5. THIS CONTRACT WILL HAVE CLEAR "START BY" DATE AND TIME ALLOCATED FOR COMPLETION. FAILURE TO COMPLETE THE CONTRACT IN THE SPECIFIED TIME SHALL CONSTITUTE "FAILURE TO PURSUE THE WORK" AND SUBJECTS THE CONTRACTOR TO LIQUIDATED DAMAGES AS OUTLINED IN SUBSECTION 108.8 OF THE STANDARD SPECIFICATIONS.

6. THE CONTRACTOR SHALL SUBMIT THE REQUIRED COPIES OF A DETAILED PROGRESS SCHEDULE (PSC) AS OUTLINED IN STANDARD SPECIFICATION 108.4 PRIOR TO THE PRECONSTRUCTION MEETING. DETAILS SHALL INCLUDE A DESCRIPTION OF EACH WORK ACTIVITY, THE PLANNED DAYS OF WORK, MULTIPLE CREWS OR SHIFTS, AND SCHEDULED WORKING HOURS. DURING THE CONTRACT, THE CONTRACTOR SHALL SUBMIT TWO-WEEK (OR

DEPARTMENT OF TRANSPORTATION

**CONTRACT NUMBER- T202404901 CANAL
SUBDIVISION PAVING, NORTH I, 2024**

(CAD) PAGE 10 OF 47

GENERAL CONTRACT PLAN NOTES

AS REQUIRED) "LOOK AHEAD" SCHEDULES TO THE AREA ENGINEER/ MANAGER NO LATER THAN NOON OF EACH THURSDAY. FAILURE TO COMPLY WILL RESULT IN A SUSPENSION OF ALL CONTRACT WORK WITH TIME CHARGES CONTINUING TO BE ASSESSED.

ADDITIONAL WORK:

7. THE DEPARTMENT RESERVES THE RIGHT TO INCREASE OR DECREASE THE QUANTITIES OF THE ITEMS SPECIFIED IN THIS CONTRACT. SUCH ADDITIONS SHALL NOT BE CAUSE FOR AN INCREASE OR DECREASE IN ANY CONTRACT UNIT BID PRICES AND/OR LUMP SUM ITEMS IF THE INCREASE IN QUANTITIES DOES NOT REQUIRE REMOBILZATON.

8. THE DEPARTMENT RESERVES THE RIGHT TO ADD LOCATONS TO THIS CONTRACT. SPECIFIC WORK WILL BE ASSIGNED BY THE DEPARTMENT VIA WORK ORDERS AND THE DEPARTMENT WILL MAKE EVERY ATTEMPT TO MINIMIZE THE DISTANCE BETWEEN SUCCESSIVE LOCATIONS. THE CONTRACTOR MAY SUBMIT A REQUEST FOR ADDITIONAL MOT AND MOBILIZATION IN CONJUNCTION WITH ADDED LOCATIONS. THIS REQUEST WILL BE CONSIDERED ON THE BASIS OF EACH ADDITIONAL LOCATION. THE REQUEST FOR INITIAL EXPENSE/MOBILIZATION SHALL NOT EXCEED THE AMOUNT OF THE BID PRICE FOR 763000, DIVIDED BY THE NUMBER OF ORIGINAL CONTRACT LOCATIONS. THE REQUEST FOR MOT SHALL NOT EXCEED THE AMOUNT OF THE BID PRICE FOR 801500, DIVIDED BY THE NUMBER OF ORIGINAL CONTRACT LOCATIONS. FOR OPEN END CONTRACTS WITHOUT ORIGINAL LOCATIONS, BID ITEMS 763544-763552 SHALL BE FULL COMPENSATION FOR MOBILIZATION AND MOT.

EACH WORK ORDER ISSUED WILL HAVE CLEAR "START BY" DATE AND TIME ALLOCATED TO COMPLETE SAID WORK ORDER. ONCE TIME (CALENDAR DAYS) HAS BEEN ASSIGNED TO A WORK ORDER AND ISSUED, THE CONTRACTOR HAS 2 BUSINESS DAYS, NOT INCLUDING THE DAY OF ISSUANCE, TO DISPUTE THE TIME QUANTITY AND PROVIDE ADDITIONAL BACKUP DOCUMENTATION FOR WHY THE TIME QUANTITY IS NOT SUFFICIENT. A DETAILED BREAKDOWN OF LABOR/MATERIALS/EQUIPMENT ALONG WITH THE CONTRACTORS TIME ESTIMATE WILL BE REQUIRED; THIS INFORMATION MUST BE RECEIVED BY THE DEPARTMENT BY THE END OF THE 2ND BUSINESS DAY OR THE DEPARMENT WILL CONSIDER THE CONTRACTOR IN AGREEMENT WITH THE TIME ESTIMATE. THE ENGINEER WILL EVALUATE ANY REQUEST FOR MODIFICATION TO THE TIME ESTIMATE AND AT THEIR SOLE DISCRETION DETERMINE IF ADDITIONAL TIME IS GRANTED. DISPUTING TIME QUANTITY DOES NOT CONSTITUTE A DELAY IN COMMENCEMENT OF A WORK ORDER. ISSUANCE OF EACH WORK ORDER CONSTITUTES THE NOTICE TO PROCEED WITH THE WORK DESCRIBED. FAILURE TO COMPLETE A WORK ORDER IN THE SPECIFIED TIME SHALL CONSTITUTE "FAILURE TO PURSUE THE WORK" AND SUBJECTS THE CONTRACTOR TO LIQUIDATED DAMAGES AS OUTLINED IN SUBSECTION 108. 9 OF THE STANDARD SPECIFICATIONS BASED ON THE TOTAL VALUE OF THAT PARTICULAR WORK ORDER.

GENERAL CONTRACT PLAN NOTES

UPON ISSUANCE OF EACH WORK ORDER, THE CONTRACTOR SHALL SUBMIT THE REQUIRED COPIES OF A DETAILED PROGRESS SCHEDULE AS OUTLINED IN STANDARD SPECIFICATION 108.4 WITHIN 5 CALENDAR DAYS OF THE ISSUANCE OF WORK ORDER. DURING THE CONTRACT, THE CONTRACTOR SHALL SUBMIT TWO-WEEK (OR AS REQUIRED) "LOOK AHEAD" SCHEDULES TO THE AREA ENGINEER NO LATER THAN NOON OF EACH THURSDAY. DETAILS SHALL INCLUDE A DESCRIPTION OF EACH WORK ACTIVITY, THE PLANNED DAYS OF WORK, MULTIPLE CREWS OR SHIFTS, AND SCHEDULED WORKING HOURS. FAILURE TO COMPLY WILL RESULT IN A SUSPENSION OF ALL CONTRACT WORK WITH TIME CHARGES CONTINUING TO BE ASSESSED. THE PROGRESS SCHEDULE MUST ALSO BE UPDATED AND SUBMITTED TO THE DEPARTMENT AS CHANGES OR DELAYS OCCUR IN THE CONTRACT.

SECTION 400

9. THE COST OF CLIPPING BACK THE EDGES OF THE ROADWAY, SHOULDERS, AND THE FIRST 3' OF UNPAVED DRIVEWAY ENTRANCES, PICKING UP AND DISPOSING OF WASTE AND EXCESS MATERIAL, AND CLEANING THE EXISTING PAVEMENT PRIOR TO AN OVERLAY SHALL BE INCIDENTAL TO SECTION 401(). PREPARING UNPAVED DRIVEWAY ENTRANCES BEYOND THE FIRST 3' SHALL BE PAID UNDER THE APPROPRIATE CONTRACT ITEMS: 202000 AND/OR 30100X. UNLESS SPECIFIED, OVERLAY WIDTHS SHALL MATCH EXISTING WIDTHS.

10. PAVING IS TO BE COMPLETED CURB TO CURB INCLUDING TURN LANES AND INTERSECTIONS WITHIN SEVEN (7) CALENDER DAYS OF PAVEMENT MILLING FOR A PARTICULAR DAYS PAVEMENT MILLING LOCATION. THIS RESTRICTION APPLIES TO EACH DAYS PAVEMENT MILLING OPERATION, NOT AN ENTIRE PROJECT LOCATION. FAILURE TO COMPLY WILL RESULT IN A SUSPENSION OF ALL OTHER CONTRACT WORK WITH TIME CHARGES CONTINUING TO BE ASSESSED.

11. IN ADDITION TO ITEM 401506 SPEED HUMP BEING UTILIZED FOR NEW SPEED HUMPS, IT SHALL ALSO INCLUDE REMOVE AND REPLACE SPEED HUMPS. AT REMOVE AND REPLACE LOCATIONS, 401506 SHALL BE PAID AND THE REMOVAL SHALL BE INCIDENTAL TO THIS ITEM. SPEED HUMPS REMOVED AS PART OF THE MILLING/PAVING OPERATION, SCHEDULED TO BE PUT BACK, SHALL BE REPLACED WITHIN SEVEN (7) DAYS OF COMPLETION OF PAVING. FAILURE TO COMPLY WILL RESULT IN A SUSPENSION OF ALL OTHER CONTRACT WORK WITH TIME CHARGES CONTINUING TO BE ASSESSED. PAYMENT FOR THIS ITEM SHALL INCLUDE PERMANENT STRIPING AND DELINEATOR POSTS. IF PERMANENT STRIPING CANNOT BE PLACED THE SAME DAY AS THE SPEED HUMP PLACEMENT, TEMPORARY STRIPING SHALL BE APPLIED THE SAME DAY.

GENERAL CONTRACT PLAN NOTES

12. PAVING WILL INCLUDE INTERSECTING STREETS FROM P.C. TO P.C.: MILLING AND PAVING OF INTERSECTING STREETS WILL NOT BE CONSIDERED FOR ENTRANCE, DRIVEWAY AND INTERSECTING STREET PAVEMENT SURCHARGE, NOR WILL DRIVEWAYS AND ENTRANCES WITHIN RIGHT-OF-WAY.

13. FOR BITUMINOUS CONCRETE PATCH:

- FOR DRIVEWAY APRONS (BEHIND CURB) PLACE 2 LIFTS OF 2" BITUMINOUS CONCRETE TYPE C.
- FOR FINISHED PATCHES IN FRONT OF CURB, PLACE 2 LIFTS OF 2" BITUMINOUS CONCRETE TYPE C.
- FOR TEMPORARY PATCHES IN FRONT OF CURB, PLACE 2 LIFTS OF 2" OF BITUMINOUS CONCRETE TYPE B OR TYPE C. REGARDLESS OF MATERIAL USED, PAYMENT WILL BE MADE UNDER ITEM 401029.
- THE ENGINEER MAY CHANGE TYPE OF BITUMINOUS CONCRETE AND DEPTHS AT THEIR DISCRETION.

SECTION 500

14. ITEM 501001 PCC PAVEMENT, 8" IS DESIGNATED FOR NOW-DEFUNCT ITEM 701004 PCC VALLEY GUTTER-8". WHEN REPLACING VALLEY GUTTERS, PLEASE REFER TO CONTRACT PLAN DETAILS. DOWEL BARS, WIRE MESH REINFORCEMENT, BITUMINUOUS SEAL, AND EXPANSION, PCC SAWCUTS, AND GABC UNDER THE PCC ARE INCIDENTAL TO VALLEY GUTTER ITEM (501001).

SECTION 600

15. DRAINAGE INLET GRATES ADJACENT TO THE ROAD, WITHIN THE PROJECT LIMITS, WHICH ARE NOT TYPE 1 SHALL BE REPLACED WITHIN 7 DAYS OF PAVING. THE NEED FOR ANY GRATE MODIFICATIONS OR FOR NEW FRAMES SHALL BE DETERMINED BY THE ENGINEER. ALL REPLACED GRATES/ FRAMES SHALL BE DELIVERED TO THE CANAL DISTRICT MAINTENANCE YARD, OR AS DIRECTED WITH THE COST OF DELIVERY INCIDENTAL TO 602100/602101 REPLACING DRAINAGE INLETS GRATES/FRAMES. FINAL PAYMENT FOR REPLACED GRATES/ FRAMES SHALL NOT BE MADE UNTIL RECEIPT OF DELIVERED MATERIALS IS PRODUCED, SIGNED BY A DELDOT MAINTENANCE YARD SUPERVISOR.

WHEN ENCOUNTERING DELDOT STORMWATER MANHOLES WITHIN LIMITS OF PAVING, THOSE MANHOLES WILL BE ADJUSTED AND UPDATED AT THE DISCRETION OF THE ENGINEER. ITEMS 602102/602103 SHALL BE FULL COMPENSATION (FURNISH AND INSTALLING) THE NEW LIDS AND FRAMES.

GENERAL CONTRACT PLAN NOTES

WHEN ENCOUNTERING NEW CASTLE COUNTY SANITARY MANHOLES WITHIN THE LIMITS OF PAVING, THOSE MANHOLES WILL BE ADJUSTED AND UPDATED AT THE DISCRETION OF THE ENGINEER. THE LIDS AND FRAMES ARE PROVIDED BY NEW CASTLE COUNTY AT NO COST TO THE CONTRACTOR. OBTAINING, STORING, DELIVERING, AND PLACING THESE NEW LIDS AND FRAMES SHALL BE INCIDENTAL TO THE ADJUSTMENT ITEM 602132.

SECTION 700

16. BUTT JOINTS SHALL BE CONSTRUCTED AT ALL INTERSECTING BITUMINOUS CONCRETE ROADS AND ANY OTHER LOCATIONS AS DIRECTED BY THE ENGINEER. BUTT JOINTS AT RAILROAD CROSSINGS AND AT BRIDGE OR DRAINAGE STRUCTURES NOT TO BE RESURFACED SHALL BE AS PER THE INCLUDED PLAN DETAIL. BUTT JOINTS CUT PRIOR TO THE DAY OF PAVEMENT OVERLAY SHALL BE RAMPED WITH BITUMINOUS CONCRETE TRM INCIDENTAL TO THE ITEM 762004 BUTT JOINT. ONLY BITUMINOUS CONCRETE WILL BE ALLOWED FOR THIS PURPOSE. BUTT JOINTS IN FULL MILL AREAS SHALL BE INCIDENTAL TO THE PAVEMENT MILLING ITEM (760010). SAWCUTS FOR BUTT JOINTS SHALL BE INCIDENTAL TO THE BUTT JOINT ITEM. ALL BITUMINOUS CONCRETE TRM SHALL BE REMOVED PRIOR TO THE PAVING OPERATION.

17. THE USE OF MILLINGS AND GABC IN THE TRAVEL WAY, TEMPORARY TRAVEL WAY, HIGH VOLUME ENTRANCES AND ACCESS RAMP FOR THE PURPOSE OF PROVIDING A TEMPORARY ROADWAY SURFACE, POTHOLE REPAIR, TAPERED EDGE FOR UTILITIES, BUTT JOINTS, AND LONGITUDINAL DROP-OFFS (MILLING AND PAVING OPERATIONS) IS PROHIBITED UNLESS IT IS OTHERWISE DESIGNATED TO BE USED IN THE CONTRACT PLANS. USE COLD PATCH, BITUMINOUS CONCRETE, BITUMINOUS CONCRETE WEDGE, OR TAPER MILL, AS NOTED IN THE CONTRACT DOCUMENTS OR APPROVED BY THE ENGINEER. PAYMENT FOR COLD PATCH, BITUMINOUS CONCRETE, OR BITUMINOUS CONCRETE WEDGE SHALL BE INCIDENTAL TO THE BITUMINOUS CONCRETE MILLING ITEM.

MILLINGS OR GABC SHALL BE USED AT THE FOLLOWING LOCATIONS WHERE ACCESS TO A BUSINESS RESIDENCE, OR EDGE DROP OFF NEEDS TO BE MAINTAINED UNLESS OTHERWISE NOTED IN THE PLANS OR DIRECTED BY THE ENGINEER TO USE BITUMINOUS CONCRETE OR COLD PATCH. ALL MILLING AND GABC WILL BE ROLLED AND COMPACTED TO HELP PREVENT THE MATERIAL FROM UNRAVELING.

- A. DRIVEWAYS
- B. ENTRANCES
- C. LOW VOLUME ACCESS RAMPS (IDENTIFIED IN THE CONTRACT DOCUMENTS)

GENERAL CONTRACT PLAN NOTES

- D. EDGE DROP-OFFS ADJACENT TO LIVE ROADWAY (LANE, SHOULDER, OR TURN LANE) AND THE PROPOSED ROAD CONSTRUCTION
- E. EDGE OF ROADWAY DROP-OFF

GRADING AND MAINTAINING BASE COURSE THAT IS BEING USED FOR ROADWAY WEDGE/FILLET BETWEEN TRAVEL LANES AND PAVEMENT BOX, EDGE OF TRAVEL WAY, DRIVEWAY OR ENTRANCE ACCESS SHALL BE INCIDENTAL TO ITEM NO. 801000 - MAINTENANCE OF TRAFFIC. THE BASE COURSE MATERIAL SHALL BE PLACED AT NO GREATER THAN THE SLOPE SPECIFIED IN TABLE 6G-1 AND SHALL BE COMPACTED. EXCESS BASE COURSE MATERIAL SHALL BE PUSHED AHEAD AND USED IN THE NEXT SEGMENT AND SHALL BE INCIDENTAL TO THE PARTICULAR BASE COURSE PAY ITEM. NO SEPARATE PAYMENT SHALL BE MADE FOR MILLINGS OR GABC TEMPORARY ROADWAY MATERIAL (TRM) USED TO PROTECT EDGE DROP-OFFS, UNLESS THE MATERIAL IS EVENTUALLY UTILIZED AS PART OF A PERMANENT ROADWAY AT WHICH TIME THE MATERIAL WOULD BE PAID FOR UNDER THE RESPECTIVE CONTRACT MATERIAL ITEM. VERTICAL DIFFERENCES SHALL BE CORRECTED IN ACCORDANCE WITH TABLE 6G-1 OF THE DELAWARE MUTCD.

18. MILLED MATERIAL, SHALL BECOME THE PROPERTY OF THE CONTRACTOR.

19. AFTER PAVEMENT MILLING, ALL RAISED EDGES OF MANHOLES, DRAINAGE INLETS, WATER VALVE BOXES, ETC. SHALL BE RAMPED WITH BITUMINOUS CONCRETE TRM AT A 20:1 OR FLATTER SLOPE INCIDENTAL TO PAVEMENT MILLING. PAVEMENT MILLINGS OR COLD PATCH MATERIAL WILL NOT BE ALLOWED FOR THIS PURPOSE. ALL ADJUSTMENTS SHALL BE MADE NOT MORE THAN SEVEN (7) CALENDAR DAYS PRIOR TO THE PLACEMENT OF THE FINAL COURSE OF BITUMINOUS CONCRETE, UNLESS DIRECTED BY THE ENGINEER. FAILURE TO COMPLY WILL RESULT IN A SUSPENSION OF ALL OTHER CONTRACT WORK WITH TIME CHARGES CONTINUING TO BE ASSESSED. ALL BITUMINOUS CONCRETE TRM SHALL BE REMOVED PRIOR TO THE PAVING OPERATIONS. IF THE CONTRACTOR ELECTS TO ADJUST MANHOLES, DRAINAGE INLETS AND WATER VALVES AFTER THE FINAL COURSE OF PAVING, THIS WORK MUST BE COMPLETED WITHIN SEVEN (7) CALENDAR DAYS OF THE FINAL COURSE OF BITUMINOUS CONCRETE. FAILURE TO COMPLY WILL RESULT IN A SUSPENSION OF ALL OTHER CONTRACT WORK WITH TIME CHARGES CONTINUING TO BE ASSESSED

20. THE CONTRACTOR SHALL TAKE CARE IN REMOVING PAVEMENT AROUND UTILITIES, BUTT JOINTS, CURB EDGES, ETC., WHEN CLEANING AFTER A PAVEMENT MILLING OPERATION. CARE SHOULD BE TAKEN SO AS NOT TO GOUGE OR DIG DEEPER THAN THE REQUIRED DEPTH. FAILURE TO DO SO WILL RESULT IN THE CONTRACTOR PLACING LEVELING COURSES AT THE CONTRACTOR'S EXPENSE.

DEPARTMENT OF TRANSPORTATION

**CONTRACT NUMBER- T202404901 CANAL
SUBDIVISION PAVING, NORTH I, 2024**

(CAD) PAGE 15 OF 47

GENERAL CONTRACT PLAN NOTES

21. TAPER MILLING IS INTENDED FOR MILLING IN THE AREA OF FIXED STRUCTURES (I.E. CURBS, MANHOLES, ETC.) THE MILLED DEPTH AT THE STRUCTURE SHALL BE THE DEPTH OF THE PROPOSED OVERLAY AND 0" AT A DISTANCE OF +/- 6 ½ FEET FROM THE STRUCTURE. THE COMPUTED DEPTH FOR PAYMENT PURPOSES IS THE AVERAGE OF THE TWO DEPTHS.

22. ON THIS CONTRACT FULL MILL AREAS WILL UTILIZE ITEM 760010 PAVEMENT MILLING, BITUMINUOUS CONCRETE PAVEMENT (SY-IN). UNLESS OTHERWISE NOTED, ALL MILLING LOCATIONS ARE EXPECTED TO BE MILLED AT A 2" DEPTH. FOR AVERAGE MILLING DEPTHS OF 0.5" TO AN AVERAGE MILLING DEPTH OF 2.25", THE FULL MILL AREAS WILL BE PAID AT AN AVERAGE 2".

23. MILLING OF BITUMINOUS PAVEMENT IN PREPARTION FOR OVERLAY IS TO INCLUDE MILLING EXISTING CONCRETE PATCHES AND/OR COMPOSITE PAVING AND SHOULD BE CONSIDERED INCIDENTAL TO ITEM 760010, PAVEMENT MILLING, BITUMINOUS CONCRETE PAVEMENT.

24. AT LOCATIONS THAT HAVE PCC REPLACEMENT, PAVING MUST BE COMPLETED WITHIN 90 CALENDAR DAYS FROM THE START OF THE PCC REPLACEMENT. BETWEEN OCTOBER 15TH AND NOVEMBER 30TH, PAVING MUST BE COMPLETED WITHIN 30 CALENDAR DAYS FROM THE START OF THE PCC REPLACEMENT. FAILURE TO COMPLY WILL RESULT IN A SUSPENSION OF ALL OTHER CONTRACT WORK WITH TIME CHARGES CONTINUING TO BE ASSESSED.

25. UPRIGHT PCC CURB UTILIZED FOR GRADE RETENTION 8" OR HIGHER WILL BE PAID AS 701013, TYPE 1-8 CURB.

26. EXCAVATION UP TO 2' IN FRONT OF CURB, ADA FACILITIES, AND DRAINAGE INLETS WILL BE INCIDENTAL TO ITEM 701XXX. HOT MIX PLACED IN FRONT OF CURB WILL BE PAID UNDER ITEM 401XXX. USE OF CONCRETE AS FILL IN FRONT OF CURB WILL NOT BE ACCEPTED. AT EACH LOCATION, BACKFILLING SHALL BE PERFORMED IMMEDIATELY UPON REMOVAL OF FORMS FOR CURB OR SIDEWALK. TOPSOIL, SEEDING, SEALING OF VALLEY GUTTERS, REMOVING OF FORMS, AND PARGING OF CATCH BASINS, SHALL BE COMPLETED WITHIN SEVEN (7) CALENDAR DAYS OF COMPLETION OF THE ITEM OF WORK. ITEM 908001, TOPSOIL, SHALL BE USED AS BACKFILL MATERIAL BEHIND CURB AND AROUND SIDEWALK OR/AS DIRECTED BY THE ENGINEER. TOPSOIL SHALL BE SCREENED/SIFTED SO AS NO MATERIAL GREATER THAN .5" SHOULD BE PRESENT IN MATERIAL USED FOR BACKFILL. EXCAVATED MATERIAL, NOT NEEDED ON THE PROJECT, SHALL BE REMOVED FROM THE CONTRACT AT THE CONTRACTORS EXPENSE. FAILURE TO COMPLY WILL RESULT IN A SUSPENSION OF ALL OTHER CONTRACT WORK WITH THE CHARGES CONTINUING TO BE ASSESSED.

27. AS DIRECTED BY THE ENGINEER, THE CONTRACTOR SHALL PARTIALLY SAW AND FILL EXISTING CRACKED CURB AND/OR SIDEWALK WITH AN APPROVED SEALER. THIS WORK WILL BE INCIDENTAL TO ITEM 762001 SAWCUT - CONCRETE FULL DEPTH.

DEPARTMENT OF TRANSPORTATION

**CONTRACT NUMBER- T202404901 CANAL
SUBDIVISION PAVING, NORTH I, 2024**

(CAD) PAGE 16 OF 47

GENERAL CONTRACT PLAN NOTES

28. PERTAINING TO PCC CURB REMOVAL & PATCHING, SAWCUTTING IS TO BE PERFORMED PRIOR TO THE REMOVAL OF BITUMINOUS CONCRETE UNLESS APPROVAL IS GIVEN BY THE ENGINEERS REPRESENTATIVE.

29. BEFORE THE START OF A DAY'S PAVEMENT MILLING OR PAVING OPERATIONS AND WHERE THERE IS EXISTING STRIPING, THE CONTRACTOR SHALL BE REQUIRED TO PROVIDE PROOF THAT ENOUGH MATERIAL OF AN APPROVED ALTERNATIVE STRIPING METHOD IS ON HAND AT THE SITE TO ENSURE STRIPING IS COMPLETE BEFORE TRAFFIC IS RETURNED TO THE ROADWAY.

30. LANE CLOSURES ON 3-DIGIT MAINTENANCE ROADS ARE PERMITTED ONLY BETWEEN THE HOURS OF 9:00 AM AND 3:00 PM. ANY VARIANCE SHALL REQUIRE DISTRICT SAFETY OFFICERS APPROVAL.

31. ITEM 710370 STEEL CASING PIPE-4" IS DESIGNATED FOR NOW-DEFUNCT ITEM 718000 ROOF DRAIN. WHEN REPLACING OR EXTENDING ROOF DRAINS, SUMP PUMP DRAINS, ETC. FROM RIGHT-OF-WAY TO CURBLINE, ITEM 710370 WILL BE UTILIZED REGARDLESS OF PIPE MATERIAL OR SIZE.

32. GAS VALVE, MONUMENT BOX, AND LAMPHOLE ADJUSTMENTS WILL BE PAID AS 710002, WATER VALVE ADJUSTMENTS.

33. REMOVAL OF ANY UNSUITABLE MATERIALS INCLUDING ROOTS AND VEGETATIVE MATTER DISCOVERED WITHIN OR DIRECTLY BELOW THE TEMPLATE OF PCC / GRANITE CURB, PEDESTRIAN FACILITIES, AND/OR PCC / BRICK SIDEWALKS SHALL BE INCIDENTAL TO THE CORRESPONDING ITEM.

34. TRASH, RUBBISH, DEBRIS, OR BRUSH THAT HAMPERS REPAIR/MAINTENANCE WORK IN THIS CONTRACT (AS DETERMINED BY THE ENGINEER), SHALL BE REMOVED WITHIN THE PROJECT LIMITS AND SHALL BE INCIDENTAL TO PAY ITEM 763000 (INITIAL EXPENSE/DEMOBILIZATION).

35. CLEARING AND GRUBBING OF TREES, SHRUBS AND OTHER VEGETATION LESS THAN 6" IN DIAMETER SHALL BE INCIDENTAL TO ITEM 763000 (INITIAL EXPENSE/DEMOBILIZATION).

36. GRASS AND SOIL AREAS WITHIN THE STATE RIGHT-OF-WAY AND ADJACENT PRIVATE PROPERTY THAT HAS BEEN DAMAGED DURING CONTRACT OPERATIONS SHALL BE RESTORED WITH TOPSOIL, SEED AND MULCH AT THE CONTRACTOR'S EXPENSE. WORK SHALL BE EXECUTED IN ACCORDANCE WITH THE REQUIREMENTS FOR ITEM 908001 (TOPSOIL), ITEM 908016 (PERMANENT GRASS SEEDING SUBDIVISION), AND ITEM 908020 (EROSION CONTROL BLANKET MULCH). REPAIRS MUST BE COMPLETED WITHIN SEVEN (7) CALENDAR DAYS OF NOTIFICATION. FAILURE TO COMPLY WILL RESULT IN A SUSPENSION OF ALL OTHER CONTRACT WORK WITH TIME CHARGES CONTINUING TO BE ASSESSED.

GENERAL CONTRACT PLAN NOTES

SECTION 800

37. LOCATIONS OF VARIABLE MESSAGE BOARDS AND MESSAGES DISPLAYED, ON 3-DIGIT MAINTENANCE ROADS, SHALL BE REVIEWED AND APPROVED BY THE DISTRICT SAFETY OFFICER.

38. AT EACH LOCATION, THE CONTRACTOR SHALL NOTE ALL EXISTING PAVEMENT MARKINGS AND SUBMIT A DRAWING WHICH DEPICTS THE STRIPING PATTERN TO THE DEPARTMENT PRIOR TO THE START OF ANY WORK AT THE LOCATION.

THE CONTRACTOR WILL BE RESPONSIBLE TO CORRECT ANY ERRONEOUS MARKINGS IMMEDIATELY. FAILURE TO COMPLY WILL RESULT IN SUSPENSION OF ALL OTHER CONTRACT WORK WITH TIME CHARGES CONTINUING TO BE ASSESSED. FINAL PAVEMENT MARKINGS SHALL CONFORM TO ALL EXISTING PATTERNS AND SHALL BE PLACED WITHIN FIVE (5) CALENDER DAYS (MAXIMUM) AFTER PLACEMENT OF THE FINAL COURSE OF BITUMINOUS CONCRETE. IF THE CONTRACTOR FAILS TO DOCUMENT THE EXISTING PAVEMENT MARKINGS IN AN ACCEPTABLE MANNER, HE SHALL BE REQUIRED TO PROVIDE AT HIS OWN EXPENSE, A NEW PAVEMENT MARKING PLAN SIGNED AND SEALED BY A PROFESSIONAL ENGINEER REGISTERED IN THE STATE OF DELAWARE.

AT THE END OF EACH DAY'S OPERATION AND BEFORE TRAFFIC IS RETURNED TO UNRESTRICTED ROADWAY USE, TEMPORARY MARKINGS SHALL BE UTILIZED AT LOCATIONS THAT REQUIRE PERMANENT MARKING.

TEMPORARY PAVEMENT STRIPING MUST MATCH PERMANENT PAVEMENT STRIPING IN ALL REGARDS.

TEMPORARY PAVEMENT MARKINGS SHALL BE PAID AT THE APPLICABLE CONTRACT UNIT PRICE. THE CONTRACTOR IS RESPONSIBLE FOR MAINTAINING THE TEMPORARY MARKINGS IN GOOD CONDITION SUCH THAT THE PAVEMENT IS PROPERLY DELINEATED AT ALL TIMES. ANY REFRESHING OF THE TEMPORARY MARKINGS WILL BE AT THE CONTRACTOR'S EXPENSE.

DEPARTMENT OF TRANSPORTATION

**CONTRACT NUMBER- T202404901 CANAL
SUBDIVISION PAVING, NORTH I, 2024**

(CAD) PAGE 18 OF 47

GENERAL CONTRACT PLAN NOTES

PLACEMENT OF TEMPORARY MARKINGS SHALL RECEIVE PRIOR APPROVAL FROM THE ENGINEER. PAYMENT FOR TEMPORARY PAVEMENT MARKING SHALL BE MADE AT THE UNIT PRICE BID FOR ITEM 817003 - TEMPORARY MARKINGS.

39. THE CONTRACTOR, WITH THE ENGINEER, SHALL INVENTORY ALL SIGNS ON ALL ROADS SUBJECT TO IMPROVEMENTS. NECESSARY SIGNS SHALL BE MAINTAINED IN OPERATION DURING CONSTRUCTION AND ANY OTHER SIGNS SHALL BE PROPERLY STORED WITH THE CONTRACTOR, WHO SHALL BE RESPONSIBLE FOR LOSS OR DAMAGE. IMMEDIATELY PRIOR TO FINAL INSPECTION, THE CONTRACTOR AND ENGINEER SHALL AGAIN INVENTORY THE TRAFFIC SIGNS AND ACCOUNT FOR ANY LOST OR DAMAGED SIGNS. LOST OR DAMAGED SIGNS, AT THE DISCRETION OF THE ENGINEER SHALL BE REPLACED IN KIND AT THE CONTRACTOR'S EXPENSE.

40. REGULATORY SIGNS REMOVED MUST BE REINSTALLED THE SAME DAY. IN ABSENCE OF A SIGN SCHEDULE, INSTALLATION OR REMOVAL OF TRAFFIC SIGN(S) AND SIGN POST(S) WILL BE PAID AS 819018. THIS ITEM WILL BE PAID ONE TIME PER POST AFTER FINAL INSTALLATION.

41. A FORMAL DETOUR WILL NOT BE NECESSARY ON THIS CONTRACT. THE CONTRACTOR MUST MAINTAIN LOCAL TRAFFIC WITHIN THE PROJECT LIMITS UTILIZING FLAGGERS. MAINTENANCE OF TRAFFIC DURING LANE CLOSURES AND/OR LANE SHIFTS SHALL CONFORM TO TYPICAL APPLICATIONS OF THE DELAWARE MUTCD. ANY VARIANCE SHALL REQUIRE DISTRICT SAFETY OFFICERS APPROVAL.

42. BEFORE WORK IS DONE AT ANY LOCATION, THE APPROPRIATE DISTRICT SAFETY OFFICER MUST APPROVE THE MOT FOR THAT LOCATION TWO WEEKS IN ADVANCE. ANY ANTICIPATED IMPACT TO TRAFFIC SIGNALS MUST BE REVIEWED BY THE DELDOT TRAFFIC SECTION PRIOR TO CONSTRUCTION. THEY CAN BE CONTACTED AT 302-659-4061.

43. ANY ERRONEOUS MARKING WILL NOT BE PAID FOR AND SHALL BE CORRECTED IMMEDIATELY AT THE CONTRACTOR'S EXPENSE. ERRONEOUS MARKINGS OR SHADOWS THAT EXCEED ONE (1) INCH IN WIDTH SHALL BE REMOVED BY EITHER SAND OR WATER BLASTING. NO OTHER REMOVAL METHODS WILL BE ALLOWED.

44. THE CONTRACTOR SHALL SUBMIT A TRAFFIC CONTROL PLAN, INCLUDING PEDESTRIAN AND BICYCLE FACILITIES, AS WELL AS THE NECESSARY NCHRP 350, THE MANUAL FOR ASSESSING SAFETY HARDWARE (MASH) CERTIFICATIONS, OR DELDOTS APPROVED PRODUCTS LIST (APL) FOR ALL DEVICES THAT WILL BE UTILIZED, FOR EACH LOCATION BEFORE THE START OF THE PRE-CONSTRUCTION MEETING. WRITTEN APPROVAL MUST BE RECEIVED BEFORE THE START OF WORK AT EACH AND EVERY LOCATION.

GENERAL CONTRACT PLAN NOTES

45. ALL TRAFFIC CONTROL DEVICES SHALL BE IN NEW OR REFURBISHED CONDITION AND SHALL BE IN COMPLIANCE WITH THE NCHRP 350, THE MANUAL FOR ASSESSING SAFETY HARDWARE (MASH) CERTIFICATIONS, OR DELDOTS APPROVED PRODUCTS LIST (APL). THE DEVICES SHALL BE APPROVED BY THE SAFETY SECTION PRIOR TO USE AND SHALL BE MAINTAINED IN GOOD CONDITION FOR THE DURATION OF THE CONTRACT.

46. ALL WORK SHALL BE PERFORMED IN A MANNER THAT WILL REASONABLY PROVIDE THE LEAST PRACTICABLE OBSTRUCTION TO ALL ROAD USERS, INCLUDING VEHICULAR, PEDESTRIAN AND BICYCLE TRAFFIC, AND SHALL CONFORM TO THE REQUIREMENTS OF THE 2011 DELAWARE MANUAL ON UNIFORM TRAFFIC CONTROL DEVICES, PART 6, INCLUDING ALL REVISIONS UP TO THE DATE OF ADVERTISEMENT FOR BIDS.

47. PEDESTRIAN MAINTENANCE OF TRAFFIC: THIS WORK SHALL CONSIST OF PROVIDING AND MAINTAINING AN ACCESSIBLE PEDESTRIAN ROUTE THROUGHOUT THE PROJECT'S LIMITS IN ACCORDANCE WITH THE AMERICANS WITH DISABILITIES ACT OF 1990 (ADA) TITLE II, PARAGRAPH 35.130. THE CONTRACTOR SHALL BE REQUIRED TO REVIEW EACH CURB RAMP LOCATION AND SUBMIT THE APPROPRIATE MAINTENANCE OF TRAFFIC DETAIL AND DEVICES TO THE ENGINEER FOR EACH LOCATION AT LEAST 2-WEEKS BEFORE CONSTRUCTION FOR REVIEW, COMMENT, AND APPROVAL. THE FOLLOWING CONSIDERATIONS SHALL BE TAKEN INTO ACCOUNT WHEN ADDRESSING ACCESSIBLE PEDESTRIAN MAINTENANCE OF TRAFFIC:

- ALL PEDESTRIANS, INCLUDING PERSONS WITH DISABILITIES, SHALL BE PROVIDED WITH A REASONABLY SAFE, CONVENIENT AND ACCESSIBLE PATH THAT REPLICATES AS MUCH AS PRACTICABLE THE EXISTING PEDESTRIAN FACILITIES.
- MAINTAIN ACCESS TO ALL BUSINESS AND RESIDENTS AT ALL TIMES.
- PROVIDE PEDESTRIAN ACCESS THRU OR AROUND THE WORK ZONE. IF A DETOUR IS CHOSEN THE CONTRACTOR MUST SUBMIT THE DETOUR ROUTE TO THE ENGINEER FOR REVIEW AND APPROVAL. THE DETOUR ROUTE MUST MEET OR EXCEED THE CURRENT CONDITIONS.
- WORK SHOULD BE PHASED SO THAT ALL AREAS OF AN INTERSECTION/SIDEWALK PATH ARE NOT UNDER CONSTRUCTION AT THE SAME TIME UNLESS A CLEAR PATH IS PROVIDED AND IDENTIFIED.

SECTION 900

48. EROSION CONTROL MULCH BLANKET SHALL BE USED IN ALL DISTURBED AREAS UNLESS DIRECTED OTHERWISE BY THE ENGINEER.

GENERAL CONTRACT PLAN NOTES

ADDITIONAL PROJECT NOTES

49. UNDERGROUND UTILITIES MAY BE PRESENT AT ALL LOCATIONS. THEREFORE, ALL STANDARD PRACTICES AND PROCEDURES REGARDING UTILITIES SHALL BE FOLLOWED. THE CONTRACTOR SHALL CONTACT MISS UTILITY OF DELAWARE PRIOR TO STARTING WORK. THE CONTRACTOR IS RESPONSIBLE FOR THE SUPPORT AND PROTECTION OF ALL UTILITIES WHEN EXCAVATING WHICH SHALL BE INCIDENTAL TO THE RESPECTIVE EXCAVATION ITEM(S). THE CONTRACTOR IS RESPONSIBLE FOR ENSURING PROPER CLEARANCES, INCLUDING SAFETY CLEARANCES, FROM OVERHEAD UTILITIES FOR CONSTRUCTION EQUIPMENT. THE CONTRACTOR IS ADVISED TO CHECK THE SITE FOR ACCESS PURPOSES FOR THEIR EQUIPMENT AND MAKE ARRANGEMENTS DIRECTLY WITH THE UTILITY COMPANIES FOR FIELD ADJUSTMENTS FOR ADEQUATE CLEARANCES, IF NECESSARY.

50. NO UTILITY RELOCATION INVOLVEMENT IS ANTICIPATED. SHOULD ANY CONFLICTS BE ENCOUNTERED DURING CONSTRUCTION REQUIRING ADJUSTMENT AND/OR RELOCATION OF THE AGENCIES' EXISTING FACILITIES, THE NECESSARY RELOCATION WORK SHALL BE ACCOMPLISHED BY THE RESPECTIVE AGENCIES' FORCES, AS DIRECTED BY THE DISTRICT ENGINEER. ANY ADJUSTMENTS AND/OR RELOCATIONS OF MUNICIPALLY OWNED FACILITIES SHALL BE DONE BY THE STATE'S CONTRACTOR IN ACCORDANCE WITH THE RESPECTIVE AGENCIES' STANDARD SPECIFICATIONS AS DIRECTED BY THE DISTRICT ENGINEER.

51. NO ENVIRONMENTAL PERMITS ARE REQUIRED FOR THIS WORK PROVIDED NO JURISDICTIONAL WETLANDS OR WATERS ARE IMPACTED. IF THERE IS ANY QUESTION AS TO WHETHER OR NOT A WATER OR WETLAND IS JURISDICTIONAL, CONTACT THE DEL DOT ENVIRONMENTAL SECTION AT 302-760-2264.

52. IT IS ANTICIPATED THAT ALL WORK WILL OCCUR WITHIN DELDOT'S EXISTING RIGHT OF WAY OR EASEMENT AREAS. SHOULD THE NEED OCCUR TO TRESPASS ONTO PRIVATE PROPERTY; IT WILL BE THE RESPONSIBILITY OF THE PROJECT MANAGER TO SECURE SUCH TRESPASS NEEDS.

53. NO WORK NEAR OR WITHIN RAILROAD RIGHT-OF-WAY IS ANTICIPATED. IF ANY RAILROAD PROPERTY OR FACILITIES ARE NEAR OR WITHIN THE PROPOSED LIMITS OF WORK OR IF THE PROPOSED WORK ENCROACHES UPON THE RAILROAD'S RIGHT-OF-WAY, THE CONTRACTOR SHALL BE RESPONSIBLE FOR OBTAINING THE REQUIRED CLEARANCES AND INSURANCES FOR EACH INVOLVED RAILROAD IN ACCORDANCE WITH THE APPROPRIATE DELDOT MAINTENANCE OF RAILROAD TRAFFIC ITEM. DELDOT'S RAILROAD SECTION MANAGER MUST BE CONTACTED AT (302) 760-2183 TO COORDINATE THE EXECUTION OF THE APPROPRIATE AGREEMENTS AND AUTHORIZATIONS REQUIRED FROM ANY RAILROAD COMPANY INVOLVED, INCLUDING COORDINATION FOR RAILROAD FLAGGING, IF NECESSARY.

DEPARTMENT OF TRANSPORTATION

**CONTRACT NUMBER- T202404901 CANAL
SUBDIVISION PAVING, NORTH I, 2024**

(CAD) PAGE 21 OF 47

GENERAL CONTRACT PLAN NOTES

54. THE PROJECT MANAGER SHALL BE RESPONSIBLE FOR COORDINATING WITH THE TRAFFIC SECTION RELATING TO ANY IMPACTS TO TRAFFIC SECTION FACILITIES (INCLUDING BUT NOT LIMITED TO TRAFFIC LOOPS, JUNCTION WELLS ETC.) AT LEAST 4 WEEKS IN ADVANCE OF THE START OF THE ACTIVITY. PRIOR TO INITIATING ANY WORK ON THIS CONTRACT (OR SITES), THE PROJECT MANAGER SHALL BE RESPONSIBLE FOR PREPARING AND SUBMITTING FOR APPROVAL OF THE SAFETY SECTION, A MAINTENANCE OF TRAFFIC PLAN. SUFFICIENT TIME SHALL BE PROVIDED FOR THE REVIEW AND APPROVAL OF THE PLAN. THE MAINTENANCE OF TRAFFIC PLAN SHALL INCLUDE PROPOSED TIME RESTRICTIONS ON THE CLOSURE OF TRAVEL LANES SUBJECT TO THE APPROVAL OF THE SAFETY SECTION. TRAFFIC LOOPS MUST BE PUT BACK WITHIN 7 DAYS OF PAVING, FAILURE TO COMPLY WILL RESULT IN A SUSPENSION OF ALL OTHER CONTRACT WORK WITH TIME CHARGES CONTINUING TO BE ASSESSED.

55. THE DEPARTMENT RESERVES THE RIGHT TO REQUEST AN EXTENSION OF THIS CONTRACT, WITH THE AGREEMENT OF THE CONTRACTOR, AT THE CURRENT CONTRACT PRICES.

November 2023

DELAWARE DEPARTMENT OF TRANSPORTATION

CONTRACT NUMBER- T202404901

(CAD) PAGE 22 OF 47

CANAL

Contract is for various locations throughout New Castle County.

DETAILS SHEET

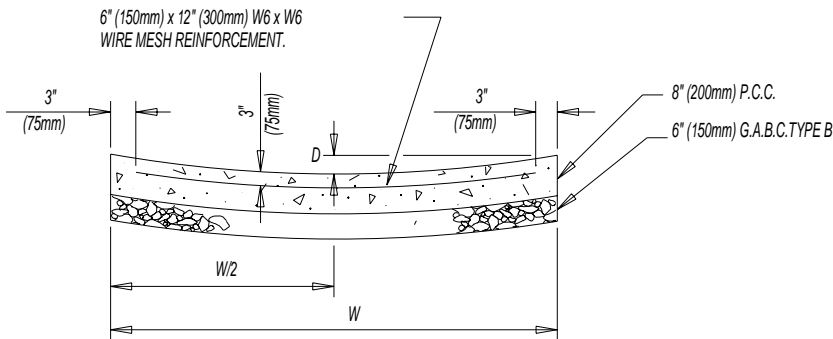
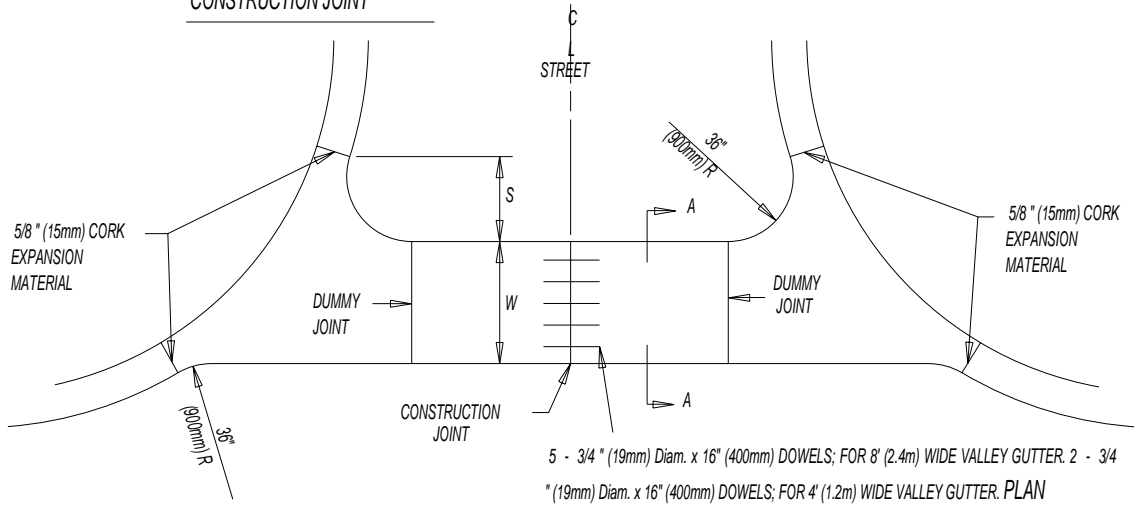
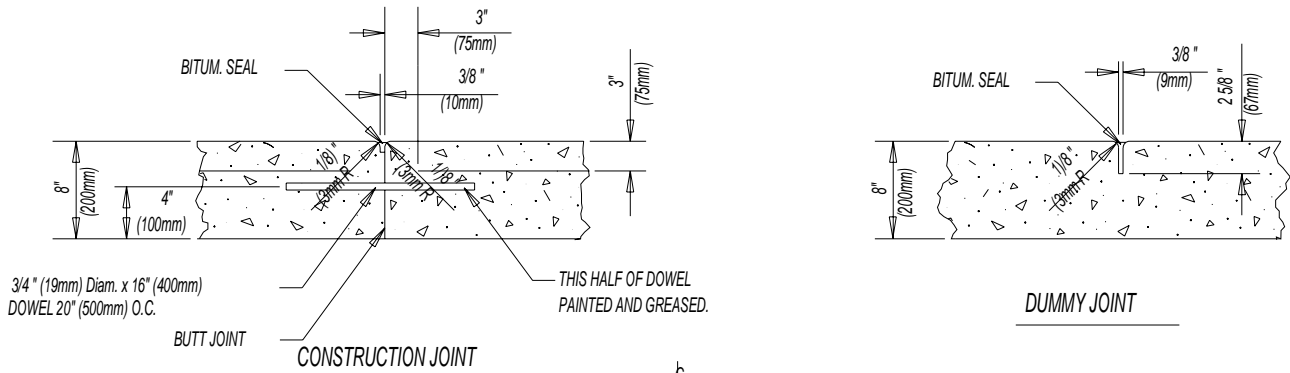

WIDTH W	DEPTH D	OFFSET S
8' (2.4m)	3" (75mm)	16" (405mm)
4' (1.2m)	1 1/2" (38mm)	23 1/2" (585mm)

P.C.C. VALLEY GUTTER

CANAL

Contract is for various locations throughout New Castle County.

DETAILS SHEET

SPEED HUMP

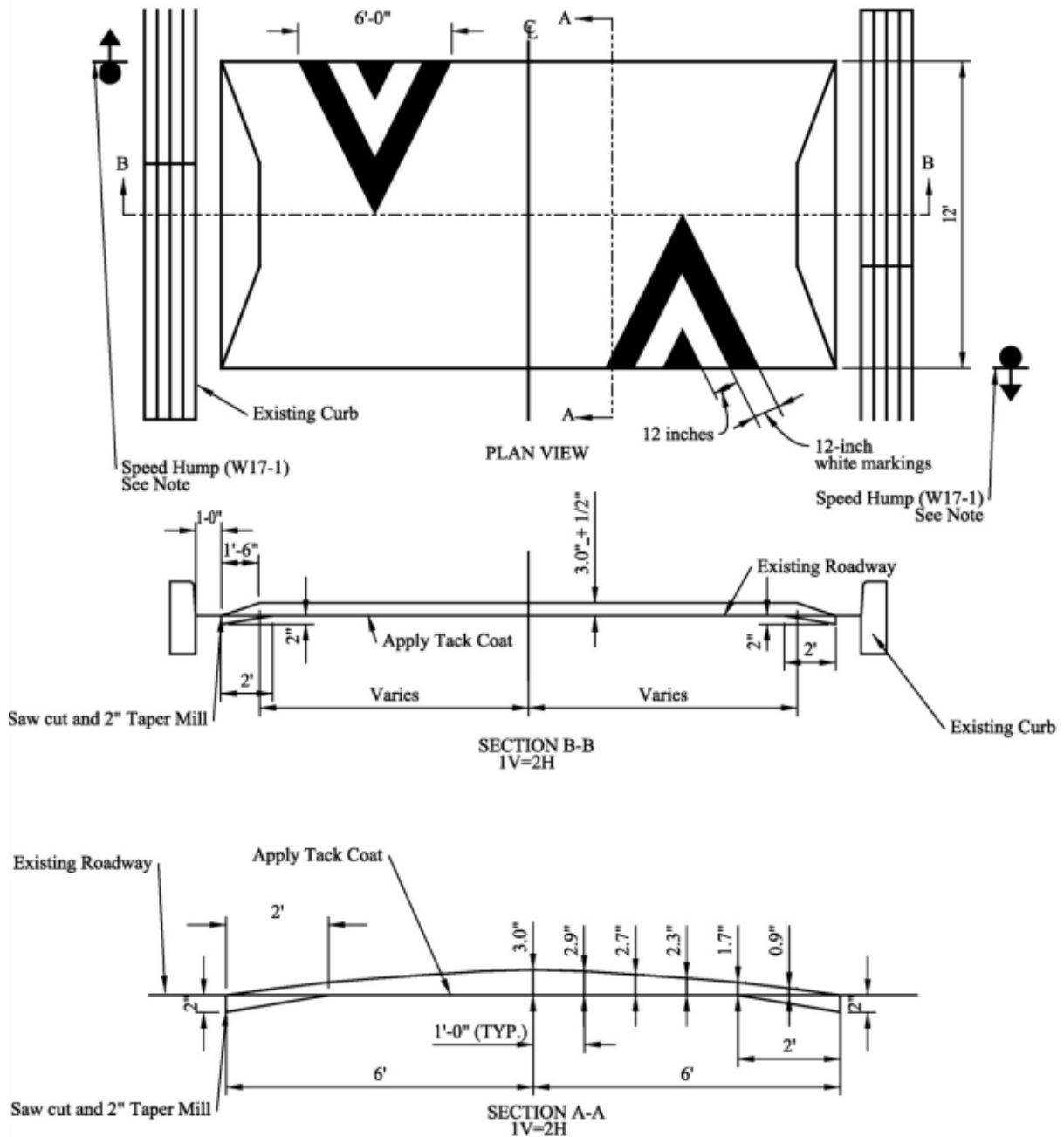

NOTE:
1. ALL SIGNING AND STRIPING SHALL CONFORM TO THE LATEST EDITION OF THE DE MUTCD.

CANAL

Contract is for various locations throughout New Castle County.

DETAILS SHEET

REMOVE AND DISPOSE OF EXISTING FRAME AND COVER AS DIRECTED BY OWNER IF NOT UTILIZED IN THE ADJUSTMENT.
PLACE NEW OR EXISTING FRAME AND COVER (AS REQUIRED).
TO CORRECT ELEVATION, RECOLLAR AND PLACE BITUMINOUS CONCRETE PATCH. NEW FRAME AND COVER (IF REQUIRED) TO BE PROVIDED BY OWNER.

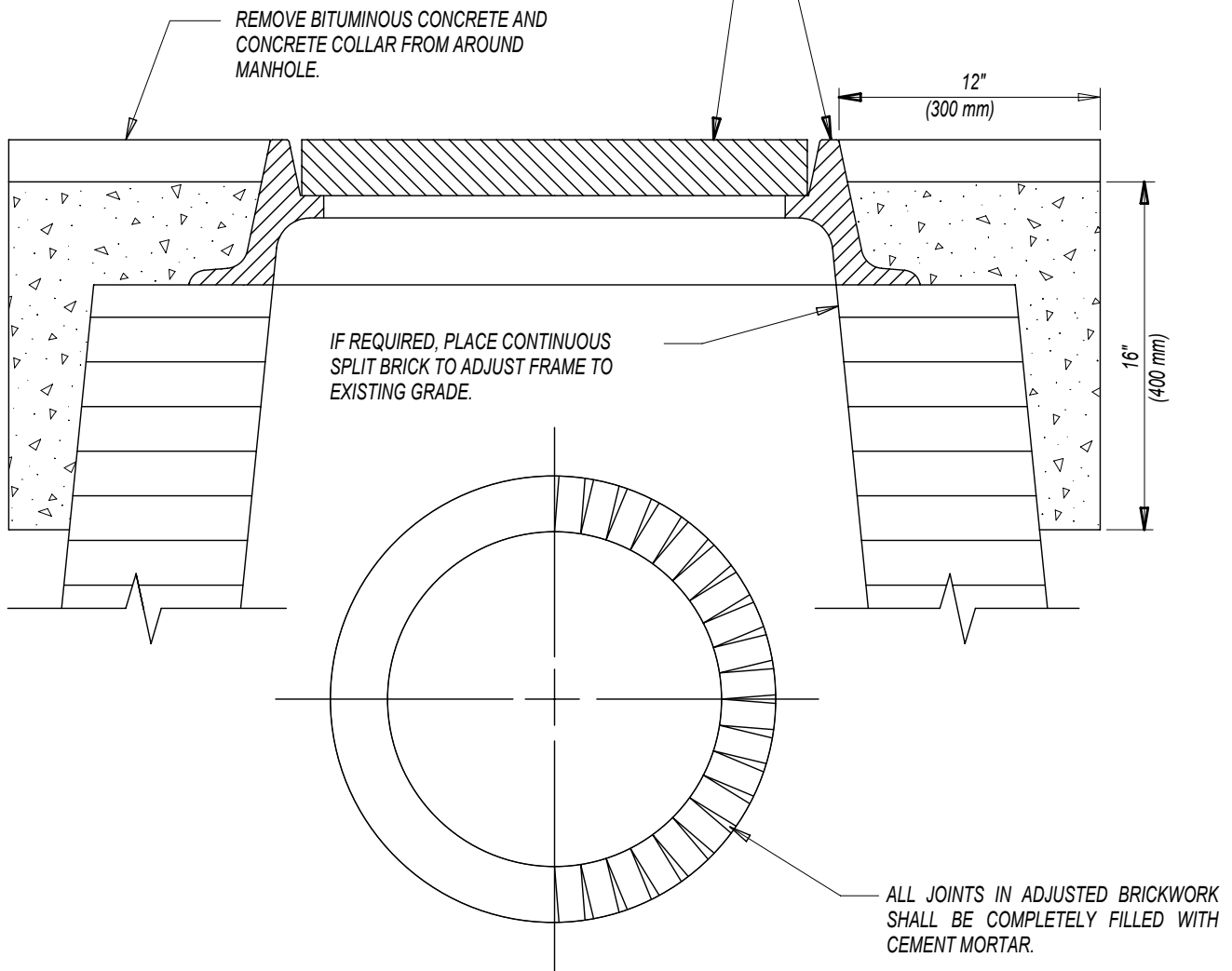

ADJUSTING AND REPAIRING MANHOLE

N.T.S.

NOTE: MANHOLES IN CONCRETE ROADWAYS SHALL BE SAWCUT FULL DEPTH TO THE SPECIFIED DIMENSION PRIOR TO ANY ADJUSTMENT BEING MADE. THE SAWCUTTING SHALL BE INCIDENTAL TO ITEM 602132.

DELAWARE DEPARTMENT OF TRANSPORTATION

CONTRACT T202404901

(CAD) PAGE 25 OF 47

CANAL

SUBDIVISION PAVING, NORTH I, 2024

LOCATION 1 BRANDON - ANDYS COURT FROM ANDY'S LANE TO END

LENGTH 92.9640 m 305.0000 L.F.

GENERAL IMPROVEMENTS

2" MILL AND OVERLAY (CURB WHERE NECESSARY)

COMMENTS:

2 RAMPS @ ANDYS LANE

MATERIAL ESTIMATE FOR LOCATION 1

211001	REMOVAL OF PORTLAND CEMENT CONCRETE PAVEMENT, CURB AND SIDEWALK	86.00	S.Y.
301001	GABC	8.00	C.Y.
301002	GABC, PATCHING	19.00	C.Y.
401005	SUPERPAVE TYPE C, PG 64-22 (CARBONATE STONE)	140.00	TON
401029	SUPERPAVE TYPE C, PG 64-22, PATCHING	14.00	TON
401030	SUPERPAVE TYPE B, PG 64-22, PATCHING	10.00	TON
402000	BITUMINOUS CONCRETE PATCHING	800.00	SY-IN
504001	CRACK AND JOINT SEALING LESS THAN 3/4 INCH WIDE	48.00	L.F.
602132	ADJUSTING AND REPAIRING EXISTING MANHOLE	1.00	EACH
701013	PCC CURB, TYPE 1-8	4.00	L.F.
701019	I.PCC CURB AND GUTTER, TYPE 2	240.00	L.F.
705001	PCC SIDEWALK, 4"	96.00	S.F.
705002	PCC SIDEWALK, 6"	192.00	S.F.
705007	DETECTABLE WARNING SURFACE	20.00	S.F.
705008	PEDESTRIAN CONNECTION, TYPE 1	60.00	S.F.
705009	PEDESTRIAN CONNECTION, TYPE 2, 3, AND/OR 4	400.00	S.F.
760010	PAVEMENT MILLING, BITUMINOUS CONCRETE PAVEMENT	1,100.00	SY-IN
760011	PAVEMENT MILLING, BITUMINOUS CONCRETE PAVEMENT, TAPER CUT	560.00	SY-IN
762000	SAW CUTTING, BITUMINOUS CONCRETE	360.00	L.F.
762001	SAW CUTTING, CONCRETE, FULL DEPTH	36.00	L.F.
811001	FLAGGER, NEW CASTLE COUNTY	98.00	HOUR
811013	FLAGGER, NEW CASTLE COUNTY, OVERTIME	10.00	HOUR
908001	TOPSOIL	18.00	TON
908016	PERMANENT GRASS SEEDING, SUBDIVISION	106.00	S.Y.
908020	EROSION CONTROL BLANKET MULCH	106.00	S.Y.

DELAWARE DEPARTMENT OF TRANSPORTATION

CONTRACT T202404901

(CAD) PAGE 26 OF 47

CANAL

SUBDIVISION PAVING, NORTH I, 2024

LOCATION 2 CAVAGRADO - MOCK DRIVE FROM CHINCHILLA DRIVE TO END

LENGTH 74.6760 m 245.0000 L.F.

GENERAL IMPROVEMENTS

2" MILL AND OVERLAY (CURB WHERE NECESSARY)

COMMENTS:

MATERIAL ESTIMATE FOR LOCATION 2

211001	REMOVAL OF PORTLAND CEMENT CONCRETE PAVEMENT, CURB AND SIDEWALK	148.00	S.Y.
301001	GABC	14.00	C.Y.
301002	GABC, PATCHING	33.00	C.Y.
401005	SUPERPAVE TYPE C, PG 64-22 (CARBONATE STONE)	125.00	TON
401029	SUPERPAVE TYPE C, PG 64-22, PATCHING	25.00	TON
401030	SUPERPAVE TYPE B, PG 64-22, PATCHING	15.00	TON
402000	BITUMINOUS CONCRETE PATCHING	1,350.00	SY-IN
504001	CRACK AND JOINT SEALING LESS THAN 3/4 INCH WIDE	41.00	L.F.
602131	ADJUSTING AND REPAIRING EXISTING DOUBLE DRAINAGE INLET	1.00	EACH
701019	I.PCC CURB AND GUTTER, TYPE 2	410.00	L.F.
705001	PCC SIDEWALK, 4"	164.00	S.F.
705002	PCC SIDEWALK, 6"	328.00	S.F.
760010	PAVEMENT MILLING, BITUMINOUS CONCRETE PAVEMENT	820.00	SY-IN
760011	PAVEMENT MILLING, BITUMINOUS CONCRETE PAVEMENT, TAPER CUT	560.00	SY-IN
762000	SAW CUTTING, BITUMINOUS CONCRETE	615.00	L.F.
762001	SAW CUTTING, CONCRETE, FULL DEPTH	62.00	L.F.
811001	FLAGGER, NEW CASTLE COUNTY	112.00	HOURL
811013	FLAGGER, NEW CASTLE COUNTY, OVERTIME	12.00	HOURL
905004	INLET SEDIMENT CONTROL, DRAINAGE INLET	8.00	EACH
908001	TOPSOIL	16.00	TON
908016	PERMANENT GRASS SEEDING, SUBDIVISION	98.00	S.Y.
908020	EROSION CONTROL BLANKET MULCH	98.00	S.Y.

DELAWARE DEPARTMENT OF TRANSPORTATION

CONTRACT T202404901

(CAD) PAGE 27 OF 47

CANAL

SUBDIVISION PAVING, NORTH I, 2024

LOCATION 3 CLAYMONT MANOR - MELVIN DRIVE FROM MANOR AVENUE TO END

LENGTH 129.5400 m 425.0000 L.F.

GENERAL IMPROVEMENTS

2" MILL AND OVERLAY (CURB WHERE NECESSARY)

COMMENTS:

MATERIAL ESTIMATE FOR LOCATION 3

211001	REMOVAL OF PORTLAND CEMENT CONCRETE PAVEMENT, CURB AND SIDEWALK	122.00	S.Y.
301001	GABC	12.00	C.Y.
301002	GABC, PATCHING	27.00	C.Y.
401005	SUPERPAVE TYPE C, PG 64-22 (CARBONATE STONE)	140.00	TON
401029	SUPERPAVE TYPE C, PG 64-22, PATCHING	21.00	TON
401030	SUPERPAVE TYPE B, PG 64-22, PATCHING	25.00	TON
402000	BITUMINOUS CONCRETE PATCHING	1,220.00	SY-IN
504001	CRACK AND JOINT SEALING LESS THAN 3/4 INCH WIDE	34.00	L.F.
602100	DRAINAGE INLET GRATE(S)	3.00	EACH
602101	DRAINAGE INLET FRAME(S)	3.00	EACH
602130	ADJUSTING AND REPAIRING EXISTING DRAINAGE INLET	4.00	EACH
602131	ADJUSTING AND REPAIRING EXISTING DOUBLE DRAINAGE INLET	2.00	EACH
701019	I.PCC CURB AND GUTTER, TYPE 2	340.00	L.F.
705001	PCC SIDEWALK, 4"	136.00	S.F.
705002	PCC SIDEWALK, 6"	272.00	S.F.
710002	ADJUST WATER VALVE BOXES	3.00	EACH
760010	PAVEMENT MILLING, BITUMINOUS CONCRETE PAVEMENT	2,240.00	SY-IN
762000	SAW CUTTING, BITUMINOUS CONCRETE	510.00	L.F.
762001	SAW CUTTING, CONCRETE, FULL DEPTH	51.00	L.F.
811001	FLAGGER, NEW CASTLE COUNTY	160.00	HOUR
811013	FLAGGER, NEW CASTLE COUNTY, OVERTIME	18.00	HOUR
817002	PERMANENT PAVEMENT STRIPING, SYMBOL/LEGEND, ALKYD-THERMOPLASTIC	33.00	S.F.
905004	INLET SEDIMENT CONTROL, DRAINAGE INLET	6.00	EACH
908001	TOPSOIL	14.00	TON
908016	PERMANENT GRASS SEEDING, SUBDIVISION	82.00	S.Y.
908020	EROSION CONTROL BLANKET MULCH	82.00	S.Y.

DELAWARE DEPARTMENT OF TRANSPORTATION

CONTRACT T202404901

(CAD) PAGE 28 OF 47

CANAL

SUBDIVISION PAVING, NORTH I, 2024

LOCATION 4 EXTON - EXTON DRIVE FROM GRUBB ROAD TO END

LENGTH 196.5960 m 645.0000 L.F.

GENERAL IMPROVEMENTS

2" MILL AND OVERLAY (CURB WHERE NECESSARY)

COMMENTS:

2 RAMPS @ GRUBB

MATERIAL ESTIMATE FOR LOCATION 4

211001	REMOVAL OF PORTLAND CEMENT CONCRETE PAVEMENT, CURB AND SIDEWALK	180.00	S.Y.
301001	GABC	18.00	C.Y.
301002	GABC, PATCHING	40.00	C.Y.
401005	SUPERPAVE TYPE C, PG 64-22 (CARBONATE STONE)	245.00	TON
401029	SUPERPAVE TYPE C, PG 64-22, PATCHING	30.00	TON
401030	SUPERPAVE TYPE B, PG 64-22, PATCHING	35.00	TON
402000	BITUMINOUS CONCRETE PATCHING	1,780.00	SY-IN
504001	CRACK AND JOINT SEALING LESS THAN 3/4 INCH WIDE	146.00	L.F.
602132	ADJUSTING AND REPAIRING EXISTING MANHOLE	4.00	EACH
701013	PCC CURB, TYPE 1-8	4.00	L.F.
701019	I.PCC CURB AND GUTTER, TYPE 2	500.00	L.F.
705001	PCC SIDEWALK, 4"	200.00	S.F.
705002	PCC SIDEWALK, 6"	400.00	S.F.
705007	DETECTABLE WARNING SURFACE	20.00	S.F.
705008	PEDESTRIAN CONNECTION, TYPE 1	60.00	S.F.
705009	PEDESTRIAN CONNECTION, TYPE 2, 3, AND/OR 4	400.00	S.F.
760010	PAVEMENT MILLING, BITUMINOUS CONCRETE PAVEMENT	2,780.00	SY-IN
760011	PAVEMENT MILLING, BITUMINOUS CONCRETE PAVEMENT, TAPER CUT	560.00	SY-IN
762000	SAW CUTTING, BITUMINOUS CONCRETE	750.00	L.F.
762001	SAW CUTTING, CONCRETE, FULL DEPTH	75.00	L.F.
811001	FLAGGER, NEW CASTLE COUNTY	190.00	HOUR
811013	FLAGGER, NEW CASTLE COUNTY, OVERTIME	20.00	HOUR
905004	INLET SEDIMENT CONTROL, DRAINAGE INLET	3.00	EACH
908001	TOPSOIL	28.00	TON
908016	PERMANENT GRASS SEEDING, SUBDIVISION	168.00	S.Y.
908020	EROSION CONTROL BLANKET MULCH	168.00	S.Y.

DELAWARE DEPARTMENT OF TRANSPORTATION

CONTRACT T202404901

(CAD) PAGE 29 OF 47

CANAL

SUBDIVISION PAVING, NORTH I, 2024

LOCATION 5 GRAYLYN CREST - FLORAL DRIVE FROM GRUBB ROAD TO MATWOOD ROAD

LENGTH 737.6160 m 2420.0000 L.F.

GENERAL IMPROVEMENTS

2" MILL AND OVERLAY(CURB WHERE NECESSARY)

COMMENTS:

MATERIAL ESTIMATE FOR LOCATION 5

211001	REMOVAL OF PORTLAND CEMENT CONCRETE PAVEMENT, CURB AND SIDEWALK	541.00	S.Y.
301001	GABC	54.00	C.Y.
301002	GABC, PATCHING	121.00	C.Y.
401005	SUPERPAVE TYPE C, PG 64-22 (CARBONATE STONE)	1,080.00	TON
401029	SUPERPAVE TYPE C, PG 64-22, PATCHING	92.00	TON
401030	SUPERPAVE TYPE B, PG 64-22, PATCHING	135.00	TON
401506	SPEED HUMP	96.00	L.F.
402000	BITUMINOUS CONCRETE PATCHING	5,581.00	SY-IN
501001	PCC PAVEMENT, 8"	48.00	S.Y.
504001	CRACK AND JOINT SEALING LESS THAN 3/4 INCH WIDE	318.00	L.F.
602102	MANHOLE COVER(S)	2.00	EACH
602103	MANHOLE FRAME(S)	2.00	EACH
602130	ADJUSTING AND REPAIRING EXISTING DRAINAGE INLET	2.00	EACH
602131	ADJUSTING AND REPAIRING EXISTING DOUBLE DRAINAGE INLET	1.00	EACH
602132	ADJUSTING AND REPAIRING EXISTING MANHOLE	7.00	EACH
701013	PCC CURB, TYPE 1-8	22.00	L.F.
701019	I.PCC CURB AND GUTTER, TYPE 2	1,500.00	L.F.
705001	PCC SIDEWALK, 4"	600.00	S.F.
705002	PCC SIDEWALK, 6"	1,200.00	S.F.
705007	DETECTABLE WARNING SURFACE	110.00	S.F.
705008	PEDESTRIAN CONNECTION, TYPE 1	330.00	S.F.
705009	PEDESTRIAN CONNECTION, TYPE 2, 3, AND/OR 4	2,200.00	S.F.
760010	PAVEMENT MILLING, BITUMINOUS CONCRETE PAVEMENT	17,440.00	SY-IN
762000	SAW CUTTING, BITUMINOUS CONCRETE	2,250.00	L.F.
762001	SAW CUTTING, CONCRETE, FULL DEPTH	225.00	L.F.

DELAWARE DEPARTMENT OF TRANSPORTATION

CONTRACT T202404901

(CAD) PAGE 30 OF 47

CANAL

SUBDIVISION PAVING, NORTH I, 2024

LOCATION 5 GRAYLYN CREST - FLORAL DRIVE FROM GRUBB ROAD TO MATWOOD ROAD

LENGTH 737.6160 m 2420.0000 L.F.

GENERAL IMPROVEMENTS

2" MILL AND OVERLAY(CURB WHERE NECESSARY)

COMMENTS:

MATERIAL ESTIMATE FOR LOCATION 5

811001	FLAGGER, NEW CASTLE COUNTY	811.00	HOUR
811013	FLAGGER, NEW CASTLE COUNTY, OVERTIME	81.00	HOUR
819018	INSTALLATION OR REMOVAL OF TRAFFIC SIGN(S) ON SINGLE SIGN POST	2.00	EACH
905004	INLET SEDIMENT CONTROL, DRAINAGE INLET	8.00	EACH
908001	TOPSOIL	104.00	TON
908016	PERMANENT GRASS SEEDING, SUBDIVISION	624.00	S.Y.
908020	EROSION CONTROL BLANKET MULCH	624.00	S.Y.

DELAWARE DEPARTMENT OF TRANSPORTATION

CONTRACT T202404901

(CAD) PAGE 31 OF 47

CANAL

SUBDIVISION PAVING, NORTH I, 2024

LOCATION 6 GRAYLYN CREST - KNOWLES ROAD FROM LONGCOME DRIVE TO FLORAL DRIVE

LENGTH 469.3920 m 1540.0000 L.F.

GENERAL IMPROVEMENTS

2" MILL AND OVERLAY(CURB WHERE NECESSARY)

COMMENTS:

ESTIMATE INCLUDES INTERSECTION W/ LONGCOME - 2 RAMPS @ LONGCOME; 6 RAMPS @ BRYCE; 4 RAMPS @ DORSET; 4 RAMPS @ HARWYN; 4 RAMPS @ KYNWYD

MATERIAL ESTIMATE FOR LOCATION 6

211001	REMOVAL OF PORTLAND CEMENT CONCRETE PAVEMENT, CURB AND SIDEWALK	308.00	S.Y.
301001	GABC	31.00	C.Y.
301002	GABC, PATCHING	69.00	C.Y.
401005	SUPERPAVE TYPE C, PG 64-22 (CARBONATE STONE)	755.00	TON
401029	SUPERPAVE TYPE C, PG 64-22, PATCHING	53.00	TON
401030	SUPERPAVE TYPE B, PG 64-22, PATCHING	100.00	TON
402000	BITUMINOUS CONCRETE PATCHING	3,352.00	SY-IN
504001	CRACK AND JOINT SEALING LESS THAN 3/4 INCH WIDE	205.00	L.F.
602130	ADJUSTING AND REPAIRING EXISTING DRAINAGE INLET	1.00	EACH
602131	ADJUSTING AND REPAIRING EXISTING DOUBLE DRAINAGE INLET	1.00	EACH
602132	ADJUSTING AND REPAIRING EXISTING MANHOLE	5.00	EACH
701013	PCC CURB, TYPE 1-8	40.00	L.F.
701018	I.PCC CURB AND GUTTER, TYPE 1-8	40.00	L.F.
701019	I.PCC CURB AND GUTTER, TYPE 2	850.00	L.F.
701023	I.PCC CURB AND GUTTER, TYPE 3-8	40.00	L.F.
705001	PCC SIDEWALK, 4"	340.00	S.F.
705002	PCC SIDEWALK, 6"	680.00	S.F.
705007	DETECTABLE WARNING SURFACE	200.00	S.F.
705008	PEDESTRIAN CONNECTION, TYPE 1	600.00	S.F.
705009	PEDESTRIAN CONNECTION, TYPE 2, 3, AND/OR 4	4,000.00	S.F.
760010	PAVEMENT MILLING, BITUMINOUS CONCRETE PAVEMENT	12,020.00	SY-IN
762000	SAW CUTTING, BITUMINOUS CONCRETE	1,275.00	L.F.
762001	SAW CUTTING, CONCRETE, FULL DEPTH	128.00	L.F.
811001	FLAGGER, NEW CASTLE COUNTY	593.00	HOUR
811013	FLAGGER, NEW CASTLE COUNTY, OVERTIME	60.00	HOUR

DELAWARE DEPARTMENT OF TRANSPORTATION

CONTRACT T202404901

(CAD) PAGE 32 OF 47

CANAL

SUBDIVISION PAVING, NORTH I, 2024

LOCATION 6 **GRAYLYN CREST - KNOWLES ROAD FROM LONGCOME DRIVE TO FLORAL DRIVE**

LENGTH 469.3920 m 1540.0000 L.F.

GENERAL IMPROVEMENTS

2" MILL AND OVERLAY(CURB WHERE NECESSARY)

COMMENTS:

ESTIMATE INCLUDES INTERSECTION W/ LONGCOME - 2 RAMPS @ LONGCOME; 6 RAMPS @ BRYCE; 4 RAMPS @ DORSET; 4 RAMPS @ HARWYN; 4 RAMPS @ KYNWYD

MATERIAL ESTIMATE FOR LOCATION 6

905004	INLET SEDIMENT CONTROL, DRAINAGE INLET	3.00	EACH
908001	TOPSOIL	114.00	TON
908016	PERMANENT GRASS SEEDING, SUBDIVISION	684.00	S.Y.
908020	EROSION CONTROL BLANKET MULCH	684.00	S.Y.

DELAWARE DEPARTMENT OF TRANSPORTATION

CONTRACT T202404901

(CAD) PAGE 33 OF 47

CANAL

SUBDIVISION PAVING, NORTH I, 2024

LOCATION 7 GRAYLYN CREST - MARLETON DRIVE FROM FOULK ROAD @ CHANGE IN HOTMIX TO LONGCOME DRIVE

LENGTH 161.5440 m 530.0000 L.F.

GENERAL IMPROVEMENTS

2" MILL AND OVERLAY(CURB WHERE NECESSARY)

COMMENTS:

ESTIMATE INCLUDES INTERSECTION W/ LONGCOME - 4 RAMP @ LONGCOME; 2 RAMP @ KNOWLES

MATERIAL ESTIMATE FOR LOCATION 7

211001	REMOVAL OF PORTLAND CEMENT CONCRETE PAVEMENT, CURB AND SIDEWALK	120.00	S.Y.
301001	GABC	13.00	C.Y.
301002	GABC, PATCHING	27.00	C.Y.
401005	SUPERPAVE TYPE C, PG 64-22 (CARBONATE STONE)	265.00	TON
401029	SUPERPAVE TYPE C, PG 64-22, PATCHING	22.00	TON
401030	SUPERPAVE TYPE B, PG 64-22, PATCHING	30.00	TON
402000	BITUMINOUS CONCRETE PATCHING	1,231.00	SY-IN
504001	CRACK AND JOINT SEALING LESS THAN 3/4 INCH WIDE	113.00	L.F.
602130	ADJUSTING AND REPAIRING EXISTING DRAINAGE INLET	2.00	EACH
602132	ADJUSTING AND REPAIRING EXISTING MANHOLE	4.00	EACH
701013	PCC CURB, TYPE 1-8	12.00	L.F.
701019	I.PCC CURB AND GUTTER, TYPE 2	330.00	L.F.
705001	PCC SIDEWALK, 4"	132.00	S.F.
705002	PCC SIDEWALK, 6"	264.00	S.F.
705007	DETECTABLE WARNING SURFACE	60.00	S.F.
705008	PEDESTRIAN CONNECTION, TYPE 1	180.00	S.F.
705009	PEDESTRIAN CONNECTION, TYPE 2, 3, AND/OR 4	1,200.00	S.F.
760010	PAVEMENT MILLING, BITUMINOUS CONCRETE PAVEMENT	4,200.00	SY-IN
762000	SAW CUTTING, BITUMINOUS CONCRETE	495.00	L.F.
762001	SAW CUTTING, CONCRETE, FULL DEPTH	50.00	L.F.
811001	FLAGGER, NEW CASTLE COUNTY	221.00	HOUR
811013	FLAGGER, NEW CASTLE COUNTY, OVERTIME	23.00	HOUR
905004	INLET SEDIMENT CONTROL, DRAINAGE INLET	2.00	EACH
908001	TOPSOIL	37.00	TON
908016	PERMANENT GRASS SEEDING, SUBDIVISION	223.00	S.Y.
908020	EROSION CONTROL BLANKET MULCH	223.00	S.Y.

DELAWARE DEPARTMENT OF TRANSPORTATION

CONTRACT T202404901

(CAD) PAGE 34 OF 47

CANAL

SUBDIVISION PAVING, NORTH I, 2024

LOCATION 8 GRUBBS LANDING - RIVERS END DRIVE EAST FROM GRUBBS LANDING ROAD TO END

LENGTH 102.1080 m 335.0000 L.F.

GENERAL IMPROVEMENTS

2" MILL AND OVERLAY (CURB WHERE NECESSARY)

COMMENTS:

MATERIAL ESTIMATE FOR LOCATION 8

211001	REMOVAL OF PORTLAND CEMENT CONCRETE PAVEMENT, CURB AND SIDEWALK	101.00	S.Y.
301001	GABC	10.00	C.Y.
301002	GABC, PATCHING	22.00	C.Y.
401005	SUPERPAVE TYPE C, PG 64-22 (CARBONATE STONE)	145.00	TON
401029	SUPERPAVE TYPE C, PG 64-22, PATCHING	17.00	TON
401030	SUPERPAVE TYPE B, PG 64-22, PATCHING	20.00	TON
402000	BITUMINOUS CONCRETE PATCHING	1,000.00	SY-IN
504001	CRACK AND JOINT SEALING LESS THAN 3/4 INCH WIDE	76.00	L.F.
602130	ADJUSTING AND REPAIRING EXISTING DRAINAGE INLET	1.00	EACH
602132	ADJUSTING AND REPAIRING EXISTING MANHOLE	2.00	EACH
701019	I.PCC CURB AND GUTTER, TYPE 2	280.00	L.F.
705001	PCC SIDEWALK, 4"	112.00	S.F.
705002	PCC SIDEWALK, 6"	224.00	S.F.
760010	PAVEMENT MILLING, BITUMINOUS CONCRETE PAVEMENT	1,280.00	SY-IN
760011	PAVEMENT MILLING, BITUMINOUS CONCRETE PAVEMENT, TAPER CUT	495.00	SY-IN
762000	SAW CUTTING, BITUMINOUS CONCRETE	420.00	L.F.
762001	SAW CUTTING, CONCRETE, FULL DEPTH	42.00	L.F.
811001	FLAGGER, NEW CASTLE COUNTY	105.00	HOUR
811013	FLAGGER, NEW CASTLE COUNTY, OVERTIME	9.00	HOUR
905004	INLET SEDIMENT CONTROL, DRAINAGE INLET	2.00	EACH
908001	TOPSOIL	11.00	TON
908016	PERMANENT GRASS SEEDING, SUBDIVISION	67.00	S.Y.
908020	EROSION CONTROL BLANKET MULCH	67.00	S.Y.

DELAWARE DEPARTMENT OF TRANSPORTATION

CONTRACT T202404901

(CAD) PAGE 35 OF 47

CANAL

SUBDIVISION PAVING, NORTH I, 2024

LOCATION 9 HAYMAN PLACE - HAYMAN PLACE FROM MARSH ROAD TO END

LENGTH 144.7800 m 475.0000 L.F.

GENERAL IMPROVEMENTS

2" MILL AND OVERLAY (CURB WHERE NECESSARY)

COMMENTS:

INSTALL STOP BAR @ MARSH

MATERIAL ESTIMATE FOR LOCATION 9

211001	REMOVAL OF PORTLAND CEMENT CONCRETE PAVEMENT, CURB AND SIDEWALK	86.00	S.Y.
301001	GABC	8.00	C.Y.
301002	GABC, PATCHING	19.00	C.Y.
401005	SUPERPAVE TYPE C, PG 64-22 (CARBONATE STONE)	190.00	TON
401029	SUPERPAVE TYPE C, PG 64-22, PATCHING	15.00	TON
401030	SUPERPAVE TYPE B, PG 64-22, PATCHING	15.00	TON
402000	BITUMINOUS CONCRETE PATCHING	840.00	SY-IN
504001	CRACK AND JOINT SEALING LESS THAN 3/4 INCH WIDE	96.00	L.F.
602130	ADJUSTING AND REPAIRING EXISTING DRAINAGE INLET	1.00	EACH
602132	ADJUSTING AND REPAIRING EXISTING MANHOLE	3.00	EACH
701019	I.PCC CURB AND GUTTER, TYPE 2	240.00	L.F.
705001	PCC SIDEWALK, 4"	96.00	S.F.
705002	PCC SIDEWALK, 6"	192.00	S.F.
760010	PAVEMENT MILLING, BITUMINOUS CONCRETE PAVEMENT	1,960.00	SY-IN
760011	PAVEMENT MILLING, BITUMINOUS CONCRETE PAVEMENT, TAPER CUT	495.00	SY-IN
762000	SAW CUTTING, BITUMINOUS CONCRETE	360.00	L.F.
762001	SAW CUTTING, CONCRETE, FULL DEPTH	36.00	L.F.
802003	ARROW PANELS TYPE C	8.00	EA-DY
808002	PROVIDE AND MAINTAIN TRUCK MOUNTED ATTENUATOR, TYPE II	8.00	EA-DY
811001	FLAGGER, NEW CASTLE COUNTY	115.00	HOUR
811013	FLAGGER, NEW CASTLE COUNTY, OVERTIME	13.00	HOUR
817002	PERMANENT PAVEMENT STRIPING, SYMBOL/LEGEND, ALKYD-THERMOPLASTIC	33.00	S.F.
905004	INLET SEDIMENT CONTROL, DRAINAGE INLET	1.00	EACH
908001	TOPSOIL	10.00	TON
908016	PERMANENT GRASS SEEDING, SUBDIVISION	58.00	S.Y.
908020	EROSION CONTROL BLANKET MULCH	58.00	S.Y.

DELAWARE DEPARTMENT OF TRANSPORTATION

CONTRACT T202404901

(CAD) PAGE 36 OF 47

CANAL

SUBDIVISION PAVING, NORTH I, 2024

LOCATION 10 HOLLY OAK TERRACE - CLEARVIEW AVENUE FROM PHILADELPHIA PIKE TO END

LENGTH 137.1600 m 450.0000 L.F.

GENERAL IMPROVEMENTS

2" MILL AND OVERLAY (CURB WHERE NECESSARY)

COMMENTS:

MATERIAL ESTIMATE FOR LOCATION 10

211001	REMOVAL OF PORTLAND CEMENT CONCRETE PAVEMENT, CURB AND SIDEWALK	1.00	S.Y.
301001	GABC	1.00	C.Y.
301002	GABC, PATCHING	1.00	C.Y.
401005	SUPERPAVE TYPE C, PG 64-22 (CARBONATE STONE)	95.00	TON
401029	SUPERPAVE TYPE C, PG 64-22, PATCHING	2.00	TON
401030	SUPERPAVE TYPE B, PG 64-22, PATCHING	25.00	TON
402000	BITUMINOUS CONCRETE PATCHING	201.00	SY-IN
504001	CRACK AND JOINT SEALING LESS THAN 3/4 INCH WIDE	72.00	L.F.
602130	ADJUSTING AND REPAIRING EXISTING DRAINAGE INLET	1.00	EACH
602132	ADJUSTING AND REPAIRING EXISTING MANHOLE	3.00	EACH
701013	PCC CURB, TYPE 1-8	4.00	L.F.
705007	DETECTABLE WARNING SURFACE	20.00	S.F.
705008	PEDESTRIAN CONNECTION, TYPE 1	60.00	S.F.
705009	PEDESTRIAN CONNECTION, TYPE 2, 3, AND/OR 4	400.00	S.F.
760010	PAVEMENT MILLING, BITUMINOUS CONCRETE PAVEMENT	1,500.00	SY-IN
762000	SAW CUTTING, BITUMINOUS CONCRETE	120.00	L.F.
762001	SAW CUTTING, CONCRETE, FULL DEPTH	20.00	L.F.
811001	FLAGGER, NEW CASTLE COUNTY	77.00	HOUR
811013	FLAGGER, NEW CASTLE COUNTY, OVERTIME	12.00	HOUR
817002	PERMANENT PAVEMENT STRIPING, SYMBOL/LEGEND, ALKYD-THERMOPLASTIC	160.00	S.F.
817004	TEMPORARY MARKINGS, PAINT, SYMBOL/LEGEND	160.00	S.F.
905004	INLET SEDIMENT CONTROL, DRAINAGE INLET	1.00	EACH
908001	TOPSOIL	8.00	TON
908016	PERMANENT GRASS SEEDING, SUBDIVISION	48.00	S.Y.
908020	EROSION CONTROL BLANKET MULCH	48.00	S.Y.

DELAWARE DEPARTMENT OF TRANSPORTATION

CONTRACT T202404901

(CAD) PAGE 39 OF 47

CANAL

SUBDIVISION PAVING, NORTH I, 2024

LOCATION 12 SHERWOOD GREEN - DURBORAW ROAD FROM MARSH ROAD TO END

LENGTH 198.1200 m 650.0000 L.F.

GENERAL IMPROVEMENTS

2" MILL AND OVERLAY (CURB WHERE NECESSARY)

COMMENTS:

MATERIAL ESTIMATE FOR LOCATION 12

211001	REMOVAL OF PORTLAND CEMENT CONCRETE PAVEMENT, CURB AND SIDEWALK	173.00	S.Y.
301001	GABC	17.00	C.Y.
301002	GABC, PATCHING	38.00	C.Y.
401005	SUPERPAVE TYPE C, PG 64-22 (CARBONATE STONE)	245.00	TON
401029	SUPERPAVE TYPE C, PG 64-22, PATCHING	30.00	TON
401030	SUPERPAVE TYPE B, PG 64-22, PATCHING	25.00	TON
402000	BITUMINOUS CONCRETE PATCHING	1,640.00	SY-IN
504001	CRACK AND JOINT SEALING LESS THAN 3/4 INCH WIDE	96.00	L.F.
602130	ADJUSTING AND REPAIRING EXISTING DRAINAGE INLET	2.00	EACH
602132	ADJUSTING AND REPAIRING EXISTING MANHOLE	2.00	EACH
701019	I.PCC CURB AND GUTTER, TYPE 2	480.00	L.F.
705001	PCC SIDEWALK, 4"	192.00	S.F.
705002	PCC SIDEWALK, 6"	384.00	S.F.
710370	STEEL CASING PIPE, 4"	10.00	L.F.
760010	PAVEMENT MILLING, BITUMINOUS CONCRETE PAVEMENT	2,800.00	SY-IN
760011	PAVEMENT MILLING, BITUMINOUS CONCRETE PAVEMENT, TAPER CUT	560.00	SY-IN
762000	SAW CUTTING, BITUMINOUS CONCRETE	720.00	L.F.
762001	SAW CUTTING, CONCRETE, FULL DEPTH	72.00	L.F.
802003	ARROW PANELS TYPE C	8.00	EA-DY
808002	PROVIDE AND MAINTAIN TRUCK MOUNTED ATTENUATOR, TYPE II	8.00	EA-DY
811001	FLAGGER, NEW CASTLE COUNTY	180.00	HOUR
811013	FLAGGER, NEW CASTLE COUNTY, OVERTIME	22.00	HOUR
817002	PERMANENT PAVEMENT STRIPING, SYMBOL/LEGEND, ALKYD-THERMOPLASTIC	33.00	S.F.
817004	TEMPORARY MARKINGS, PAINT, SYMBOL/LEGEND	33.00	S.F.
905004	INLET SEDIMENT CONTROL, DRAINAGE INLET	5.00	EACH
908001	TOPSOIL	19.00	TON

DELAWARE DEPARTMENT OF TRANSPORTATION

CONTRACT T202404901

(CAD) PAGE 40 OF 47

CANAL

SUBDIVISION PAVING, NORTH I, 2024

LOCATION 12 SHERWOOD GREEN - DURBORAW ROAD FROM MARSH ROAD TO END

LENGTH 198.1200 m 650.0000 L.F.

GENERAL IMPROVEMENTS

2" MILL AND OVERLAY (CURB WHERE NECESSARY)

COMMENTS:

MATERIAL ESTIMATE FOR LOCATION 12

908016	PERMANENT GRASS SEEDING, SUBDIVISION	115.00	S.Y.
908020	EROSION CONTROL BLANKET MULCH	115.00	S.Y.

DELAWARE DEPARTMENT OF TRANSPORTATION

CONTRACT T202404901

(CAD) PAGE 41 OF 47

CANAL

SUBDIVISION PAVING, NORTH I, 2024

LOCATION 13 SURREY PARK - PALOMINO COURT FROM COACHMAN ROAD TO END

LENGTH 120.3960 m 395.0000 L.F.

GENERAL IMPROVEMENTS

2" MILL AND OVERLAY (CURB WHERE NECESSARY)

COMMENTS:

MATERIAL ESTIMATE FOR LOCATION 13

211001	REMOVAL OF PORTLAND CEMENT CONCRETE PAVEMENT, CURB AND SIDEWALK	151.00	S.Y.
301001	GABC	15.00	C.Y.
301002	GABC, PATCHING	34.00	C.Y.
401005	SUPERPAVE TYPE C, PG 64-22 (CARBONATE STONE)	170.00	TON
401029	SUPERPAVE TYPE C, PG 64-22, PATCHING	26.00	TON
401030	SUPERPAVE TYPE B, PG 64-22, PATCHING	15.00	TON
402000	BITUMINOUS CONCRETE PATCHING	1,380.00	SY-IN
504001	CRACK AND JOINT SEALING LESS THAN 3/4 INCH WIDE	66.00	L.F.
602132	ADJUSTING AND REPAIRING EXISTING MANHOLE	1.00	EACH
701019	I.PCC CURB AND GUTTER, TYPE 2	420.00	L.F.
705001	PCC SIDEWALK, 4"	168.00	S.F.
705002	PCC SIDEWALK, 6"	336.00	S.F.
760010	PAVEMENT MILLING, BITUMINOUS CONCRETE PAVEMENT	1,540.00	SY-IN
760011	PAVEMENT MILLING, BITUMINOUS CONCRETE PAVEMENT, TAPER CUT	560.00	SY-IN
762000	SAW CUTTING, BITUMINOUS CONCRETE	630.00	L.F.
762001	SAW CUTTING, CONCRETE, FULL DEPTH	63.00	L.F.
811001	FLAGGER, NEW CASTLE COUNTY	122.00	HOURL
811013	FLAGGER, NEW CASTLE COUNTY, OVERTIME	15.00	HOURL
908001	TOPSOIL	17.00	TON
908016	PERMANENT GRASS SEEDING, SUBDIVISION	101.00	S.Y.
908020	EROSION CONTROL BLANKET MULCH	101.00	S.Y.

DELAWARE DEPARTMENT OF TRANSPORTATION

CONTRACT T202404901

(CAD) PAGE 42 OF 47

CANAL

SUBDIVISION PAVING, NORTH I, 2024

LOCATION 14 VINEYARDS - VINEYARDS COURT FROM MARSH ROAD TO END

LENGTH 146.3040 m 480.0000 L.F.

GENERAL IMPROVEMENTS

2" MILL AND OVERLAY(CURB WHERE NECESSARY)

COMMENTS:

MATERIAL ESTIMATE FOR LOCATION 14

211001	REMOVAL OF PORTLAND CEMENT CONCRETE PAVEMENT, CURB AND SIDEWALK	162.00	S.Y.
301001	GABC	16.00	C.Y.
301002	GABC, PATCHING	36.00	C.Y.
401005	SUPERPAVE TYPE C, PG 64-22 (CARBONATE STONE)	150.00	TON
401029	SUPERPAVE TYPE C, PG 64-22, PATCHING	28.00	TON
401030	SUPERPAVE TYPE B, PG 64-22, PATCHING	20.00	TON
402000	BITUMINOUS CONCRETE PATCHING	1,510.00	SY-IN
504001	CRACK AND JOINT SEALING LESS THAN 3/4 INCH WIDE	93.00	L.F.
602130	ADJUSTING AND REPAIRING EXISTING DRAINAGE INLET	1.00	EACH
602131	ADJUSTING AND REPAIRING EXISTING DOUBLE DRAINAGE INLET	2.00	EACH
602132	ADJUSTING AND REPAIRING EXISTING MANHOLE	2.00	EACH
701019	I.PCC CURB AND GUTTER, TYPE 2	450.00	L.F.
705001	PCC SIDEWALK, 4"	180.00	S.F.
705002	PCC SIDEWALK, 6"	360.00	S.F.
710002	ADJUST WATER VALVE BOXES	2.00	EACH
760010	PAVEMENT MILLING, BITUMINOUS CONCRETE PAVEMENT	2,400.00	SY-IN
762000	SAW CUTTING, BITUMINOUS CONCRETE	675.00	L.F.
762001	SAW CUTTING, CONCRETE, FULL DEPTH	68.00	L.F.
802003	ARROW PANELS TYPE C	6.00	EA-DY
808002	PROVIDE AND MAINTAIN TRUCK MOUNTED ATTENUATOR, TYPE II	6.00	EA-DY
811001	FLAGGER, NEW CASTLE COUNTY	160.00	HOUR
811013	FLAGGER, NEW CASTLE COUNTY, OVERTIME	18.00	HOUR
817002	PERMANENT PAVEMENT STRIPING, SYMBOL/LEGEND, ALKYD-THERMOPLASTIC	33.00	S.F.
817004	TEMPORARY MARKINGS, PAINT, SYMBOL/LEGEND	33.00	S.F.
905004	INLET SEDIMENT CONTROL, DRAINAGE INLET	5.00	EACH
908001	TOPSOIL	18.00	TON

DELAWARE DEPARTMENT OF TRANSPORTATION

CONTRACT T202404901

(CAD) PAGE 43 OF 47

CANAL

SUBDIVISION PAVING, NORTH I, 2024

LOCATION 14 VINEYARDS - VINEYARDS COURT FROM MARSH ROAD TO END

LENGTH 146.3040 m 480.0000 L.F.

GENERAL IMPROVEMENTS

2" MILL AND OVERLAY(CURB WHERE NECESSARY)

COMMENTS:

MATERIAL ESTIMATE FOR LOCATION 14

908016	PERMANENT GRASS SEEDING, SUBDIVISION	108.00	S.Y.
908020	EROSION CONTROL BLANKET MULCH	108.00	S.Y.

DELAWARE DEPARTMENT OF TRANSPORTATION

CONTRACT T202404901

(CAD) PAGE 44 OF 47

CANAL

SUBDIVISION PAVING, NORTH I, 2024

LOCATION 15 WHITES VILLAGE - BEECH AVENUE FROM OAK AVENUE TO END

LENGTH 68.5800 m 225.0000 L.F.

GENERAL IMPROVEMENTS

2" MILL AND OVERLAY

COMMENTS:

MATERIAL ESTIMATE FOR LOCATION 15

401005	SUPERPAVE TYPE C, PG 64-22 (CARBONATE STONE)	60.00	TON
401029	SUPERPAVE TYPE C, PG 64-22, PATCHING	1.00	TON
401030	SUPERPAVE TYPE B, PG 64-22, PATCHING	15.00	TON
402000	BITUMINOUS CONCRETE PATCHING	120.00	SY-IN
760010	PAVEMENT MILLING, BITUMINOUS CONCRETE PAVEMENT	910.00	SY-IN
762000	SAW CUTTING, BITUMINOUS CONCRETE	20.00	L.F.
811001	FLAGGER, NEW CASTLE COUNTY	24.00	HOUR
811013	FLAGGER, NEW CASTLE COUNTY, OVERTIME	4.00	HOUR

DELAWARE DEPARTMENT OF TRANSPORTATION

CONTRACT T202404901

(CAD) PAGE 45 OF 47

CANAL

SUBDIVISION PAVING, NORTH I, 2024

LOCATION 16 WYNNWOOD - PATWYNN ROAD FROM WYNNWOOD ROAD TO JAMAICA DRIVE

LENGTH 411.4800 m 1350.0000 L.F.

GENERAL IMPROVEMENTS

2" MILL AND OVERLAY(CURB WHERE NECESSARY)

COMMENTS:

ESTIMATE INCLUDES INTERSECTION W/ WYNWOOD

MATERIAL ESTIMATE FOR LOCATION 16

211001	REMOVAL OF PORTLAND CEMENT CONCRETE PAVEMENT, CURB AND SIDEWALK	252.00	S.Y.
301001	GABC	25.00	C.Y.
301002	GABC, PATCHING	56.00	C.Y.
401005	SUPERPAVE TYPE C, PG 64-22 (CARBONATE STONE)	450.00	TON
401029	SUPERPAVE TYPE C, PG 64-22, PATCHING	43.00	TON
401030	SUPERPAVE TYPE B, PG 64-22, PATCHING	50.00	TON
402000	BITUMINOUS CONCRETE PATCHING	2,500.00	SY-IN
504001	CRACK AND JOINT SEALING LESS THAN 3/4 INCH WIDE	166.00	L.F.
602130	ADJUSTING AND REPAIRING EXISTING DRAINAGE INLET	4.00	EACH
602131	ADJUSTING AND REPAIRING EXISTING DOUBLE DRAINAGE INLET	1.00	EACH
602132	ADJUSTING AND REPAIRING EXISTING MANHOLE	4.00	EACH
701019	I.PCC CURB AND GUTTER, TYPE 2	700.00	L.F.
705001	PCC SIDEWALK, 4"	280.00	S.F.
705002	PCC SIDEWALK, 6"	560.00	S.F.
760010	PAVEMENT MILLING, BITUMINOUS CONCRETE PAVEMENT	6,600.00	SY-IN
762000	SAW CUTTING, BITUMINOUS CONCRETE	1,050.00	L.F.
762001	SAW CUTTING, CONCRETE, FULL DEPTH	105.00	L.F.
811001	FLAGGER, NEW CASTLE COUNTY	315.00	hour
811013	FLAGGER, NEW CASTLE COUNTY, OVERTIME	32.00	hour
905004	INLET SEDIMENT CONTROL, DRAINAGE INLET	6.00	EACH
908001	TOPSOIL	28.00	TON
908016	PERMANENT GRASS SEEDING, SUBDIVISION	168.00	S.Y.
908020	EROSION CONTROL BLANKET MULCH	168.00	S.Y.

DELAWARE DEPARTMENT OF TRANSPORTATION

CONTRACT T202404901

(CAD) PAGE 46 OF 47

CANAL

SUBDIVISION PAVING, NORTH I, 2024

CONTRACT QUANTITIES SUMMARY SHEET

211001	REMOVAL OF PORTLAND CEMENT CONCRETE PAVEMENT, CURB AND SIDEWALK	2,814.00	S.Y.
301001	GABC	280.00	C.Y.
301002	GABC, PATCHING	628.00	C.Y.
401005	SUPERPAVE TYPE C, PG 64-22 (CARBONATE STONE)	4,600.00	TON
401029	SUPERPAVE TYPE C, PG 64-22, PATCHING	485.00	TON
401030	SUPERPAVE TYPE B, PG 64-22, PATCHING	585.00	TON
401506	SPEED HUMP	96.00	L.F.
402000	BITUMINOUS CONCRETE PATCHING	28,086.00	SY-IN
501001	PCC PAVEMENT, 8"	48.00	S.Y.
504001	CRACK AND JOINT SEALING LESS THAN 3/4 INCH WIDE	1,796.00	L.F.
602100	DRAINAGE INLET GRATE(S)	8.00	EACH
602101	DRAINAGE INLET FRAME(S)	8.00	EACH
602102	MANHOLE COVER(S)	2.00	EACH
602103	MANHOLE FRAME(S)	2.00	EACH
602130	ADJUSTING AND REPAIRING EXISTING DRAINAGE INLET	24.00	EACH
602131	ADJUSTING AND REPAIRING EXISTING DOUBLE DRAINAGE INLET	8.00	EACH
602132	ADJUSTING AND REPAIRING EXISTING MANHOLE	43.00	EACH
701013	PCC CURB, TYPE 1-8	94.00	L.F.
701018	I.PCC CURB AND GUTTER, TYPE 1-8	40.00	L.F.
701019	I.PCC CURB AND GUTTER, TYPE 2	7,800.00	L.F.
701023	I.PCC CURB AND GUTTER, TYPE 3-8	40.00	L.F.
705001	PCC SIDEWALK, 4"	3,120.00	S.F.
705002	PCC SIDEWALK, 6"	6,240.00	S.F.
705007	DETECTABLE WARNING SURFACE	470.00	S.F.
705008	PEDESTRIAN CONNECTION, TYPE 1	1,410.00	S.F.
705009	PEDESTRIAN CONNECTION, TYPE 2, 3, AND/OR 4	9,400.00	S.F.
710002	ADJUST WATER VALVE BOXES	5.00	EACH
710370	STEEL CASING PIPE, 4"	10.00	L.F.

DELAWARE DEPARTMENT OF TRANSPORTATION

CONTRACT T202404901

(CAD) PAGE 47 OF 47

CANAL

SUBDIVISION PAVING, NORTH I, 2024

CONTRACT QUANTITIES SUMMARY SHEET

760010	PAVEMENT MILLING, BITUMINOUS CONCRETE PAVEMENT	63,990.00	SY-IN
760011	PAVEMENT MILLING, BITUMINOUS CONCRETE PAVEMENT, TAPER CUT	4,350.00	SY-IN
762000	SAW CUTTING, BITUMINOUS CONCRETE	11,840.00	L.F.
762001	SAW CUTTING, CONCRETE, FULL DEPTH	1,192.00	L.F.
763000	INITIAL EXPENSE/DE-MOBILIZATION	LUMP	SUM
801500	MAINTENANCE OF TRAFFIC, ALL INCLUSIVE	LUMP	SUM
802003	ARROW PANELS TYPE C	22.00	EA-DY
808002	PROVIDE AND MAINTAIN TRUCK MOUNTED ATTENUATOR, TYPE II	22.00	EA-DY
811001	FLAGGER, NEW CASTLE COUNTY	3,661.00	HOURL
811013	FLAGGER, NEW CASTLE COUNTY, OVERTIME	389.00	HOURL
817002	PERMANENT PAVEMENT STRIPING, SYMBOL/LEGEND, ALKYD-THERMOPLASTIC	292.00	S.F.
817004	TEMPORARY MARKINGS, PAINT, SYMBOL/LEGEND	226.00	S.F.
819018	INSTALLATION OR REMOVAL OF TRAFFIC SIGN(S) ON SINGLE SIGN POST	2.00	EACH
905004	INLET SEDIMENT CONTROL, DRAINAGE INLET	55.00	EACH
908001	TOPSOIL	500.00	TON
908016	PERMANENT GRASS SEEDING, SUBDIVISION	3,000.00	S.Y.
908020	EROSION CONTROL BLANKET MULCH	3,000.00	S.Y.